

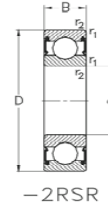

### Deep Groove Ball Bearing

- P0 grade
- C0 clearance
- GCr15 material

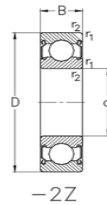
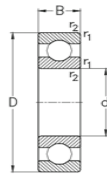

SAP Code	Dimensions				Type	Loading ratings (kN)		Thermal speed ratings [rpm]	Limited speed ratings [rpm]	Weight kg
	d	D	B	r1,r2 min		dyn. Cr	stat. C0r	nG	n θ	
ANR167	2	5	2.3	0.08	682-ZZ	1.9	0.5	100000		
ANR159	6	17	6	0.3	606-ZZ	2	0.8	38000		
*	3	10	4	0.15	623	0.6	0.3	56400	80000	0.001
*	3	10	4	0.15	623-Z	0.6	0.2	50000	52000	0.001
ANQ789	3	10	4	0.15	623-ZZ	0.6	0.2	50000	52000	0.001
ANQ783	3	10	4	0.15	623-2RS	0.6	0.2	30000		
ANR168	3	7	3	0.1	683-ZZ	0.3	0.1	63000		
ANR166	3	13	5	0.15	633-ZZ	1.3	0.5	45000		
*	4	11	4	0.15	619/4	0.9	0.3	52800	80000	0.001
*	4	12	4	0.2	604	0.8	0.3	49000	75000	0.002
ANR156	4	12	4	0.5	604-ZZ	0.95	0.34	47000		
*	4	13	5	0.2	624	1.2	0.5	46600	67000	0.003
*	4	13	5	0.2	624-Z	1.2	0.5	--	38000	0.003
ANQ790	4	13	5	0.2	624-ZZ	1.2	0.4	42000	38000	0.003
ANQ755	4	13	5	0.2	624-2RS	1.2	0.5	25000		
*	4	16	5	0.3	634	1.4	0.6	35300	67000	0.006
*	4	16	5	0.3	634-Z	1.4	0.6	35000	36000	0.006
ANQ781	4	16	5	0.3	634-ZZ	1.3	0.5	35000	36000	0.006
*	5	13	4	0.2	619/5	1.1	0.4	42300	67000	0.002
ANR158	5	14	5	0.2	605-ZZ	1.3	0.4	40000		
ANR157	5	14	5	0.2	605-2RS	1.3	0.4	24000		
*	5	16	5	0.3	625	1.4	0.6	36200	60000	0.005
*	5	16	5	0.3	625-Z	1.4	0.6	36000		0.005
ANQ791	5	16	5	0.3	625-ZZ	1.6	0.6	36000		0.005
ANQ808	5	16	5	0.3	625-2RS	1.7	0.6	22000		0.005
*	5	19	6	0.3	635	2.2	0.9	31500	50000	0.009
*	5	19	6	0.3	635-Z	2.2	0.9	31000	32000	0.009
ANQ782	5	19	6	0.3	635-ZZ	2.2	0.9	31000	32000	0.009
ANQ810	5	11	5	0.3	635-2RS	2.2	0.9	19000		
ANR170	5	11	5	0.15	685-ZZ	0.7	0.3	45000		
*	6	15	5	0.15	619/6	1.3	0.5	40100	63000	0.004
*	6	19	6	0.15	626	2.2	0.8	32500	50000	0.009
ANQ809	6	19	6	0.15	626-2RS	2.2	0.8	19000	21500	0.009
*	6	19	6	0.15	626-RS	2.2	0.8	19000	21500	0.009
*	6	19	6	0.15	626-Z	2.2	0.8	32000		0.009
ANQ792	6	19	6	0.15	626-ZZ	2.2	0.8	32000		0.009
ANR171	6	13	5	0.15	686-2RS	1.02	0.41	25000		
*	7	17	5	0.3	619/7	1.6	0.7	34200	56000	0.005
*	7	19	6	0.3	607	2.1	0.9	34600	53000	0.008

### Deep Groove Ball Bearing

- P0 grade
- C0 clearance
- GCr15 material

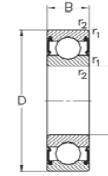
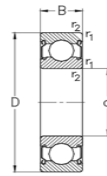
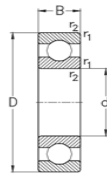

-2Z

-2RSR

SAP Code	Dimensions				Type	Loading ratings (kN)		Thermal speed ratings [rpm]	Limited speed ratings [rpm]	Weight kg
	d	D	B	r1,r2 min		dyn. Cr	stat. C0r	nG	n θ	
*	7	19	6	0.3	607-RS	2.1	0.9	--	20000	0.008
ANQ784	7	19	6	0.3	607-2RS	2.1	0.9	--	20000	0.008
*	7	19	6	0.3	607-Z	2.1	0.9	--	30000	0.008
ANQ729	7	19	6	0.3	607-ZZ	2.1	0.9	--	30000	0.008
*	7	22	7	0.3	627	3.3	1.3	29900	45000	0.013
*	7	22	7	0.3	627-RS	3.3	1.3	--	20000	0.013
ANQ793	7	22	7	0.3	627-2RS	3.3	1.3	--	20000	0.013
*	7	22	7	0.3	627-Z	3.3	1.3	--	30000	0.013
ANQ794	7	22	7	0.3	627-ZZ	3.3	1.3	--	30000	0.013
ANQ870	7	24	8	0.3	628-ZZ	3.3	1.2	28000		
ANQ869	7	24	8	0.3	628-2RS	3.3	1.2	23000		
*	8	19	6	0.3	619/8	2.2	0.9	33100	50000	0.007
*	8	22	7	0.3	608	3.3	1.4	31800	48000	0.013
*	8	22	7	0.3	608-RS	3.3	1.4		20000	0.013
ANQ785	8	22	7	0.3	608-2RS	3.3	1.4		20000	0.013
ANR160	8	22	7	0.3	608-2RS-C3	3.2	1.4		20000	
*	8	22	7	0.3	608-Z	3.3	1.4	34000	30000	0.013
ANQ786	8	22	7	0.3	608-ZZ	3.3	1.4	34000	30000	0.013
ANR161	8	22	7	0.3	608-ZZABEC1	3.3	1.4	34000		
ANR162	8	22	7	0.3	608-ZZABEC3	3.3	1.4	34000		
ANR163	8	22	7	0.3	608-ZZABEC5	3.3	1.4	34000		
ANQ881	8	28	9	0.3	638-ZZ	1.7	0.7	28000		
*	9	20	6	0.3	619/9	1.8	0.9	30300	48000	0.008
*	9	24	7	0.3	609	3.7	1.7	28300	43000	0.015
*	9	24	7	0.3	609-RS	3.7	1.7	23000		0.015
ANQ787	9	24	7	0.3	609-2RS	3.7	1.7	23000		0.015
*	9	24	7	0.3	609-Z	3.7	1.7	32000	30000	0.015
ANQ788	9	24	7	0.3	609-ZZ	3.7	1.7	32000	30000	0.015
*	9	26	8	0.6	629	4.6	1.9	25700	38000	0.02
*	9	26	8	0.6	629-RS	4.6	1.9		18500	0.02
ANQ795	9	26	8	0.3	629-2RS	4.6	1.9	19000	18500	0.02
*	9	26	8	0.3	629-Z	4.6	1.9	34000	28000	0.02
ANQ796	9	26	8	0.3	629-ZZ	4.6	1.9	34000	28000	0.02
*	10	19	5	0.3	61800	1.7	0.8	27500	48000	0.005
ANQ827	10	19	5	0.3	61800-2RS	1.7	0.8	--	22000	0.005
ANQ828	10	19	5	0.3	61800-ZZ	1.7	0.8	--	34000	0.005
*	10	22	6	0.3	61900	2.7	1.3	26900	45000	0.01
ANQ835	10	22	6	0.3	61900-2RS	2.7	1.3	--	22000	0.01
ANQ836	10	22	6	0.3	61900-ZZ	2.7	1.3	--	34000	0.01

### Deep Groove Ball Bearing

- P0 grade
- C0 clearance
- GCr15 material

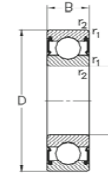
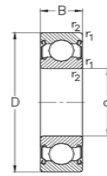
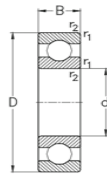

-2Z

-2RSR



SAP Code	Dimensions				Type	Loading ratings (kN)		Thermal speed ratings [rpm]	Limited speed ratings [rpm]	Weight kg
	d	D	B	r1,r2 min		dyn. Cr	stat. C0r	nG	n θ	
*	10	26	8	0.3	6000	4.6	2	27600	40000	0.019
ANQ707	10	26	8	0.3	6000-2RS	4.6	2	--	17000	0.019
*	10	26	8	0.3	6000-Z	4.6	2	--	28000	0.019
ANQ708	10	26	8	0.3	6000-ZZ	4.6	2	--	28000	0.019
*	10	30	9	0.6	6200	5.1	2.4	23500	40000	0.03
ANQ730	10	30	9	0.6	6200-2RS	5.1	2.4	--	17000	0.03
*	10	30	9	0.6	6200-Z	5.1	2.4	--	26000	0.03
ANQ731	10	30	9	0.6	6200-ZZ	5.1	2.4	--	26000	0.03
*	10	35	11	0.6	6300	8.2	3.5	21100	32000	0.055
*	10	35	11	0.6	6300-2RS	8.2	3.5	--	14500	0.055
*	10	35	11	0.6	6300-Z	8.2	3.5	--	22000	0.055
ANQ756	10	35	11	0.6	6300-ZZ	8.2	3.5	--	22000	0.055
ANQ797	10	35	11	0.6	6300-ZZ-C3	8.2	3.5	--	22000	
*	12	21	5	0.3	61801	1.8	1	23500	43000	0.006
ANQ829	12	21	5	0.3	61801-2RS	1.8	1	--	21000	0.006
ANQ830	12	21	5	0.3	61801-ZZ	1.8	1	--	32000	0.006
*	12	24	6	0.3	61901	2.2	1.5	23300	40000	0.011
ANQ837	12	24	6	0.3	61901-2RS	2.2	1.5	--	20000	0.011
ANQ838	12	24	6	0.3	61901-ZZ	2.2	1.5	--	30000	0.011
*	12	28	8	0.3	6001	5.1	2.4	24300	38000	0.02
ANQ798	12	28	8	0.3	6001-2RS	5.1	2.4	--	17000	0.02
*	12	28	8	0.3	6001-Z	5.1	2.4	--	26000	0.02
ANQ799	12	28	8	0.3	6001-ZZ	5.1	2.4	--	26000	0.02
*	12	32	10	0.6	6201	6.8	3.1	22200	32000	0.04
ANQ803	12	32	10	0.6	6201-2RS	6.8	3.1	--	16000	0.04
*	12	32	10	0.6	6201-Z	6.8	3.1	--	24000	0.04
ANQ804	12	32	10	0.6	6201-ZZ	6.8	3.1	--	24000	0.04
*	12	37	12	1	6301	9.7	4.2	20000	28000	0.06
ANQ757	12	37	12	1	6301-2RS	9.7	4.2	--	13000	0.06
*	12	37	12	1	6301-Z	9.7	4.2	--	20000	0.06
ANQ758	12	37	12	1	6301-ZZ	9.7	4.2	--	20000	0.06
*	15	24	5	0.3	61802	2	1.3	19200	38000	0.007
ANQ831	15	24	5	0.3	61802-2RS	2	1.3	--	18500	0.007
ANQ832	15	24	5	0.3	61802-ZZ	2	1.3	--	28000	0.007
*	15	28	7	0.3	61902	4.3	2.3	20600	34000	0.016
ANQ839	15	28	7	0.3	61902-2RS	4.3	2.3	--	16000	0.016
ANQ840	15	28	7	0.3	61902-ZZ	4.3	2.3	--	24000	0.016
*	15	32	8	0.3	16002	5.6	2.8	20000	32000	0.03
*	15	32	9	0.3	6002	5.6	2.8	21500	32000	0.029

### Deep Groove Ball Bearing

- P0 grade
- C0 clearance
- GCr15 material

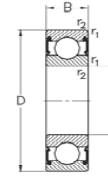
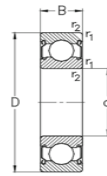
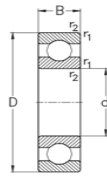

-2Z

-2RSR



SAP Code	Dimensions				Type	Loading ratings (kN)		Thermal speed ratings [rpm]	Limited speed ratings [rpm]	Weight kg
	d	D	B	r1,r2 min		dyn. Cr	stat. C0r	nG	n θ	
ANQ800	15	32	9	0.3	6002-2RS	5.6	2.8	--	15000	0.029
*	15	32	9	0.3	6002-Z	5.6	2.8	--	24000	0.029
ANQ801	15	32	9	0.3	6002-ZZ	5.6	2.8	--	24000	0.029
*	15	35	11	0.6	6202	7.6	3.7	20200	28000	0.043
ANQ805	15	35	11	0.6	6202-2RS	7.6	3.7	--	13000	0.043
*	15	35	11	0.6	6202-Z	7.6	3.7	--	20000	0.043
ANQ732	15	35	11	0.6	6202-ZZ	7.6	3.7	--	20000	0.043
*	15	42	13	1	6302	11.4	5.4	17500	24000	0.08
ANQ759	15	42	13	1	6302-2RS	11.4	5.4	--	12000	0.08
*	15	42	13	1	6302-Z	11.4	5.4	--	18000	0.08
ANQ760	15	42	13	1	6302-ZZ	11.4	5.4	--	18000	0.08
*	17	26	5	0.3	61803	2.1	1.4	17100	34000	0.008
ANQ833	17	26	5	0.3	61803-2RS	2.1	1.4	--	16000	0.008
ANQ834	17	26	5	0.3	61803-ZZ	2.1	1.4	--	24000	0.008
*	17	30	7	0.3	61903	4.6	2.6	18500	32000	0.018
ANQ841	17	30	7	0.3	61903-2RS	4.6	2.6	--	14500	0.018
ANQ842	17	30	7	0.3	61903-ZZ	4.6	2.6	--	22000	0.018
*	17	35	8	0.3	16003	6	3.3	17700	28000	0.03
*	17	35	10	0.3	6003	6	3.3	20300	28000	0.037
ANQ802	17	35	10	0.3	6003-2RS	6	3.3	--	13000	0.037
*	17	35	10	0.3	6003-Z	6	3.3	--	22000	0.037
ANQ709	17	35	10	0.3	6003-ZZ	6	3.3	--	22000	0.037
*	17	40	12	0.6	6203	9.6	4.8	18100	24000	0.063
ANQ806	17	40	12	0.6	6203-2RS	9.6	4.8	--	12000	0.063
*	17	40	12	0.6	6203-Z	9.6	4.8	--	18000	0.063
ANQ807	17	40	12	0.6	6203-ZZ	9.6	4.8	--	18000	0.063
*	17	47	14	1	6303	13.6	6.6	15900	22000	0.11
ANQ761	17	47	14	1	6303-2RS	13.6	6.6	--	10500	0.11
*	17	47	14	1	6303-Z	13.6	6.6	--	16000	0.11
ANQ762	17	47	14	1	6303-ZZ	13.6	6.6	--	16000	0.11
*	17	62	17	1.1	6403	22.7	10.8	13700	18000	0.275
*	20	32	7	0.3	61804	3.5	2.2	16600	28000	0.018
ANQ843	20	32	7	0.3	61804-2RS	3.5	2.2	--	12500	0.018
ANQ845	20	32	7	0.3	61804-ZZ	3.5	2.2	--	19000	0.018
*	20	37	9	0.3	61904	6.4	3.7	17000	26000	0.038
ANQ854	20	37	9	0.3	61904-2RS	6.4	3.7	--	12000	0.038
ANQ855	20	37	9	0.3	61904-ZZ	6.4	3.7	--	18000	0.038
*	20	42	8	0.3	16004	7.9	4.5	14300	24000	0.049
*	20	42	12	0.6	6004	9.4	5	18300	24000	0.065

### Deep Groove Ball Bearing

- P0 grade
- C0 clearance
- GCr15 material

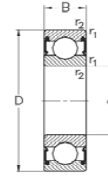
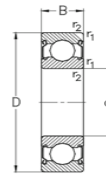
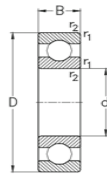

-2Z

-2RSR



SAP Code	Dimensions				Type	Loading ratings (kN)		Thermal speed ratings [rmp]	Limited speed ratings [rmp]	Weight kg
	d	D	B	r1,r2 min		dyn. Cr	stat. C0r	nG	n θ	
ANQ710	20	42	12	0.6	6004-2RS	9.4	5	--	11000	0.065
*	20	42	12	0.6	6004-Z	9.4	5	--	17000	0.065
ANQ711	20	42	12	0.6	6004-ZZ	9.4	5	--	17000	0.065
*	20	47	14	1	6204	12.8	6.7	16300	20000	0.105
ANQ733	20	47	14	1	6204-2RS	12.8	6.7	--	9900	0.105
*	20	47	14	1	6204-Z	12.8	6.7	--	15000	0.105
ANQ734	20	47	14	1	6204-ZZ	12.8	6.7	--	15000	0.105
*	20	52	15	1.1	6304	15.9	7.9	14400	19000	0.148
ANQ763	20	52	15	1.1	6304-2RS	15.9	7.9	--	9300	0.148
*	20	52	15	1.1	6304-Z	15.9	7.9	--	14000	0.148
ANQ764	20	52	15	1.1	6304-ZZ	15.9	7.9	--	14000	0.148
*	20	72	19	1.1	6404	31	15.3	12200	15000	0.412
*	22	50	14	1	62/22	14	7.7	14900	19000	0.11
*	22	50	14	1	62/22-2RS	14	7.7	--	11500	0.11
*	22	50	14	1	62/22-ZZ	14	7.7	--	15000	0.11
*	22	56	16	1.1	63/22	18.4	9.3	13500	18000	0.16
*	22	56	16	1.1	63/22-2RS	18.4	9.3	--	9500	0.16
*	22	56	16	1.1	63/22-ZZ	18.4	9.3	--	14000	0.16
*	25	37	7	0.3	61805	3.7	2.6	13500	24000	0.022
ANQ877	25	37	7	0.3	61805-2RS	3.7	2.6	--	11000	0.022
ANQ846	25	37	7	0.3	61805-ZZ	3.7	2.6	--	17000	0.022
*	25	42	9	0.3	61905	6.7	4.2	14100	22000	0.045
ANQ856	25	42	9	0.3	61905-2RS	6.6	4.2	--	10500	0.045
ANQ857	25	42	9	0.3	61905-ZZ	6.7	4.2	--	16000	0.045
*	25	47	8	0.3	16005	7.2	4.7	11900	20000	0.056
*	25	47	12	0.6	6005	10	5.8	15300	20000	0.078
ANQ712	25	47	12	0.6	6005-2RS	10.1	5.9	--	15000	0.078
*	25	47	12	0.6	6005-Z	10.1	5.9	--	15000	0.078
ANQ713	25	47	12	0.6	6005-ZZ	10.1	5.9	--	15000	0.078
*	25	52	15	1	6205	14	7.9	14400	18000	0.125
ANQ735	25	52	15	1	6205-2RS	14	7.9	--	9300	0.125
ANT036	25	52	15	1	6205.K.2RS					0.125
*	25	52	15	1	6205-Z	14	7.9	--	14000	0.125
ANQ736	25	52	15	1	6205-ZZ	14	7.9	--	14000	0.125
*	25	62	17	1.1	6305	22.4	11.5	12300	16000	0.232
ANQ765	25	62	17	1.1	6305-2RS	22.4	11.5	--	7300	0.232
*	25	62	17	1.1	6305-Z	22.4	11.5	--	11000	0.232
ANQ766	25	62	17	1.1	6305-ZZ	22.4	11.5	--	11000	0.232
*	25	80	21	1.5	6405	38.3	19.3	11000	13000	0.543

### Deep Groove Ball Bearing

- P0 grade
- C0 clearance
- GCr15 material

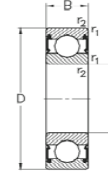
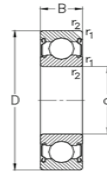
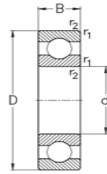

-2Z

-2RSR



SAP Code	Dimensions				Type	Loading ratings (kN)		Thermal speed ratings [rpm]	Limited speed ratings [rpm]	Weight kg
	d	D	B	r1,r2 min		dyn. Cr	stat. C0r	nG	n θ	
*	28	58	16	1	62/28	16.6	9.4	13100	16000	0.17
*	28	58	16	1	62/28-2RS	16.6	9.4	--	9500	0.17
*	28	58	16	1	62/28-ZZ	16.6	9.4	--	14000	0.17
ANQ871	28	68	18	1.1	63/28	25	13.8	11300	14000	0.29
*	28	68	18	1.1	63/28-2RS	25	13.8	--	9000	0.29
*	28	68	18	1.1	63/28-ZZ	25	13.8	--	9000	0.29
*	30	42	7	0.3	61806	4	3.2	11300	20000	0.027
ANQ872	30	42	7	0.3	61806-2RS	4	3.2	--	10000	0.027
ANQ847	30	42	7	0.3	61806-ZZ	4	3.2	--	15000	0.027
*	30	47	9	0.3	61906	7.2	5	11900	19000	0.051
ANQ858	30	47	9	0.3	61906-2RS	7.2	5	--	9500	0.051
ANQ859	30	47	9	0.3	61906-ZZ	7.2	5	--	14000	0.051
*	30	55	9	0.3	16006	11.2	7.4	10500	17000	0.084
*	30	55	13	1	6006	13.2	8.3	13100	17000	0.115
ANQ714	30	55	13	1	6006-2RS	13.2	8.3	--	8500	0.115
*	30	55	13	1	6006-Z	13.2	8.3	--	13000	0.115
ANQ715	30	55	13	1	6006-ZZ	13.2	8.3	--	13000	0.115
*	30	62	16	1	6206	19.5	11.3	12000	15000	0.192
ANQ737	30	62	16	1	6206-2RS	19.5	11.3	--	7300	0.192
ANT037	30	62	16	1	6206.K.2RS					0.192
*	30	62	16	1	6206-Z	19.5	11.3	--	11000	0.192
ANQ738	30	62	16	1	6206-ZZ	19.5	11.3	--	11000	0.192
*	30	72	19	1.1	6306	27	15.2	10800	13000	0.348
ANQ767	30	72	19	1.1	6306-2RS	27	15.2	--	6300	0.348
*	30	72	19	1.1	6306-Z	27	15.2	--	9500	0.348
ANQ768	30	72	19	1.1	6306-ZZ	27	15.2	--	9500	0.348
*	30	90	23	1.5	6406	47.4	24.5	9900	11000	0.746
*	35	47	7	0.3	61807	4.3	3.6	9600	18000	0.03
ANQ844	35	47	7	0.3	61807-2RS	4.3	3.6	--	8500	0.03
ANQ848	35	47	7	0.3	61807-ZZ	4.3	3.6	--	13000	0.03
*	35	55	10	0.6	61907	10.4	7.2	10500	16000	0.08
ANQ860	35	55	10	0.6	61907-2RS	10.4	7.2	--	7500	0.08
ANQ861	35	55	10	0.6	61907-ZZ	10.4	7.2	--	11000	0.08
*	35	62	9	0.3	16007	12.2	8.8	8900	15000	0.107
*	35	62	14	1	6007	16.2	10.4	11600	15000	0.151
ANQ716	35	62	14	1	6007-2RS	16.2	10.4	--	7300	0.151
ANT035	35	62	14	1	6207.K.2RS					0.151
*	35	62	14	1	6007-Z	16.2	10.4	--	11000	0.151
ANQ717	35	62	14	1	6007-ZZ	16.2	10.4	--	11000	0.151

### Deep Groove Ball Bearing

- P0 grade
- C0 clearance
- GCr15 material

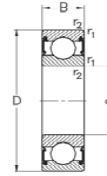
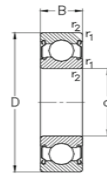
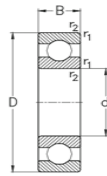

-2Z

-2RSR

SAP Code	Dimensions				Type	Loading ratings (kN)		Thermal speed ratings [rpm]	Limited speed ratings [rpm]	Weight kg
	d	D	B	r1,r2 min		dyn. Cr	stat. C0r	nG	nθ	
*	35	72	17	1.1	6207	25.7	15.3	10300	13000	0.288
ANQ739	35	72	17	1.1	6207-2RS	25.7	15.3	--	6300	0.288
*	35	72	17	1.1	6207-Z	25.7	15.3	--	9500	0.288
ANQ740	35	72	17	1.1	6207-ZZ	25.7	15.3	--	9500	0.288
*	35	80	21	1.5	6307	33.4	19.2	9900	12000	0.458
ANQ769	35	80	21	1.5	6307-2RS	33.4	19.2	--	5600	0.458
*	35	80	21	1.5	6307-Z	33.4	19.2	--	8500	0.458
ANQ770	35	80	21	1.5	6307-ZZ	33.4	19.2	--	8500	0.458
*	35	100	25	1.5	6407	57	30.1	9000	10000	0.928
*	40	52	7	0.3	61808	4.4	3.9	8400	16000	0.034
ANQ873	40	52	7	0.3	61808-2RS	4.4	3.9	--	7000	0.034
ANQ849	40	52	7	0.3	61808-ZZ	4.4	3.9	--	11000	0.034
*	40	62	12	0.6	61908	12.2	8.9	10100	14000	0.12
ANQ862	40	62	12	0.6	61908-2RS	12.2	8.9	--	6500	0.12
ANQ863	40	62	12	0.6	61908-ZZ	12.2	8.9	--	10000	0.12
*	40	68	9	0.3	16008	12.6	9.7	7900	14000	0.126
*	40	68	15	1	6008	17	11.7	10700	14000	0.188
ANQ718	40	68	15	1	6008-2RS	17	11.7	--	6600	0.188
*	40	68	15	1	6008-Z	17	11.7	--	10000	0.188
ANQ719	40	68	15	1	6008-ZZ	17	11.7	--	10000	0.188
*	40	80	18	1.1	6208	29.5	18.2	9300	11000	0.366
ANQ741	40	80	18	1.1	6208-2RS	29.5	18.2	--	5600	0.366
ANT038	40	80	18	1.1	6208.K.2RS					0.366
*	40	80	18	1.1	6208-Z	29.5	18.2	--	8500	0.366
ANQ742	40	80	18	1.1	6208-ZZ	29.5	18.2	--	8500	0.366
*	40	90	23	1.5	6308	40.8	24	9000	11000	0.632
ANQ771	40	90	23	1.5	6308-2RS	40.8	24	--		0.632
*	40	90	23	1.5	6308-Z	40.8	24	--	7500	0.632
ANQ772	40	90	23	1.5	6308-ZZ	40.8	24	--	7500	0.632
*	40	110	27	2	6408	66	37.7	8200	9000	1.18
*	45	58	7	0.3	61809	4.6	4.3	7300	14000	0.04
ANQ874	45	58	7	0.3	61809-2RS	4.6	4.3	--	6300	0.04
ANQ850	45	58	7	0.3	61809-ZZ	4.6	4.3	--	9500	0.04
*	45	68	12	0.6	61909	14.1	10.9	9000	13000	0.14
ANQ864	45	68	12	0.6	61909-2RS	14.1	10.9	--	6000	0.14
ANQ865	45	68	12	0.6	61909-ZZ	14.1	10.9	--	9000	0.14
*	45	75	10	0.6	16009	15.6	12.2	7400	12000	0.168
*	45	75	16	1	6009	21.1	14.8	9800	12000	0.231
ANQ720	45	75	16	1	6009-2RS	21.1	14.8	--	6000	0.231

### Deep Groove Ball Bearing

- P0 grade
- C0 clearance
- GCr15 material

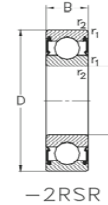
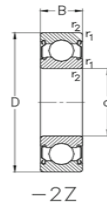
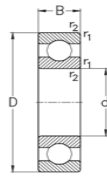

SAP Code	Dimensions				Type	Loading ratings (kN)		Thermal speed ratings [rpm]	Limited speed ratings [rpm]	Weight kg
	d	D	B	r1,r2 min		dyn. Cr	stat. C0r	nG	n θ	
*	45	75	16	1	6009-Z	21.1	14.8	--	9000	0.231
ANQ721	45	75	16	1	6009-ZZ	21.1	14.8	--	9000	0.231
*	45	85	19	1.1	6209	31.7	20.7	8700	11000	0.405
ANQ743	45	85	19	1.1	6209-2RS	31.7	20.7	--	5300	0.405
ANT039	45	85	19	1.1	6209.K.2RS					
*	45	85	19	1.1	6209-Z	31.7	20.7	--	8000	0.405
ANQ744	45	85	19	1.1	6209-ZZ	31.7	20.7	--	8000	0.405
*	45	100	25	1.5	6309	53	31.9	8300	9500	0.848
ANQ773	45	100	25	1.5	6309-2RS	53	31.9	--	4400	0.848
*	45	100	25	1.5	6309-Z	53	31.9	--	6700	0.848
ANQ774	45	100	25	1.5	6309-ZZ	53	31.9	--	6700	0.848
*	45	120	29	2	6409	78	45.4	7600	8500	1.51
*	50	65	7	0.3	61810	5.5	5.3	6400	13000	0.052
ANQ851	50	65	7	0.3	61810-ZZ	5.5	5.3			
ANQ878	50	65	7	0.3	61810-2RS	5.5	5.3			
*	50	72	12	0.6	61910	13.9	11	8100	12000	0.14
ANQ866	50	72	12	0.6	61910-2RS	13.9	11	--	5500	0.14
ANQ867	50	72	12	0.6	61910-ZZ	13.9	11	--	8500	0.14
*	50	80	10	0.6	16010	16.1	13.2	6700	11000	0.18
*	50	80	16	1	6010	21.8	16.6	8900	11000	0.261
ANQ722	50	80	16	1	6010-2RS	21.8	16.6	--	5600	0.261
*	50	80	16	1	6010-Z	21.8	16.6	--	8500	0.261
ANQ723	50	80	16	1	6010-ZZ	21.8	16.6	--	8500	0.261
*	50	90	20	1.1	6210	35.1	23.2	8200	10000	0.453
ANQ745	50	90	20	1.1	6210-2RS	35.1	23.2	--	5000	0.453
*	50	90	20	1.1	6210-Z	35.1	23.2	--	7500	0.453
ANQ746	50	90	20	1.1	6210-ZZ	35.1	23.2	--	7500	0.453
*	50	110	27	2	6310	62	38	7700	8500	1.1
ANQ775	50	110	27	2	6310-2RS	62	38	--	4000	1.1
*	50	110	27	2	6310-Z	62	38	--	6000	1.1
ANQ776	50	110	27	2	6310-ZZ	62	38	--	6000	1.1
*	50	130	31	2.1	6410	92	55	7100	7500	1.83
*	55	72	9	0.3	61811	9.04	8.8	6600	12000	0.083
ANQ852	55	72	9	0.3	61811-ZZ	9.04	8.8			
ANQ875	55	72	9	0.3	61811-2RS	9.04	8.8			
*	55	80	13	1	61911	16	13.3	7500	11000	0.19
ANQ868	55	80	13	1	61911-ZZ	16	13.3			
ANQ876	55	80	13	1	61911-2RS	16	13.3			
*	55	90	11	0.6	16011	19.5	16.3	6200	10000	0.26

### Deep Groove Ball Bearing

- P0 grade
- C0 clearance
- GCr15 material

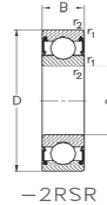
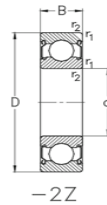
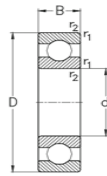

SAP Code	Dimensions				Type	Loading ratings (kN)		Thermal speed ratings [rpm]	Limited speed ratings [rpm]	Weight kg
	d	D	B	r1,r2 min		dyn. Cr	stat. C0r	nG	n θ	
*	55	90	18	1.1	6011	28.2	21.3	8300	10000	0.311
ANQ724	55	90	18	1.1	6011-2RS	28.2	21.3	--	5000	0.311
*	55	90	18	1.1	6011-Z	28.2	21.3	--	7500	0.311
ANQ725	55	90	18	1.1	6011-ZZ	28.2	21.3	--	7500	0.311
*	55	100	21	1.5	6211	43.4	29.2	7500	9000	0.607
ANQ747	55	100	21	1.5	6211-2RS	43.4	29.2	--	4400	0.607
ANQ748	55	100	21	1.5	6211-2RS-C3	43.4	29.2	--	4400	
*	55	100	21	1.5	6211-Z	43.4	29.2	--	6700	0.607
ANQ749	55	100	21	1.5	6211-ZZ	43.4	29.2	--	6700	0.607
ANQ750	55	100	21	1.5	6211-ZZ-C3	43.4	29.2	--	6700	
*	55	120	29	2	6311	72	44.8	7200	8000	1.39
*	55	120	29	2	6311-RS	72	44.8	--	3500	1.39
ANQ777	55	120	29	2	6311-2RS	72	44.8	--	3500	1.39
*	55	120	29	2	6311-Z	72	44.8	--	5300	1.39
ANQ778	55	120	29	2	6311-ZZ	72	44.8	--	5300	1.39
*	55	140	33	2.1	6411	101	63	6700	7000	2.4
*	60	78	10	0.3	61812	11.5	10.6	6400	11000	0.11
ANQ853	60	78	10	0.3	61812-ZZ	11.5	10.6	--		
ANQ879	60	78	10	0.3	61812-2RS	11.5	10.6	5600		
*	60	85	13	1	61912	19.5	16.3	6900	10000	0.2
ANQ880	60	85	13	1	61912-2RS	19.5	16.3	5000		
*	60	95	11	0.6	16012	19.9	17.5	5700	*	0.28
*	60	95	18	1.1	6012	29.4	23.2	7700	*	0.41
ANQ726	60	95	18	1.1	6012-2RS	29.4	23.2	--	4500	0.41
*	60	95	18	1.1	6012-Z	29.4	23.2	--	*	0.41
ANQ727	60	95	18	1.1	6012-ZZ	29.4	23.2	--	*	0.41
ANQ728	60	95	18	1.1	6012-ZZ-C3	29.4	23.2	--	7000	
*	60	110	22	1.5	6212	47.7	33	6900	*	0.783
ANQ751	60	110	22	1.5	6212-2RS	47.7	33	--	4000	0.783
ANQ752	60	110	22	1.5	6212-2RS-C3	47.7	33	--	4000	
*	60	110	22	1.5	6212-Z	47.7	33	--	*	0.783
ANQ753	60	110	22	1.5	6212-ZZ	47.7	33	--	*	0.783
ANQ754	60	110	22	1.5	6212-ZZ-C3	47.7	33	--	6000	
*	60	130	31	2.1	6312	82	51.9	6800	*	1.72
*	60	130	31	2.1	6312-RS	82	51.9	--	*	1.72
ANQ779	60	130	31	2.1	6312-2RS	82	52	--	*	1.72
*	60	130	31	2.1	6312-Z	82	52	--	*	1.72
ANQ780	60	130	31	2.1	6312-ZZ	82	52	--	*	1.72
*	60	150	35	2.1	6412	109	70	6400	*	2.8

### Deep Groove Ball Bearing

- P0 grade
- C0 clearance
- GCr15 material

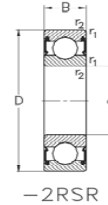
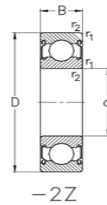
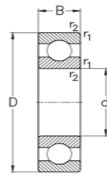

SAP Code	Dimensions				Type	Loading ratings (kN)		Thermal speed ratings [rpm]	Limited speed ratings [rpm]	Weight kg
	d	D	B	r1,r2 min		dyn. Cr	stat. C0r	nG	n θ	
*	65	85	10	0.6	61813	9.7	9.8	5800	*	0.13
*	65	90	13	1	61913	19.9	17.5	6300	*	0.22
*	65	100	11	0.6	16013	21.2	19.7	5300	*	0.298
*	65	100	18	1.1	6013	30.5	25.2	7100	*	0.436
*	65	100	18	1.1	6013-RS	30.5	25.2	--	4100	0.436
*	65	100	18	1.1	6013-2RS	30.5	25.2	--	*	0.436
*	65	100	18	1.1	6013-Z	30.5	25.2	--	*	0.436
*	65	100	18	1.1	6013-ZZ	30.5	25.2	--	*	0.436
*	65	120	23	1.5	6213	57	40	6400	*	0.982
*	65	120	23	1.5	6213-RS	57	40	--	3500	0.982
ANQ811	65	120	23	1.5	6213-2RS	57	40	--	*	0.982
*	65	120	23	1.5	6213-Z	57	40	--	*	0.982
ANQ813	65	120	23	1.5	6213-ZZ	57	40	--	*	0.982
ANQ814	65	120	23	1.5	6213-ZZ-C3	57	40	--	5300	
*	65	140	33	2.1	6313	93	60	6400	*	2.13
*	65	140	33	2.1	6313-RS	93	60	--	3000	2.13
*	65	140	33	2.1	6313-2RS	93	60	--	*	2.13
*	65	140	33	2.1	6313-Z	93	60	--	*	2.13
*	65	140	33	2.1	6313-ZZ	93	60	--	*	2.13
*	65	160	37	2.1	6413	118	79	6100	*	3.3
*	70	90	10	0.6	61814	9.8	0.5	9000	*	0.14
*	70	100	16	1	61914	27.1	23.3	6400	*	0.35
*	70	110	13	0.6	16014	27.9	25.1	5300	*	0.43
*	70	110	20	1.1	6014	38	30.9	6800	*	0.6
*	70	110	20	1.1	6014-RS	38	30.9	--	4000	0.604
*	70	110	20	1.1	6014-2RS	38	30.9	--	*	0.604
*	70	110	20	1.1	6014-Z	38	30.9	--	*	0.604
*	70	110	20	1.1	6014-ZZ	38	30.9	--	*	0.604
*	70	125	24	1.5	6214	61	45.1	6100	*	1.08
*	70	125	24	1.5	6214-RS	61	45.1	--	3300	1.08
ANQ815	70	125	24	1.5	6214-2RS	61	45.1	--	*	1.08
ANQ815	70	125	24	1.5	6214-2RS	61	45.1	--	*	
ANQ816	70	125	24	1.5	6214-2RS-C3	61	45.1	--	3300	
*	70	125	24	1.5	6214-Z	61	45.1	--	*	1.08
ANQ817	70	125	24	1.5	6214-ZZ	61	45.1	--	*	1.08
ANQ818	70	125	24	1.5	6214-ZZ-C3	61	45.1	--	5000	
*	70	150	35	2.1	6314	104	68	6100	*	2.63
*	70	150	35	2.1	6314-RS	104	68	--	2800	2.63
*	70	150	35	2.1	6314-2RS	104	68	--	*	2.63

### Deep Groove Ball Bearing

- P0 grade
- C0 clearance
- GCr15 material

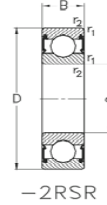
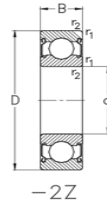
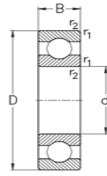

SAP Code	Dimensions				Type	Loading ratings (kN)		Thermal speed ratings [rpm]	Limited speed ratings [rpm]	Weight kg
	d	D	B	r1,r2 min		dyn. Cr	stat. C0r	nG	n θ	
*	70	150	35	2.1	6314-Z	104	68	--	*	2.63
*	70	150	35	2.1	6314-ZZ	104	68	--	*	2.63
*	70	180	42	3	6414	140	100	5700	*	4.8
*	75	95	10	0.6	61815	13.3	13.1	5000	*	0.15
*	75	105	16	1	61915	27.9	25.1	6000	*	0.37
*	75	115	13	0.6	16015	28.6	26.8	4900	*	0.456
*	75	115	20	1.1	6015	39.5	33.5	6400	*	0.643
*	75	115	20	1.1	6015-RS	39.5	33.5	--	3700	0.643
*	75	115	20	1.1	6015-2RS	39.5	33.5	--	*	0.643
*	75	115	20	1.1	6015-Z	39.5	33.5	--	*	0.643
*	75	115	20	1.1	6015-ZZ	39.5	33.5	--	*	0.643
*	75	130	25	1.5	6215	66	49.5	5900	*	1.21
*	75	130	25	1.5	6215-RS	66	49.5	--	6700	1.21
ANQ819	75	130	25	1.5	6215-2RS	66	49.5	--	*	1.21
ANQ820	75	130	25	1.5	6215-2RS-C3	66	49.5	--	3200	
*	75	130	25	1.5	6215-Z	66	49.5	--	*	1.21
ANQ821	75	130	25	1.5	6215-ZZ	66	49.5	--	*	1.21
ANQ822	75	130	25	1.5	6215-ZZ-C3	66	49.5	--	4800	
*	75	160	37	2.1	6315	114	77	6300	*	3.12
*	75	160	37	2.1	6315-RS	114	77	--	2700	3.12
*	75	160	37	2.1	6315-2RS	114	77	--	*	3.12
*	75	160	37	2.1	6315-Z	114	77	--	*	3.12
*	75	160	37	2.1	6315-ZZ	114	77	--	*	3.12
*	75	190	45	3	6415	154	114	5600	*	6.75
*	80	100	10	0.6	61816	15.9	16.8	4600	*	0.15
*	80	110	16	1	61916	27.6	25.3	5600	*	0.4
*	80	125	14	0.6	16016	33.1	31.4	4700	*	0.615
*	80	125	22	1.1	6016	51	42	6100	*	0.85
*	80	125	22	1.1	6016-RS	51	42	--	3300	0.85
*	80	125	22	1.1	6016-2RS	51	42	--	*	0.85
*	80	125	22	1.1	6016-Z	51	42	--	*	0.85
*	80	125	22	1.1	6016-ZZ	51	42	--	*	0.85
*	80	140	26	2	6216	72	54	5500	*	1.42
*	80	140	26	2	6216-RS	72	54	--	6000	1.42
ANQ823	80	140	26	2	6216-2RS	72	54	--	*	1.42
ANQ824	80	140	26	1.5	6216-2RS-C3	72	54	--	3000	
*	80	140	26	2	6216-Z	72	54	--	*	1.42
ANQ825	80	140	26	2	6216-ZZ	72	54	--	*	1.42
ANQ826	80	140	26	1.5	6216-ZZ-C3	72	54	--	4500	

### Deep Groove Ball Bearing

- P0 grade
- C0 clearance
- GCr15 material

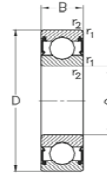
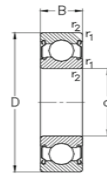
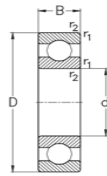

SAP Code	Dimensions				Type	Loading ratings (kN)		Thermal speed ratings [rpm]	Limited speed ratings [rpm]	Weight kg
	d	D	B	r1,r2 min		dyn. Cr	stat. C0r	nG	n θ	
*	80	170	39	2.1	6316	123	87	5500	*	3.73
*	80	170	39	2.1	6316-RS	123	87	--	*	3.73
*	80	170	39	2.1	6316-2RS	123	87	--	2500	3.73
*	80	170	39	2.1	6316-Z	123	87	--	*	3.73
*	80	170	39	2.1	6316-ZZ	123	87	--	*	3.73
*	80	200	48	3	6416	163	125	5400	*	8
*	85	110	13	1	61817	15.9	16.8	4900	*	0.27
*	85	120	18	1.1	61917	34	29.9	5500	*	0.55
*	85	130	14	0.6	16017	34	33.3	4400	*	0.641
*	85	130	22	1.1	6017	53	45.6	5800	*	0.895
*	85	130	22	1.1	6017-RS	53	45.6	--	*	0.895
*	85	130	22	1.1	6017-2RS	53	45.6	--	3200	0.895
*	85	130	22	1.1	6017-Z	53	45.6	--	*	0.895
*	85	130	22	1.1	6017-ZZ	53	45.6	--	*	0.895
*	85	150	28	2	6217	84	62	5300	*	1.82
*	85	150	28	2	6217-RS	84	62	--	*	1.82
*	85	150	28	2	6217-2RS	84	62	--	2800	1.82
*	85	150	28	2	6217-Z	84	62	--	*	1.82
*	85	150	28	2	6217-ZZ	84	62	--	*	1.82
*	85	180	41	3	6317	133	97	5300	*	4.24
*	85	180	41	3	6317-RS	133	97	--	*	4.24
*	85	180	41	3	6317-2RS	133	97	--	2300	4.24
ANR164	15.88	40	12	0.6	6203-5/8"-2RS			18000		0.063
ANR165	25.4	52	15	1	6205-1"-2RS			14400		0.123

### Insert Bearing & Housing

- Bearing: P0 grade, GCr15 material
- Housing: HT-200 material

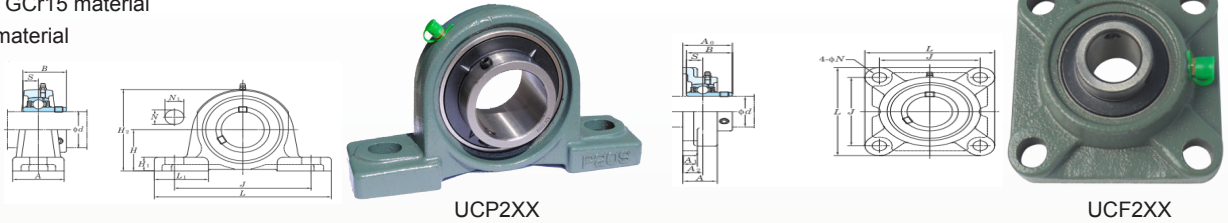

SAP Code	Type	Dimensions											Bolt mm	Loading ratings (N)				weight kg
		Ø d	H	L	J	A	N	N1	H1	H2	B	S		dyn. C	stat. Co	bearing	housing	
ASB520	UCP201	12	30.2	127	95	38	13	19	14	62	44.5	12.7	M10	12160	6318	UC201	P201	0.69
ANQ900	UCP202	15	30.2	127	95	38	13	19	14	62	44.5	12.7	M10	12160	6318	UC202	P203	0.69
ANQ901	UCP203	17	30.2	127	95	38	13	19	14	62	44.5	12.7	M10	12160	6318	UC203	P203	0.68
ANQ902	UCP204	20	33.3	127	95	38	13	19	14	65	44.5	12.7	M10	12160	6318	UC204	P204	0.66
ANQ903	UCP205	25	36.5	140	105	38	13	19	15	71	48	14.3	M10	13300	7457	UC205	P205	0.81
ANQ904	UCP206	30	42.9	165	121	48	17	20	17	84	53	15.9	M14	18525	10735	UC206	P206	1.24
ANQ905	UCP207	35	47.6	167	127	48	17	20	18	93	59.5	17.5	M14	24415	14630	UC207	P207	1.58
ANQ906	UCP208	40	49.2	184	137	54	17	20	18	100	69	19	M14	27645	16910	UC208	P208	1.89
ANQ907	UCP209	45	54	190	146	54	17	20	20	106	69	19	M14	32395	20235	UC209	P209	2.14
ANQ908	UCP210	50	57.2	206	159	60	20	23	21	113	74.5	19	M16	33345	22135	UC210	P210	2.66
ANQ909	UCP211	55	63.5	219	171	60	20	23	23	125	76	22.2	M16	41230	27930	UC211	P211	3.31
ANQ910	UCP212	60	69.8	241	184	70	20	23	25	138	89	25.4	M16	49780	34390	UC212	P212	4.9
ANQ911	UCP213	65	76.2	265	203	70	25	28	27	150	89	25.4	M20	54340	38095	UC213	P213	5.15
ANQ912	UCP214	70	79.4	266	210	72	25	28	27	156	-	30.2	M20	59090	41895	UC214	P214	6.2
ANQ913	UCP215	75	82.6	275	217	74	25	28	28	162	-	33.3	M20	64030	45885	UC215	P215	7.16
ANQ914	UCP216	80	88.9	292	232	78	25	28	30	174	-	33.3	M20	69065	50350	UC216	P216	8.1
ANQ915	UCP217	85	95.2	310	247	83	25	28	32	185	-	34.1	M20	79800	58805	UC217	P217	9.81
ANQ916	UCP218	90	101.6	327	262	88	27	30	33	198	-	39.7	M22	91295	67925	UC218	P218	11.96

SAP Code	Type	Dimensions										Bolt mm	Load ratings (N)				Weight kg
		Ø d	L	J	A2	A1	A	4-ØN	A0	S	dyn.		stat.	bearing	housing		
ANQ917	UCF201	12	86	64	15	12	25.5	12	31	12.7	M10	12160	6318	UC201	F204	0.6	
ANQ918	UCF202	15	86	64	15	12	25.5	12	31	12.7	M10	12160	6318	UC202	F204	0.59	
ANQ919	UCF203	17	86	64	15	12	25.5	12	31	12.7	M10	12160	6318	UC203	F204	0.58	
ANQ920	UCF204	20	86	64	15	12	25.5	12	31	12.7	M10	12160	6318	UC204	F204	0.56	
ANQ921	UCF205	25	95	70	16	14	27	12	34.1	14.3	M10	13300	7457	UC205	F205	0.8	
ANQ922	UCF206	30	108	83	18	14	31	12	38.1	15.9	M10	18525	10735	UC206	F206	1.12	
ANQ923	UCF207	35	117	92	19	16	34	14	42.9	17.5	M12	24415	14630	UC207	F207	1.46	
ANQ924	UCF208	40	130	102	21	16	36	16	49.2	19	M14	27645	16910	UC208	F208	1.84	
ANQ925	UCF209	45	137	105	22	18	38	16	49.2	19	M14	32395	20235	UC209	F209	2.15	
ANQ926	UCF210	50	143	111	22	18	40	16	51.6	19	M14	33345	22135	UC210	F210	2.42	
ANQ927	UCF211	55	162	130	25	20	43	19	55.6	22.2	M16	41230	27930	UC211	F211	3.31	
ANQ928	UCF212	60	175	143	29	20	48	19	65.1	25.4	M16	49780	34390	UC212	F212	4.28	
ANQ929	UCF213	65	187	149	30	22	50	19	65.1	25.4	M16	54340	38095	UC213	F213	4.99	
ANQ930	UCF214	70	193	152	31	22	54	19	74.6	30.2	M16	59090	41895	UC214	F214	5.85	
ANQ931	UCF215	75	200	159	34	22	56	19	77.8	33.3	M16	64030	45885	UC215	F215	6.91	
ANQ932	UCF216	80	208	165	34	22	58	23	82.6	33.3	M20	69065	50350	UC216	F216	7.5	
ANQ933	UCF217	85	220	175	36	24	63	23	85.7	34.1	M20	79800	58805	UC217	F217	9.66	
ANQ934	UCF218	90	235	187	40	24	68	23	96	39.7	M20	91295	67925	UC218	F218	12.06	

### Insert Bearing & Housing

- Bearing: P0 grade, GCr15 material
- Housing: HT-200 material

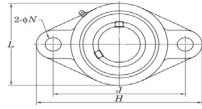
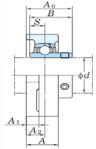

UCFL2XX

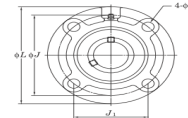
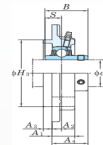

UCFC2XX

SAP Code	Type	Dimensions										Bolt mm	Loads ratings(N)				Weight kg
		d	H	J	A2	A1	A	2-ØN	B	A0	S		dyn. C	stat. C0	bearing	housing	
ANQ935	UCFL201	12	113	90	15	11	25.5	12	60	33.3	12.7	M10	12160	6318	UC201	FL204	0.45
ANQ936	UCFL202	15	113	90	15	11	25.5	12	60	33.3	12.7	M10	12160	6318	UC202	FL204	0.44
ANQ937	UCFL203	17	113	90	15	11	25.5	12	60	33.3	12.7	M10	12160	6318	UC203	FL204	0.43
ANQ938	UCFL204	20	113	90	15	11	25.5	12	60	33.3	12.7	M10	12160	6318	UC204	FL204	0.41
ANQ939	UCFL205	25	130	99	16	13	27	16	68	35.8	14.3	M14	13300	7457	UC205	FL205	0.58
ANQ940	UCFL206	30	148	117	18	13	31	16	80	40.2	15.9	M14	18525	10735	UC206	FL206	0.86
ANQ941	UCFL207	35	161	130	19	14	34	16	90	44.4	17.5	M14	24415	14630	UC207	FL207	1.08
ANQ942	UCFL208	40	175	144	21	14	36	16	100	51.2	19	M14	27645	16910	UC208	FL208	1.44
ANQ943	UCFL209	45	188	148	22	15	38	19	108	52.2	19	M16	32395	20235	UC209	FL209	1.74
ANQ944	UCFL210	50	197	157	22	15	40	19	115	54.6	19	M16	33345	22135	UC210	FL210	2.1
ANQ945	UCFL211	55	224	184	25	18	43	19	130	58.4	22.2	M16	41230	27930	UC211	FL211	2.91
ANQ946	UCFL212	60	250	202	29	18	48	23	140	68.7	25.4	M20	49780	34390	UC212	FL212	3.74
ANQ947	UCFL213	65	258	210	30	22	50	23	155	69.7	25.4	M20	54340	38095	UC213	FL213	4.57
ANQ948	UCFL214	70	265	216	31	22	54	23	160	75.4	30.2	M20	59090	41895	UC214	FL214	5.11
ANQ949	UCFL215	75	275	225	34	22	56	23	165	78.5	33.3	M20	64030	45885	UC215	FL215	5.37
ANQ950	UCFL216	80	290	233	34	22	58	25	180	83.3	33.3	M22	69065	50350	UC216	FL216	7.2
ANQ951	UCFL217	85	305	248	36	24	63	25	190	87.6	34.1	M22	79800	58805	UC217	FL217	8.61
ANQ952	UCFL218	90	320	265	40	24	68	25	205	96.3	39.7	M22	91295	67925	UC218	FL218	10.51

SAP Code	Type	Dimensions											Bolt mm	Loads ratings(N)				Weight kg	
		Ød	ØL	ØJ	J1	A2	4-ØN	A3	A2	A1	ØH3	A4		S	dyn. C	stat. C0	bearing		housing
*	UCFC201	12	100	78	55.1	10	12	5	7	20.5	62	28.3	12.7	M10	12160	6318	UC201	FC204	0.73
ANQ953	UCFC202	15	100	78	55.1	10	12	5	7	20.5	62	28.3	12.7	M10	12160	6318	UC202	FC204	0.72
ANQ954	UCFC203	17	100	78	55.1	10	12	5	7	20.5	62	28.3	12.7	M10	12160	6318	UC203	FC204	0.71
ANQ955	UCFC204	20	100	78	55.1	10	12	5	7	20.5	62	28.3	12.7	M10	12160	6318	UC204	FC204	0.69
ANQ956	UCFC205	25	115	90	63.6	10	12	6	7	21	70	29.8	14.3	M10	13300	7457	UC205	FC205	1
ANQ957	UCFC206	30	125	100	70.7	10	12	8	8	23	80	32.2	15.9	M10	18525	10735	UC206	FC206	1.3
ANQ958	UCFC207	35	135	110	77.8	11	14	8	9	26	90	36.4	17.5	M12	24415	14630	UC207	FC207	1.81
ANQ959	UCFC208	40	145	120	84.8	11	14	10	9	26	100	41.2	19	M12	27645	16910	UC208	FC208	2.14
ANQ960	UCFC209	45	160	132	93.3	10	16	12	14	26	105	40.2	19	M14	32395	20235	UC209	FC209	2.68
ANQ961	UCFC210	50	165	138	97.6	10	16	12	14	28	110	42.6	19	M14	33345	22135	UC210	FC210	2.9
ANQ962	UCFC211	55	185	150	106.1	13	19	12	15	31	125	46.4	22.2	M16	41230	27930	UC211	FC211	4.01
ANQ963	UCFC212	60	195	160	113.1	17	19	12	15	36	135	56.7	25.4	M16	49780	34390	UC212	FC212	4.94
ANQ964	UCFC213	65	205	170	120.2	16	19	14	15	36	145	55.7	25.4	M16	54340	38095	UC213	FC213	5.65
ANQ965	UCFC214	70	215	177	125.1	17	19	14	18	40	150	61.4	30.2	M16	59090	41895	UC214	FC214	6.95
ANQ966	UCFC215	75	220	184	130.1	18	19	16	18	40	160	62.5	33.3	M16	64030	45885	UC215	FC215	7.56
ANQ967	UCFC216	80	240	200	141.4	18	23	16	18	42	170	67.3	33.3	M20	69065	50350	UC216	FC216	9.15
ANQ968	UCFC217	85	250	208	147.1	18	23	18	20	45	180	69.6	34.1	M20	79800	58805	UC217	FC217	10.81
ANQ969	UCFC218	90	265	220	155.5	22	23	18	20	50	190	78.3	39.7	M20	91295	67925	UC218	FC218	12.96

### Insert Bearing & Housing

- Bearing: P0 grade, GCr15 material
- Housing: HT-200 material

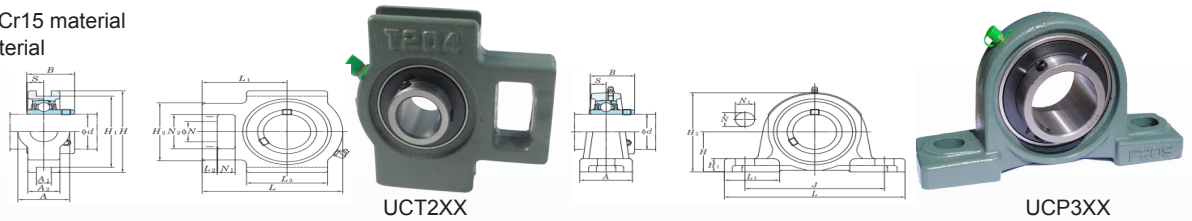

SAP Code	Type	Dimensions															Loads ratings(N)				Weight kg
		d	N1	L2	H2	N2	ØN	L3	A1	H1	H	L	A2	L1	B	S	dyn.C	stat. C0	bear- ing	hous- ing	
ANQ970	UCT201	12	16	10	51	32	19	51	12	76	89	94	24	61	31	12.7	12160	6318	UC201	T204	0.8
ANQ971	UCT202	15	16	10	51	32	19	51	12	76	89	94	24	61	31	12.7	12160	6318	UC202	T204	0.79
ANQ972	UCT203	17	16	10	51	32	19	51	12	76	89	94	24	61	31	12.7	12160	6318	UC203	T204	0.78
ANQ973	UCT204	20	16	10	51	32	19	51	12	76	89	94	24	61	31	12.7	12160	6318	UC204	T204	0.76
ANQ974	UCT205	25	16	10	51	32	19	51	12	76	89	97	24	62	34.1	14.3	13300	7457	UC205	T205	0.81
ANQ975	UCT206	30	16	10	56	37	22	57	12	89	102	113	28	70	38.1	15.9	18525	10735	UC206	T206	1.22
ANQ976	UCT207	35	16	13	64	37	22	64	12	89	102	129	30	78	42.9	17.5	24415	14630	UC207	T207	1.44
ANQ977	UCT208	40	19	16	83	49	29	83	16	102	114	144	35	89	49.2	19	27645	16910	UC208	T208	2.4
ANQ978	UCT209	45	19	16	83	49	29	83	16	102	117	144	35	87	49.2	19	32395	20235	UC209	T209	2.36
ANQ979	UCT210	50	19	16	83	49	29	86	16	102	117	149	35	90	51.6	19	33345	22135	UC210	T210	2.43
ANQ980	UCT211	55	25	19	102	64	35	95	22	130	146	171	41	106	55.6	22.2	41230	27930	UC211	T211	4.11
ANQ981	UCT212	60	32	19	102	64	35	102	22	130	146	194	46	119	65.1	25.4	49780	34390	UC212	T212	4.97
ANQ982	UCT213	65	32	21	111	70	41	121	26	151	167	224	51	137	65.1	25.4	54340	38095	UC213	T213	6.65
ANQ983	UCT214	70	32	21	111	70	41	121	26	151	167	224	46	137	74.6	30.2	59090	41895	UC214	T214	7.05
ANQ984	UCT215	75	32	21	111	70	41	121	26	151	167	232	48	140	77.8	33.3	64030	45885	UC215	T215	7.41
ANQ985	UCT216	80	32	21	111	70	41	121	26	165	184	235	51	140	82.6	33.3	69065	50350	UC216	T216	8.3
ANQ986	UCT217	85	38	29	124	73	48	157	30	173	189	260	54	162	85.7	34.1	79800	58805	UC217	T217	11
ANR172	UCT218	90	41	31	132	81	48	151	30	189	216	280	55	173	96	39.7	91295	67925	UC218	T218	12.75

SAP Code	Type	Dimensions											Bolt mm	Loading ratings(N)				Weight kg
		Ø d	H	L	J	A	N	N1	H1	H2	B	S		dyn. C	stat. Co	bearing	housing	
ANQ987	UCP305	25	45	175	132	45	17	20	15	85	38	15	M14	20140	10355	UC305	P305	1.4
ANQ988	UCP306	30	50	180	140	50	17	20	18	95	43	17	M14	25365	14250	UC306	P306	1.8
ANQ989	UCP307	35	56	210	160	56	17	25	20	106	48	19	M14	31730	18335	UC307	P307	2.8
ANQ990	UCP308	40	60	220	170	60	17	27	22	116	52	19	M14	38665	22800	UC308	P308	3
ANQ991	UCP309	45	67	245	190	67	20	30	24	129	57	22	M16	46455	28025	UC309	P309	4.1
ANQ992	UCP310	50	75	275	212	75	20	35	27	143	61	22	M16	58900	36385	UC310	P310	5.8
ANQ993	UCP311	55	80	310	236	80	20	38	30	154	66	25	M16	68020	42750	UC311	P311	7.4
ANQ994	UCP312	60	85	330	250	85	25	38	32	165	71	26	M20	77805	49590	UC312	P312	9.4
ANQ995	UCP313	65	90	340	260	90	25	38	33	176	75	30	M20	88065	56905	UC313	P313	10
ANQ996	UCP314	70	95	360	280	90	27	40	35	187	78	33	M22	98800	64790	UC314	P314	12
ANQ997	UCP315	75	100	380	290	100	27	40	35	198	82	32	M22	107350	73340	UC315	P315	14
ANQ998	UCP316	80	106	400	300	110	27	40	40	210	86	34	M22	111850	82365	UC316	P316	18
*	UCP317	85	112	420	320	110	33	45	40	220	96	40	M27	126350	91960	UC317	P317	20
ANQ999	UCP318	90	118	430	330	110	33	45	45	235	96	40	M27	135850	101650	UC318	P318	24
*	UCP319	95	125	470	360	120	36	50	45	250	103	41	M30	145350	113050	UC319	P319	29
ANR001	UCP320	100	140	490	380	120	36	50	50	275	108	42	M30	164350	133950	UC320	P320	35
*	UCP321	105	140	490	380	120	36	50	56	283	112	44	M33	174800	145350	UC321	P321	35
*	UCP322	110	150	520	400	140	40	55	61	303	117	46	M33	194750	171000	UC322	P322	45
ANR002	UCP324	120	160	570	450	140	40	55	71	323	126	51	M33	196650	175750	UC324	P324	55
*	UCP326	130	180	600	480	140	40	55	81	363	135	54	M33	217550	203300	UC326	P326	72
*	UCP328	140	200	620	500	140	40	55	81	403	145	59	M33	240350	233700	UC328	P328	89

### Insert Bearing & Housing

- Bearing: P0 grade, GCr15 material
- Housing: HT-200 material

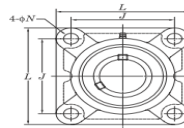
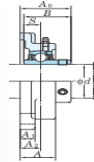

SAP Code	Type	Dimensions										Bolt mm	Load ratings (N)				Weight kg
		Ø d	L	J	A2	A1	A	4-ØN	A0	B	S		dyn.	stat.	bearing	housing	
ANR003	UCF305	25	110	80	16	13	29	16	39	38	15	M14	20140	10355	UC305	F305	1.1
ANR004	UCF306	30	125	95	18	15	32	16	44	43	17	M14	25365	14250	UC306	F306	1.6
ANR005	UCF307	35	135	100	20	16	36	19	49	48	19	M16	31730	18335	UC307	F307	2
ANR006	UCF308	40	150	112	23	17	40	19	56	52	19	M16	38665	22800	UC308	F308	2.7
ANR007	UCF309	45	160	125	25	18	44	19	60	57	22	M16	46455	28025	UC309	F309	3.4
ANR008	UCF310	50	175	132	28	19	48	23	67	61	22	M20	58900	36385	UC310	F310	4.5
ANR009	UCF311	55	185	140	30	20	52	23	71	66	25	M20	68020	42750	UC311	F311	5.5
ANR010	UCF312	60	195	150	33	22	56	23	78	71	26	M20	77805	49590	UC312	F312	6.5
ANR011	UCF313	65	208	166	33	22	58	23	78	75	30	M20	88065	56905	UC313	F313	7.9
ANR012	UCF314	70	226	178	36	25	61	25	81	78	33	M22	98800	64790	UC314	F314	9.5
ANR013	UCF315	75	236	184	39	25	66	25	89	82	32	M22	107350	73340	UC315	F315	12
ANR014	UCF316	80	250	196	38	27	68	31	90	86	34	M27	116850	82365	UC316	F316	14
*	UCF317	85	260	204	44	27	74	31	100	96	40	M27	126350	91960	UC317	F317	16
ANR015	UCF318	90	280	216	44	30	76	35	100	96	40	M30	135850	101650	UC318	F318	19
*	UCF319	95	290	228	59	30	94	35	121	103	41	M30	145350	113050	UC319	F319	22
ANR016	UCF320	100	310	242	59	32	94	38	125	108	42	M33	164350	133950	UC320	F320	25
*	UCF321	105	310	242	59	32	94	38	127	-	44	M33	174800	145350	UC321	F321	25.6
ANR017	UCF322	110	340	266	60	35	96	41	131	-	46	M36	194750	171000	UC322	F322	34.7
ANR018	UCF324	120	370	290	65	40	110	41	140	-	51	M36	196650	175750	UC324	F324	47.2
*	UCF326	130	410	320	65	45	115	41	146	-	54	M36	217550	203300	UC326	F326	62.7
*	UCF328	140	450	350	75	55	125	41	161	-	59	M36	240350	233700	UC328	F328	87

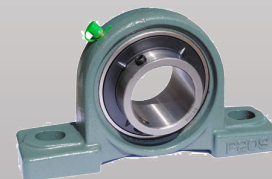
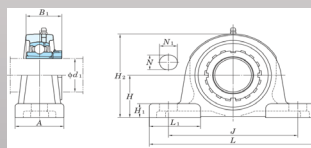

SAP Code	Type	Dimensions										Bolt mm	Load ratings (N)				Weight kg
		Ø d 1	H	L	J	A	N	N1	H1	H2	B1		dyn.C	stat.C0	bearing+sleeve	housing	
ANR051	UKP205	20	36.5	140	105	38	13	19	15	71	35	M10	13300	7457	UK205+H2305	P205	0.86
ANR052	UKP206	25	42.9	165	121	48	17	20	17	84	38	M14	18525	10735	UK206+H2306	P206	1.28
ANR053	UKP207	30	47.6	167	127	48	17	20	18	93	43	M14	24415	14630	UK207+H2307	P207	1.67
ANR054	UKP208	35	49.2	184	137	54	17	20	18	100	46	M14	27645	16910	UK208+H2308	P208	1.99
ANR055	UKP209	40	54	190	146	54	17	20	20	106	50	M14	32395	20235	UK209+H2309	P209	1.29
ANR056	UKP210	45	57.2	206	159	60	20	23	21	113	55	M16	33345	22135	UK210+H2310	P210	2.83
ANR057	UKP211	50	63.5	219	171	60	20	23	23	125	59	M16	41230	27930	UK211+H2311	P211	3.46
ANR058	UKP212	55	69.8	241	184	70	20	23	25	138	62	M16	49780	34390	UK212+H2312	P212	4.95
ANR059	UKP213	60	76.2	265	203	70	25	28	27	150	65	M20	54340	38095	UK213+H2313	P213	5.06
ANR060	UKP215	65	82.6	275	217	74	25	28	28	162	73	M20	64030	45885	UK215+H2315	P215	7.27
ANR061	UKP216	70	88.9	292	232	78	25	28	30	174	78	M20	69065	50350	UK216+H2316	P216	8.36
ANR062	UKP217	75	95.2	310	247	83	25	28	32	185	82	M20	79800	58805	UK217+H2317	P217	10.23
ANR063	UKP218	80	101.6	327	262	88	27	30	33	198	86	M22	91295	67925	UK218+H2318	P218	12.34

### Insert Bearing & Housing

- Bearing: P0 grade, GCr15 material
- Housing: HT-200 material

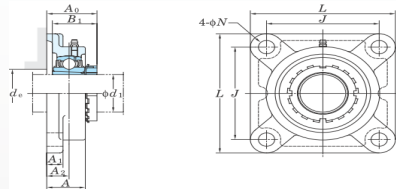

SAP Code	Type	Dimensions								Bolt mm	Load ratings(N)				Weight kg
		Ød1	L	J	A2	A1	A	4-ØN	A0		dyn. C	stat.C0	bearing+sleeve	housing	
ANR038	UKF205	20	95	70	16	14	27	12	35.5	M10	13300	7457	UK205+H2305	F205	0.85
ANR039	UKF206	25	108	83	18	14	31	12	39	M10	18525	10735	UK206+H2306	F206	1.16
ANR040	UKF207	30	117	92	19	16	34	14	42.5	M12	24415	14630	UK207+H2307	F207	1.55
ANR041	UKF208	35	130	102	21	16	36	16	46.5	M14	27645	16910	UK208+H2308	F208	1.94
ANR042	UKF209	40	137	105	22	18	38	16	48.5	M14	32395	20235	UK209+H2309	F209	2.3
ANR043	UKF210	45	143	111	22	18	40	16	50	M14	33345	22135	UK210+H2310	F210	2.59
ANR044	UKF211	50	162	130	25	20	43	19	54.5	M16	41230	27930	UK211+H2311	F211	3.46
ANR045	UKF212	55	175	143	29	20	48	19	61	M16	49780	34390	UK212+H2312	F212	4.33
ANR046	UKF213	60	187	149	30	22	50	19	64	M16	54340	38095	UK213+H2313	F213	4.9
ANR047	UKF215	65	200	159	34	22	56	19	71	M16	64030	45885	UK215+H2315	F215	7.02
ANR048	UKF216	70	208	165	34	22	58	23	73.5	M20	69065	50350	UK216+H2316	F216	7.76
ANR049	UKF217	75	220	175	36	24	63	23	77	M20	79800	58805	UK217+H2317	F217	10.08
ANR050	UKF218	80	235	187	40	24	68	23	81.5	M20	91295	67925	UK218+H2318	F218	12.44

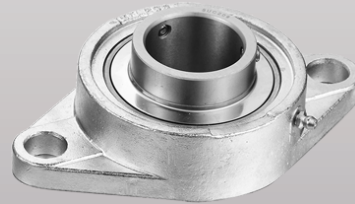
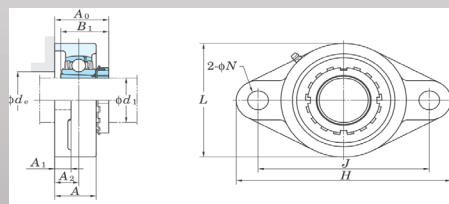

SAP Code	Type	Dimensions								Bolt mm	Load ratings (N)				Weight kg	
		Ød1	H	J	A2	A1	A	2-ØN	L		A0	dyn.C	stat.C0	bearing+sleeve		housing
ANR029	UKFL205	20	130	99	16	13	27	16	68	35,5	M14	13300	7457	UK205+H2305	FL205	0.63
ANR030	UKFL206	25	148	117	18	13	31	16	80	39	M14	18525	10735	UK206+H2306	FL206	0.9
ANR031	UKFL207	30	161	130	19	14	34	16	90	42,5	M14	24415	14630	UK207+H2307	FL207	1.17
ANR032	UKFL208	35	175	144	21	14	36	16	100	46,5	M14	27645	16910	UK208+H2308	FL208	1.54
ANR033	UKFL209	40	188	148	22	15	38	19	108	48,5	M16	32395	20235	UK209+H2309	FL209	1.89
ANR034	UKFL210	45	197	157	22	15	40	19	115	50	M16	33345	22135	UK210+H2310	FL210	2.27
ANR035	UKFL211	50	224	184	25	18	43	19	130	54,5	M16	41230	27930	UK211+H2311	FL211	3.06
ANR036	UKFL212	55	250	202	29	18	48	23	140	61	M20	49780	34390	UK212+H2312	FL212	3.79
ANR037	UKFL213	60	258	210	30	22	50	23	155	64	M20	54340	38095	UK213+H2313	FL213	4.48
ANR173	UKFL215	65	275	225	34	22	56	23	165	71	M20	64030	45885	UK215+H2315	FL215	5.48
*	UKFL216	70	290	233	34	22	58	25	180	73,5	M22	69065	50350	UK216+H2316	FL216	7.46
*	UKFL217	75	305	248	36	24	63	25	190	77	M22	79800	58805	UK217+H2317	FL217	9.03
ANR174	UKFL218	80	320	265	40	24	68	25	205	81,5	M22	91295	67925	UK218+H2318	FL218	10.89

### Insert Bearing & Housing

- Bearing: P0 grade, GCr15 material
- Housing: HT-200 material

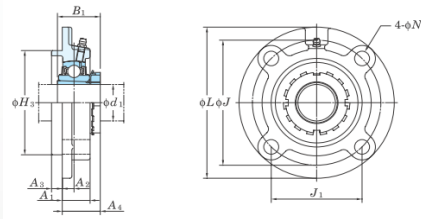

SAP Code	Type	Dimensions											Bolt mm	Load ratings(N)				Weight kg
		Ød1	ØL	ØJ	J1	A2	4-ØN	A3	A2	A1	ØH3	A4		dyn.	stat.	bearing+sleeve	housing	
ANR019	UKFC205	20	115	90	63.6	10	12	6	7	21	70	29.5	M10	13300	7457	UK205+H2305	FC205	1.05
ANR020	UKFC206	25	125	100	70.7	10	12	8	8	23	80	31	M10	18525	10735	UK206+H2306	FC206	1.34
ANR021	UKFC207	30	135	110	77.8	11	14	8	9	26	90	33.5	M12	24415	14630	UK207+H2307	FC207	1.9
ANR022	UKFC208	35	145	120	84.8	11	14	10	9	26	100	35.5	M12	27645	16910	UK208+H2308	FC208	2.24
ANR023	UKFC209	40	160	132	93.3	10	16	12	14	26	105	36	M14	32395	20235	UK209+H2309	PFC209	2.83
ANR024	UKFC210	45	165	138	97.6	10	16	12	14	28	110	37.5	M14	33345	22135	UK210+H2310	FC210	3.07
ANR025	UKFC211	50	185	150	106.1	13	19	12	15	31	125	41.5	M16	41230	27930	UK211+H2311	FC211	4.16
ANR026	UKFC212	55	195	160	113.1	17	19	12	15	36	135	48	M16	49780	34390	UK212+H2312	FC212	4.99
ANR027	UKFC213	60	205	170	120.2	16	19	14	15	36	145	49	M16	54340	38095	UK213+H2313	FC213	5.56
ANR028	UKFC215	65	220	184	130.1	18	19	16	18	40	160	53.5	M16	64030	45885	UK215+H2315	FC215	7.67
ANR070	UKFC216	70	240	200	141.4	18	23	16	18	42	170	57	M20	69065	50350	UK216+H2316	FC216	9.41
*	UKFC217	75	250	208	147.1	18	23	18	20	45	180	59	M20	79800	58805	UK217+H2317	FC217	11.23
ANR071	UKFC218	80	265	220	155.5	22	23	18	20	50	190	64.5	M20	91295	67925	UK218+H2318	FC218	13.34

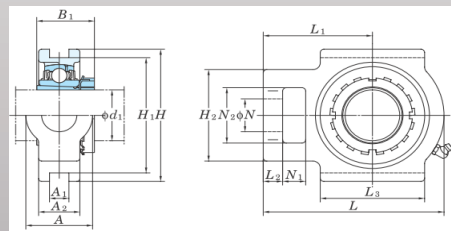

SAP Code	Type	Dimensions													Load ratings(N)				Weight kg
		Ød1	N1	L2	H2	N2	ØN	L3	A1	H1	H	L	A2	L1	dyn.C	stat.C	bearing+sleeve	housing	
ANR086	UKT205	20	16	10	51	32	19	51	12	76	89	97	24	62	13300	7457	UK205+H2305	T205	0.86
ANR087	UKT206	25	16	10	56	37	22	57	12	89	102	113	28	70	18525	10735	UK206+H2306	T206	1.26
ANR088	UKT207	30	16	13	64	37	22	64	12	89	102	129	30	78	24415	14630	UK207+H2307	T207	2.5
ANR089	UKT208	35	19	16	83	49	29	83	16	102	114	144	35	89	27645	16910	UK208+H2308	T208	2.5
ANR090	UKT209	40	19	16	83	49	29	83	16	102	117	144	35	87	32395	20235	UK209+H2309	T209	2.51
ANR091	UKT210	45	19	16	83	49	29	86	16	102	117	149	35	90	33345	22135	UK210+H2310	T210	2.6
ANR092	UKT211	50	25	19	102	64	35	95	22	130	146	171	41	106	41230	27930	UK211+H2311	T211	4.26
ANR093	UKT212	55	32	19	102	64	35	102	22	130	146	194	46	119	49780	34390	UK212+H2312	T212	5.02
ANR094	UKT213	60	32	21	111	70	41	121	26	151	167	224	51	137	54340	38095	UK213+H2313	T213	6.56
ANR095	UKT215	65	32	21	111	70	41	121	26	151	167	232	48	140	64030	45885	UK215+H2315	T215	7.52
ANR096	UKT216	70	32	21	111	70	41	121	26	165	184	235	51	140	69065	50350	UK216+H2316	T216	8.56
*	UKT217	75	38	29	124	73	48	157	30	173	198	260	54	162	79800	58805	UK217+H2317	T217	11.38

### Insert Bearing & Housing

- Bearing: P0 grade, GCr15 material
- Housing: HT-200 material

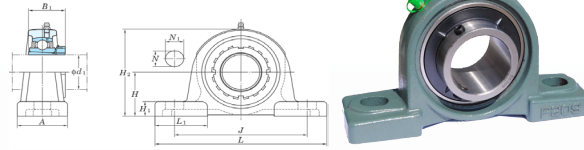

SAP Code	Type	Dimensions										Bolt mm	Load ratings (N)				Weight kg
		Ø d 1	H	L	J	A	N	N1	H1	H2	B1		dyn.C	stat.C0	bearing+sleeve	housing	
*	UKP305	20	45	175	132	45	17	20	15	85	35	M14	20140	10355	UK305+H2305	P305	1.7
*	UKP306	25	50	180	140	50	17	20	18	95	38	M14	25365	14250	UK306+H2306	P306	2.3
*	UKP307	30	56	210	160	56	17	25	20	106	43	M14	31730	18335	UK307+H2307	P307	3
*	UKP308	35	60	220	170	60	17	27	22	116	46	M16	38665	22800	UK308+H2308	P308	3.8
ANR064	UKP309	40	67	245	190	67	20	30	24	129	50	M16	46455	28025	UK309+H2309	P309	5
ANR065	UKP310	45	75	275	212	75	20	35	27	143	55	M16	58900	36385	UK310+H2310	P310	6.7
ANR066	UKP311	50	80	310	236	80	20	38	30	154	59	M16	68020	42750	UK311+H2311	P311	8.1
ANR067	UKP312	55	85	330	250	85	25	38	32	165	62	M20	77805	49590	UK312+H2312	P312	9.4
ANR068	UKP313	60	90	340	260	90	25	38	33	176	65	M20	88065	56905	UK313+H2313	P313	10.8
ANR069	UKP315	65	100	380	290	100	27	40	35	198	73	M22	107350	73340	UK315+H2315	P315	14.9
ANR082	UKP316	70	106	400	300	110	27	40	40	210	78	M22	116850	82365	UK316+H2316	P316	18.6
*	UKP317	75	112	420	320	110	33	45	40	220	82	M27	126350	91960	UK317+H2317	P317	20.2
ANR083	UKP318	80	118	430	330	110	33	45	45	235	86	M27	135850	101650	UK318+H2318	P318	22.8
ANR084	UKP319	85	125	470	360	120	36	50	45	250	90	M30	145350	113050	UK319+H2319	P319	29.3
ANR085	UKP320	90	140	490	380	120	36	50	50	275	97	M30	164350	133950	UK320+H2320	P320	34.8
*	UKP322	100	150	520	400	140	40	55	55	300	105	M33	194750	171000	UK322+H2322	P322	43.9
*	UKP324	110	160	570	450	140	40	55	65	320	112	M33	196650	175750	UK324+H2324	P324	55.7
*	UKP326	115	180	600	480	140	40	55	75	335	121	M33	217550	203300	UK326+H2326	P326	71.9
*	UKP328	125	200	620	500	140	40	55	75	390	131	M33	240350	233700	UK328+H2328	P328	92.5

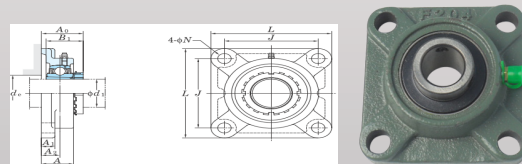

SAP Code	Type	Dimensions								Bolt mm	Load ratings(N)				Weight kg
		Ød1	L	J	A2	A1	A	4-ØN	A0		dyn. C	stat.C0	bearing+sleeve	housing	
*	UKF305	20	110	80	16	13	29	16	37	M14	20140	10355	UK305+H2305	F305	1.4
*	UKF306	25	125	95	18	15	32	16	40.5	M14	25365	14250	UK306+H2306	F306	1.9
*	UKF307	30	135	100	20	16	36	19	44.5	M16	31730	18335	UK307+H2307	F307	2.3
*	UKF308	35	150	112	23	17	40	19	50	M16	38665	22800	UK308+H2308	F308	3.1
ANR072	UKF309	40	160	125	25	18	44	19	54.5	M16	46455	28025	UK309+H2309	F309	4.1
ANR073	UKF310	45	175	132	28	19	48	23	60	M20	58900	36385	UK310+H2310	F310	5.1
ANR074	UKF311	50	185	140	30	20	52	23	63.5	M20	68020	42750	UK311+H2311	F311	5.9
ANR075	UKF312	55	195	150	33	22	56	23	69	M20	77805	49590	UK312+H2312	F312	6.8
ANR077	UKF315	65	236	184	39	25	66	25	81	M22	107350	73340	UK315+H2315	F315	11.7
ANR078	UKF316	70	250	196	38	27	68	31	83.5	M27	116850	82365	UK316+H2316	F316	12.9
ANR079	UKF317	75	260	204	44	27	74	31	92	M27	126350	91960	UK317+H2317	F317	15.2
ANR080	UKF318	80	280	216	44	30	76	35	93.5	M30	135850	101650	UK318+H2318	F318	19
*	UKF319	85	290	228	59	30	94	35	111	M30	145350	113050	UK319+H2319	F319	21.9
ANR081	UKF320	90	310	242	59	32	94	38	115	M33	164350	133950	UK320+H2320	F320	25.4
*	UKF322	100	340	266	60	35	96	41	121	M36	194750	171000	UK322+H2322	F322	35.2
*	UKF324	110	370	290	65	40	110	41	130	M36	196650	175750	UK324+H2324	F324	47.6
*	UKF326	115	410	320	65	45	115	41	134	M36	217550	203300	UK326+H2326	F326	65.3
*	UKF328	125	450	350	75	55	125	41	148	M36	240350	233700	UK328+H2328	F328	93.4

### Bearing units inserts 12-20 mm

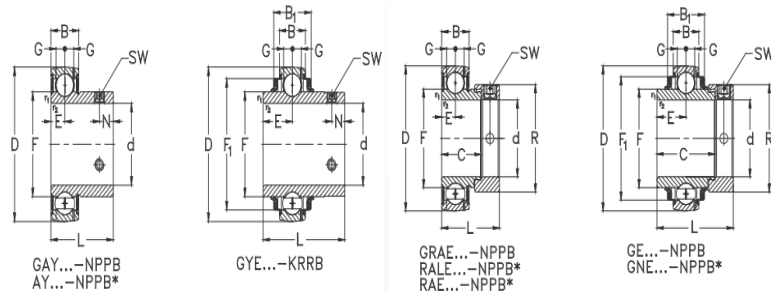

SAP Code	Boundary dimensions																	Weight
	$\varnothing d$	D	B	B1	C	insert bearing	E	F	F1	G	N	L	SW	Rmax	Cr	C0r	Cu	kg
*	12	40	12	--	19	GRAE12.NPPB	6.5	23	--	3.3	--	28.6	3	28	9.6	4.8	0.2	0.12
*		40	12	--	19	RAE12.NPPB	6.5	23	--	--	--	28.6	3	28	9.6	4.8	0.2	0.12
*		40	12	--	--	AY12.NPPB	6	23.9	--	--	4	22	2.5	--	9.6	4.8	0.2	0.1
*		40	12	--	--	GAY12.NPPB	6	23.9	--	3.3	4	22	2.5	--	9.6	4.8	0.2	0.1
*		40	12	16.6	--	GYE12.KRRB	11.5	23.9	31.6	3.3	4	27.4	2.5	--	9.6	4.8	0.2	0.11
*	15	40	12	--	19	GRAE15.NPPB	6.5	23	--	3.3	--	28.6	3	28	9.6	4.8	0.2	0.12
*		40	12	--	19	RAE15.NPPB	6.5	23	--	--	--	28.6	3	28	9.6	4.8	0.2	0.12
*		40	12	--	--	AY15.NPPB	6	23.9	--	--	4	22	2.5	--	9.6	4.8	0.2	0.09
*		40	12	--	--	GAY15.NPPB	6	23.9	--	3.3	4	22	2.5	--	9.6	4.8	0.2	0.09
*		40	12	16.6	--	GYE15.KRRB	11.5	23.9	31.6	3.3	4	27.4	2.5	--	9.6	4.8	0.2	0.1
*	16	40	12	16.6	--	GYE16.KRRB	11.5	23.9	31.6	3.3	4	27.4	2.5	--	9.6	4.8	0.2	0.1
ANT049	17	40	12	--	19	GRAE17.NPPB	6.5	23	--	3.3	--	37.3	3	28	9.6	4.8	0.2	0.12
*		40	12	--	19	RAE17.NPPB	6.5	23	--	--	--	28.6	3	28	9.6	4.8	0.2	0.12
*		40	12	16.6	19	GE17.KRRB	13.9	23.9	31.6	3.3	--	28.6	3	28	9.6	4.8	0.2	0.16
*		40	12	--	--	AY17.NPPB	6	23	--	--	4	22	2.5	--	9.6	4.8	0.2	0.08
*		40	12	--	--	GAY17.NPPB	6	23.9	--	3.3	4	22	2.5	--	9.6	4.8	0.2	0.08
*		40	12	16.6	--	GYE17.KRRB	11.5	23.9	31.6	3.3	4	27.4	2.5	--	9.6	4.8	0.2	0.09
ANT040	20	47	14	--	21.4	GRAE20.NPPB	7.5	26.9	--	3.7	--	31	3	33	12.8	6.7	0.3	0.16
*		47	14	--	21.4	RAE20.NPPB	7.5	26.9	--	--	--	31	3	33	12.8	6.7	0.3	0.16
ANT041		42	12	--	16.7	RALE20.NPPB	6	25.4	--	--	--	24.6	3	30	9.4	5	0.2	0.09
*		47	14	16.6	34.1	GE20.KRRB	17.1	27.6	37.4	3.7	--	43.7	2.5	33	12.8	6.7	0.3	0.2
*		47	14	--	--	AY20.NPPB	7	28.3	--	--	4.5	25	2.5	--	12.8	6.7	0.3	0.13
ANT042		42	12	--	16.7	RALE20.NPPB	6	25.4	--	--	--	25	3	30	9.4	5	0.2	0.09

### Bearing units inserts 20-35 mm

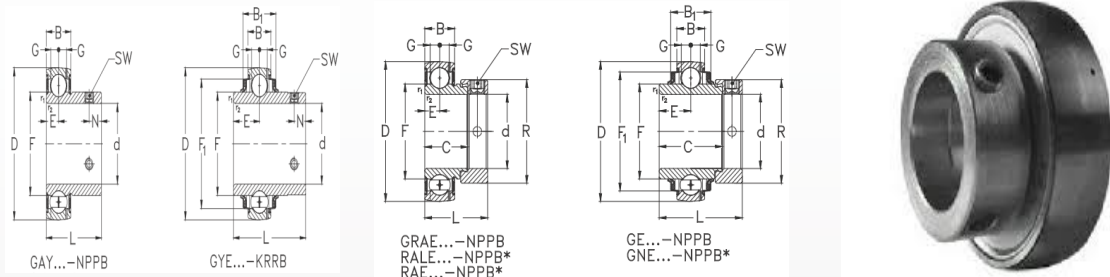

SAP Code	Boundary dimensions															Weight		
	$\varnothing d$	D	B	B1	C	insert bearing	E	F	F1	G	N	L	SW	Rmax	Cr	C0r	Cu	kg
ANT043	20	47	14	--	--	GAY20.NPPB	7	28.3	--	3.7	4.5	25	2.5	--	12.8	6.7	0.3	0.13
*		47	14	16.6	--	GYE20.KRRB	12.7	27.6	37.4	3.7	4.5	31	2.5		12.8	0.67	0.3	0.17
ANQ894	25	52	15	--	21.4	GRAE25.NPPB	7.5	30.5	--	3.9	--	31	3	37.5	14	7.9	0.4	0.19
*		52	15	--	21.4	RAE25.NPPB	7.5	30.5	--	--	--	4.5	31	2.5	--	12.8	6.7	0.3
*		47	12	--	17.5	RALE25.NPPB	6	30	--	--	--	25.4	3	36	10.1	5.9	0.3	0.12
ANT047		52	15	16.7	34.9	GE25.KRRB	17.5	33.8	42.5	3.9	--	44.4	2.5	37.5	14	7.9	0.4	0.25
*		52	15	--	--	AY25.NPPB	7.5	33.5	--	--	5	27	2.5	--	14	7.9	0.4	0.16
ANT044		52	15	--	--	GAY25.NPPB	7.5	33.5	--	3.9	5	27	2.5	--	14	7.9	0.4	0.16
*		52	15	16.7	--	GYE25.KRRB	14.3	33.8	42.5	3.9	5	34.1	2.5	--	14	7.9	0.4	0.2
ANQ895	30	62	18	--	23.8	GRAE30.NPPB	9	37.4	--	5	--	35.7	4	44	19.5	11.3	0.5	0.31
*		62	18	--	23.8	RAE30.NPPB	9	37.4	--	--	--	35.7	4	44	19.5	11.3	0.5	0.31
*		55	13	--	18.5	RALE30.NPPB	6.5	35.7	--	--	--	26.5	2.5	42.5	13.2	8.3	0.4	0.17
ANT048		62	18	20.7	36.5	GE30.KRRB	18.3	40.2	52	5	--	48.4	4	--	19.5	11.3	0.5	0.38
*		72	20	24	36.5	GNE30.KRRB	17.5	44	60.2	6.2	--	50	5	51	27	15.2	0.7	0.54
*		62	18	--	--	AY30.NPPB	19	39.4	--	--	5	30	3	--	19.5	11.3	0.5	0.25
ANT045		62	18	--	--	GAY30.NPPB	9	39.4	--	5	5	30	3	--	19.5	11.3	0.5	0.25
*		62	18	20.7	--	GYE30.KRRB	15.9	40.2	52	5	5	38.1	3	--	19.5	11.3	0.5	0.33
ANQ896	35	72	19	--	25.4	GRAE35.NPPB	9.5	44.6	--	5.7	--	38.9	5	51	25.7	15.3	0.7	0.48
*		72	19	--	25.4	RAE35.NPPB	9.5	44.6	--	--	--	38.9	5	51	25.7	15.3	0.7	0.48
*		72	19	22.5	37.7	GE35.KRRB	18.8	46.8	60.3	5.7	--	51.1	5	51	25.7	15.3	0.7	0.55
*		80	22	25	38.1	GNE35.KRRB	18.3	48	66.6	7	--	51.6	5	55	19.5	11.3	0.5	0.73
ANT046		72	19	--	--	GAY35.NPPB	9.5	46.9	--	5.7	6	35	3	--	25.7	15.3	0.7	0.39
ANQ897	40	80	21	--	30.2	GRAE40.NPPB	11	49.4	--	6.2	--	43.7	5	58	29.5	18.2	0.8	0.62
ANQ898	45	85	22	--	30.2	GRAE45.NPPB	11	54.5	--	6.4	--	43.7	5	63	31.7	20.7	0.9	0.69
ANR097	50	90	22	--	30.2	GRAE50.NPPB	11	59.4	--	6.9	--	43.7	5	69	35.1	23.2	1.1	0.77

### Bearing units inserts

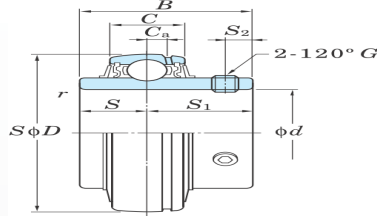

SAP Code	Type	Dimensions								Load ratings (N)		Weight kg
		Ø d	SØD	B	C	S	S1	S2	2-120°G	Dynamic	Static	
<b>UC 2XX series</b>												
*	UC201	12	47	31	17	12.7	18.3	4.8	M6x1	12160	6318	0.2
*	UC202	15	47	31	17	12.7	18.3	4.8	M6x1	12160	6318	0.19
*	UC203	17	47	31	17	12.7	18.3	4.8	M6x1	12160	6318	0.18
*	UC204	20	47	31	17	12.7	18.3	4.8	M6x1	12160	6318	0.16
*	UC205	25	52	34.1	17	14.3	19.8	5	M6x1	13300	7457	0.2
*	UC206	30	62	38.1	19	15.9	22.2	5	M6x1	18525	10735	0.32
*	UC207	35	72	42.9	20	17.5	25.4	7	M8x1	24415	14630	0.48
*	UC208	40	80	49.2	21	19	30.2	8	M8x1	27645	16910	0.64
*	UC209	45	85	49.2	22	19	30.2	8	M8x1	32395	20235	0.68
*	UC210	50	90	51.6	24	19	32.6	10	M10x1	33345	22135	0.8
*	UC211	55	100	55.6	25	22.2	33.4	10	M10x1	41230	27930	1.11
*	UC212	60	110	65.1	27	25.4	39.7	10	M10x1	49780	34390	1.54
*	UC213	65	120	65.1	28	25.4	39.7	10	M10x1	54340	38095	1.85
*	UC214	70	125	74.6	29	30.2	44.4	12	M12x1,5	59090	41895	2.05
*	UC215	75	130	77.8	30	33.3	44.5	12	M12x1,5	64030	45885	2.21
*	UC216	80	140	82.6	32	33.3	49.3	12	M12x1,5	69065	50350	2.8
*	UC217	85	150	85.7	34	34.1	51.6	12	M12x1,5	79800	58805	3.46
*	UC218	90	160	96	36	39.7	56.3	12	M12x1,5	91295	67925	4.36
<b>UC 3XX series</b>												
*	UC305	25	62	38	20	15	23	6	M6x1	20140	10355	0.35
ANQ882	UC306	30	72	43	23	17	26	6	M6x1	25365	14250	0.56
ANQ883	UC307	35	80	48	25	19	29	8	M8x1	31730	18335	0.71
ANQ884	UC308	40	90	52	27	19	33	10	M10x1	38665	22800	0.96
ANQ885	UC309	45	100	57	30	22	35	10	M10x1	46455	28025	1.28
ANQ886	UC310	50	110	61	32	22	39	12	M12x1,5	58900	36385	1.65
ANQ887	UC311	55	120	66	34	25	41	12	M12x1,5	68020	42750	2.07
ANQ888	UC312	60	130	71	36	26	45	12	M12x1,5	77805	49590	2.6
ANQ889	UC313	65	140	75	38	30	45	12	M12x1,5	88065	56905	3.25
ANQ890	UC314	70	150	78	40	33	45	12	M12x1,5	98800	64790	3.89
ANQ891	UC315	75	160	82	42	32	50	14	M14x1,5	107350	73340	4.72
ANQ892	UC316	80	170	86	44	34	52	14	M14x1,5	116850	82365	5.55
*	UC317	85	180	96	46	40	56	16	M16x1,5	126350	91960	6.67
ANQ893	UC318	90	190	96	48	40	56	16	M16x1,5	135850	101650	7.56
*	UC319	95	200	103	50	41	62	16	M16x1,5	145350	113050	8.7
*	UC320	100	215	108	55	42	66	18	M18x1,5	164350	133950	10.8
*	UC321	105	225	112	56	44	68	18	M18x1,5	174800	145350	12.2
*	UC322	110	240	117	60	46	71	18	M18x1,5	194750	171000	14.3
*	UC324	120	260	126	64	51	75	18	M18x1,5	196650	175750	18.5
*	UC326	130	280	135	68	54	81	20	M20x1,5	217550	203300	23
*	UC328	140	300	145	73	59	86	22	M20x1,5	240350	233700	28.5

### Adapter Sleeve

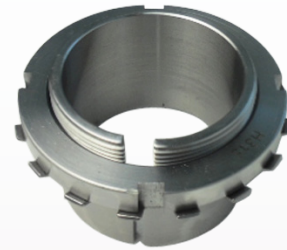
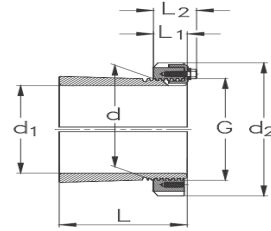
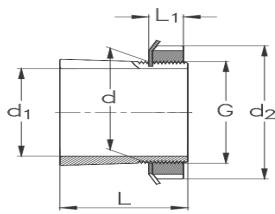

SAP Code	Type	Shaft Ø [mm]				Thread	L1	L2	G1	A	Lock nut	Locking dev.	Weight Kg
	Complete	D1	D	D2	L								
*	H204	17	20	32	24	M20X1	7	--	--	--	KM4	MB4	0.04
*	H304	17	20	32	28	M20X1	7	--	--	--	KM4	MB4	0.04
*	H2304	17	20	32	31	M20X1	7	--	--	--	KM4	MB4	0.05
ANR098	H205	20	25	38	26	M25X1,5	8	--	--	--	KM5	MB5	0.06
ANR135	H305	20	25	38	29	M25X1,5	8	--	--	--	KM5	MB5	0.07
ANR114	H2305	20	25	38	35	M25X1,5	8	--	--	--	KM5	MB5	0.09
ANR099	H206	25	30	45	27	M30X1,5	8	--	--	--	KM6	MB6	0.09
ANR136	H306	25	30	45	31	M30X1,5	8	--	--	--	KM6	MB6	0.1
ANR115	H2306	25	30	45	38	M30X1,5	8	--	--	--	KM6	MB6	0.11
ANR100	H207	30	35	52	29	M35X1,5	9	--	--	--	KM7	MB7	0.12
ANR137	H307	30	35	52	35	M35X1,5	9	--	--	--	KM7	MB7	0.14
ANR116	H2307	30	35	52	43	M35X1,5	9	--	--	--	KM7	MB7	0.15
ANR101	H208	35	40	58	31	M40X1,5	10	--	--	--	KM8	MB8	0.16
ANR138	H308	35	40	58	36	M40X1,5	10	--	--	--	KM8	MB8	0.18
ANR117	H2308	35	40	58	46	M40X1,5	10	--	--	--	KM8	MB8	0.22
ANR102	H209	40	45	65	33	M45X1,5	11	--	--	--	KM9	MB9	0.21
ANR139	H309	40	45	65	39	M45X1,5	11	--	--	--	KM9	MB9	0.23
ANR118	H2309	40	45	65	50	M45X1,5	11	--	--	--	KM9	MB9	0.27
ANR103	H210	45	50	70	35	M50X1,5	12	--	--	--	KM10	MB10	0.24
ANR140	H310	45	50	70	42	M50X1,5	12	--	--	--	KM10	MB10	0.27
ANR119	H2310	45	50	70	55	M50X1,5	12	--	--	--	KM10	MB10	0.34
ANR104	H211	50	55	75	37	M55X2	12.5	--	--	--	KM11	MB11	0.28
ANR141	H311	50	55	75	45	M55X2	12.5	--	--	--	KM11	MB11	0.32
ANR120	H2311	50	55	75	59	M55X2	12.5	--	--	--	KM11	MB11	0.39
ANR105	H212	55	60	80	38	M60X2	13	--	--	--	KM12	MB12	0.31
ANR142	H312	55	60	80	47	M60X2	13	--	--	--	KM12	MB12	0.35
ANR121	H2312	55	60	80	62	M60X2	13	--	--	--	KM12	MB12	0.45
ANR106	H213	60	65	85	40	M65X2	14	--	--	--	KM13	MB13	0.36
ANR146	H313	60	65	85	50	M65X2	14	--	--	--	KM13	MB13	0.42
ANR122	H2313	60	65	85	65	M65X2	14	--	--	--	KM13	MB13	0.52
*	H314	60	70	92	52	M70X2	14	--	--	--	KM14	MB14	0.68
*	H2314	60	70	92	68	M70X2	14	--	--	--	KM14	MB14	0.88
ANR107	H215	65	75	98	43	M75X2	15	--	--	--	KM15	MB15	0.66
ANR149	H315	65	75	98	55	M75X2	15	--	--	--	KM15	MB15	0.78
ANR123	H2315	65	75	98	73	M75X2	15	--	--	--	KM15	MB15	1.1
ANR108	H216	70	80	105	46	M80X2	17	--	--	--	KM16	MB16	0.81
ANR150	H316	70	80	105	59	M80X2	17	--	--	--	KM16	MB16	0.95

### Adapter Sleeve

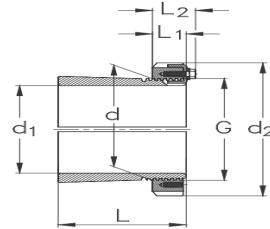
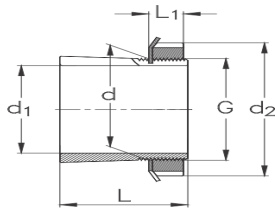

SAP Code	Type	Shaft Ø [mm]				Thread	L1	L2	G1	A	Lock nut	Locking dev.	Weight Kg
	Complete	D1	D	D2	L								
ANR124	H2316	70	80	105	78	M80X2	17	--	--	--	KM16	MB16	1.2
ANR109	H217	75	85	110	50	M85X2	18	--	--	--	KM17	MB17	0.94
ANR151	H317	75	85	110	63	M85X2	18	--	--	--	KM17	MB17	1.1
ANR125	H2317	75	85	110	82	M85X2	18	--	--	--	KM17	MB17	1.35
ANR110	H218	80	90	120	52	M90X2	18	--	--	--	KM18	MB18	1.1
ANR152	H318	80	90	120	65	M90X2	18	--	--	--	KM18	MB18	1.3
ANR126	H2318	80	90	120	86	M90X2	18	--	--	--	KM18	MB18	1.6
ANR111	H219	85	95	125	55	M95X2	19	--	--	--	KM19	MB19	1.25
ANR153	H319	85	95	125	68	M95X2	19	--	--	--	KM19	MB19	1.4
ANR127	H2319	85	95	125	90	M95X2	19	--	--	--	KM19	MB19	1.8
ANR112	H220	90	100	130	58	M100X2	20	--	--	--	KM20	MB20	1.4
ANR154	H320	90	100	130	71	M100X2	20	--	--	--	KM20	MB20	1.6
ANR128	H2320	90	100	130	97	M100X2	20	--	--	--	KM20	MB20	2
*	H3120	90	100	130	76	M100X2	20	--	--	--	KM20	MB20	1.8
*	H221	95	105	140	60	M105X2	20	--	--	--	KM21	MB21	1.6
*	H321	95	105	140	74	M105X2	20	--	--	--	KM21	MB21	1.85
ANR113	H222	100	110	145	63	M110X2	21	--	--	--	KM22	MB22	1.8
ANR155	H322	100	110	145	77	M110X2	21	--	--	--	KM22	MB22	2.05
ANR129	H2322	100	110	145	105	M110X2	21	--	--	--	KM22	MB22	2.75
*	H3122	100	110	145	81	M110X2	31	--	--	--	KM22	MB22	2.1
ANR130	H2324	110	120	155	112	M120X2	22	--	--	--	KM24	MB24	3
*	H3024	110	120	145	72	M120X2	22	--	--	--	KML24	MBL24	1.8
ANR143	H3124	110	120	155	88	M120X2	22	--	--	--	KM24	MB24	2.5
ANR131	H2326	115	130	165	121	M130X2	23	--	--	--	KM26	MB26	4.45
*	H3026	115	130	155	80	M130X2	23	--	--	--	KML26	MBL26	2.8
ANR144	H3126	115	130	165	92	M130X2	23	--	--	--	KM26	MB26	3.45
ANR132	H2328	125	140	180	131	M140X2	24	--	--	--	KM28	MB28	5.4
*	H3028	125	140	165	82	M140X2	24	--	--	--	KML28	MBL28	3.05
ANR145	H3128	125	140	180	97	M140X2	24	--	--	--	KM28	MB28	4.1