

**W-Series
WDU 10 BL**

Weidmüller Interface GmbH & Co. KG
Klingenbergstraße 16
D-32758 Detmold
Germany
Fon: +49 5231 14-0
Fax: +49 5231 14-292083
www.weidmueller.com

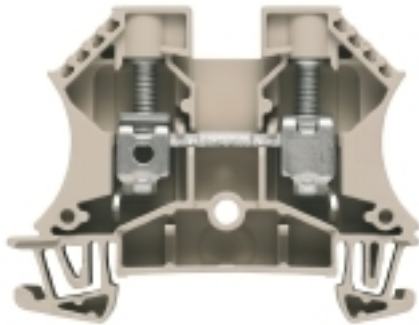

The versatile and extensive range of products - from 0.05 mm² to 300 mm² - means that you have diverse options for your applications at your disposal.
Hardened steel for mechanical strength and high-quality tinned copper for optimum conductivity. All materials comply with RoHS requirements and have been tested to current environment guidelines.

General ordering data

| | |
|------------|---|
| Type | WDU 10 BL |
| Order No. | 1020380000 |
| Version | W-Series, Feed-through terminal, Rated cross-section: 10 mm ² , Screw connection |
| GTIN (EAN) | 4008190166359 |
| Qty. | 50 pc(s). |

W-Series WDU 10 BL

Weidmüller Interface GmbH & Co. KG
 Klingenbergstraße 16
 D-32758 Detmold
 Germany
 Fon: +49 5231 14-0
 Fax: +49 5231 14-292083
 www.weidmueller.com

Technical data

Dimensions and weights

| | | | |
|--------------------------|---------|------------|---------|
| Width | 9.9 mm | Height | 60 mm |
| Height of lowest version | 47 mm | Depth | 46.5 mm |
| Weight | 19.16 g | Net weight | 17.06 g |

Temperatures

| | | | |
|----------------------------------|--------|----------------------------------|--------|
| Continuous operating temp., min. | -50 °C | Continuous operating temp., max. | 120 °C |
|----------------------------------|--------|----------------------------------|--------|

Rated data IECEx/ATEX

| | | | |
|--------------------------------|---|---------------------------|--------------------------|
| Certificate No. (ATEX) | KEMA98ATEX1683U | ATEX certificate | KEMA98ATEX1683U_d.pdf |
| ATEX certificate | KEMA98ATEX1683U_e.pdf | IEC Ex certificate | IECExULDO5.0008U_e.pdf |
| Max. voltage (ATEX) | 690 V | Current (ATEX) | 50 A |
| Wire cross section max. (ATEX) | 10 mm ² | Voltage, cross-connection | CrossConnectionGuide.pdf |
| Operating temperature range | For operating temperature range see EC Design Test Certificate / IEC Ex-Certificate of Conformity | Marking EN 60079-7 | |
| Marking ATEX Directive 94/9/EC | II 2 G D | | Ex e II |

2 clampable wires (H05V/H07V) same cross-section (rated connection)

| | | | |
|--|---------------------|--|-------------------|
| Cross-section for connected wire, stranded, two clampable wires, min. | 0.5 mm ² | Cross-section for connected wire, stranded, two clampable wires, max. | 6 mm ² |
| Wire connection cross section, finely stranded, two clampable wires, min. | 0.5 mm ² | Wire cross-section, finely stranded, two clampable wires, max. | 6 mm ² |
| Wire connection cross section, finely stranded with wire-end ferrules DIN 46228/1, 2 clampable wires, min. | 0.5 mm ² | Wire connection cross section, finely stranded with wire-end ferrules DIN 46228/1, 2 clampable wires, max. | 6 mm ² |

Additional technical data

| | | | |
|--------------------------|---|-----------------------------|---------|
| Explosion-tested version | Yes | Number of similar terminals | 1 |
| Open sides | right | Type of mounting | Snap-on |
| Version | Screw connection, for screwable cross-connection, One end without connector | | |

CSA ratings data

| | | | |
|-------------------------------|----------------|-------------------------------|-------|
| Certificate No. (CSA) | 200039-1057876 | Voltage size C (CSA) | 600 V |
| Current size C (CSA) | 65 A | Wire cross section max. (CSA) | 6 AWG |
| Wire cross section min. (CSA) | 18 AWG | | |

W-Series
WDU 10 BL

Weidmüller Interface GmbH & Co. KG
 Klingenbergstraße 16
 D-32758 Detmold
 Germany
 Fon: +49 5231 14-0
 Fax: +49 5231 14-292083
 www.weidmueller.com

Technical data**Clampable wires (rated connection)**

| | | | |
|---|---------------------|---|----------------------|
| Type of connection | Screw connection | Stripping length | 12 mm |
| Blade size | 1.0 x 5.5 mm | Connection direction | on side |
| Number of connections | 2 | Clamping range, rated connection, min. | 1.31 mm ² |
| Clamping range, rated connection, max. | 16 mm ² | Clamping screw | M 4 |
| Tightening torque, min. | 1.2 Nm | Tightening torque, max. | 1.9 Nm |
| Torque level with DMS electric screwdriver | 4 | Gauge to IEC 60947-1 | B6 |
| Wire connection cross section, solid core, min. rated connection | 1.5 mm ² | Wire connection cross section, solid core max. rated connection | 16 mm ² |
| Wire connection cross section, stranded, rated connection, max. | 16 mm ² | Wire connection cross section, finely stranded, max. | 16 mm ² |
| Wire connection cross-section, finely stranded, min. | 1.5 mm ² | Wire connection cross section, finely stranded with wire-end ferrules DIN 46228/1, rated connection, min. | 1.5 mm ² |
| Wire connection cross section, finely stranded with wire-end ferrules DIN 46228/1, rated connection, max. | 16 mm ² | Cross-section for connected conductor, finely stranded with wire-end ferrules and plastic collars DIN 46228/4, rated connection, min. | 1.5 mm ² |
| Wire connection cross-section, finely stranded with wire-end ferrules and plastic collars DIN 46228/4, rated connection, max. | 16 mm ² | Twin wire-end ferrules, min. | 1.5 mm ² |
| Twin wire-end ferrules, max. | 6 mm ² | Wire connection cross section AWG, min. | AWG 16 |
| Wire connection cross section AWG, max. | AWG 6 | | |

Rated data

| | | | |
|---------------------------------|--------------------|---------------|---------------|
| Rated cross-section | 10 mm ² | Rated voltage | 1,000 V |
| Rated impulse withstand voltage | 8 kV | Rated current | 57 A |
| Current at maximum wires | 76 A | Standards | IEC 60947-7-1 |
| Pollution severity | 3 | | |

UL ratings data

| | | | |
|---|--------|---|-------|
| Certificate No. (UR) | E60693 | Voltage size C (UR) | 600 V |
| Current size C (UR) | 65 A | Conductor size Factory wiring max. (UR) | 6 AWG |
| Conductor size Factory wiring min. (UR) | 18 AWG | Conductor size Field wiring max. (UR) | 6 AWG |

Material data

| | | | |
|---------------------------|-------|--------|------|
| Material | Wemid | Colour | Blue |
| UL 94 flammability rating | V-0 | | |

System specifications

| | | | |
|--------------------------------|----------|-----------------------------------|------------------|
| Product family | W-Series | Type of connection | Screw connection |
| Connection direction | on side | Number of levels | 1 |
| Number of connections | 2 | No. of clamping points per level | 2 |
| Number of potentials per level | 1 | Levels cross-connected internally | No |
| Mounting rail | TS 35 | End cover plate required | No |

Data sheet

**W-Series
WDU 10 BL**

Weidmüller Interface GmbH & Co. KG
 Klingenbergstraße 16
 D-32758 Detmold
 Germany
 Fon: +49 5231 14-0
 Fax: +49 5231 14-292083
 www.weidmueller.com

Technical data

Classifications

| | | | |
|------------|-------------|------------|-------------|
| ETIM 3.0 | EC000897 | UNSPSC | 30-21-18-11 |
| eClass 5.1 | 27-14-11-20 | eClass 6.2 | 27-14-11-20 |
| eClass 7.1 | 27-14-11-20 | | |

Product information

| | |
|---------------------------------|--|
| Descriptive text ordering data | 1000 VDC rated voltage tested. For alternative colours, see section on W-series accessories – specific functions. |
| Descriptive text technical data | Note max. current of terminal (76 A) when using WQV! Tighten AWG 6/7 and H07V-R16 to 2.4 Nm. |
| Descriptive text accessories | Socket and test plug refer to W-series Accessories section Only 400 V when using the shielding rail LS 2.8 1056400000. |

Approvals

Approvals



ROHS

Conform

Data sheet

W-Series
WDU 10 BL

Weidmüller Interface GmbH & Co. KG
Klingenbergstraße 16
D-32758 Detmold
Germany
Fon: +49 5231 14-0
Fax: +49 5231 14-292083
www.weidmueller.com

Drawings

