

# RBT



# Riser Break-out Tool



- ◆ For use in FTTH –MDU (Multiple Dwelling Units) as well as other riser cable applications
- ◆ Preparation tool especially designed to shave a break-out window in riser cable with no fiber damage and allowing individual fiber extraction
- ◆ Tool is compact and lightweight yet incorporating rugged aluminum body design
- ◆ Allows easy and fast access to closely spaced riser cables especially in small confined areas
- ◆ Compact and thin profile tool design allows for ease of use when riser cable is surface mounted, without the need for separating it from the mounting surface
- ◆ Shaves a longitudinal break-out window in 8.5 mm, 10.5 mm and 14 mm O.D. riser cables without any time consuming tool adjustment
- ◆ Factory fixed shaving blade made of high carbon steel and is safely recessed away from installer's hand to minimize exposure
- ◆ Applicable cables listed in the following table - please contact us for other cables

Cable Manufacturer	Cable
Prysmian	Verticasa®
Àcome	PACe
Draka	ezBREAKOUT™
Silec	Indoor µSheath® MS

- ◆ Tool Dimensions: 4 in x 1.5 in x 5/8 in h (100 mm x 38 mm x17 mm h)
- ◆ Weight: 3.68oz (105g)
- ◆ Replacement Blade: Part No: 81320 includes 10 blades, two spare mounting screws and washers
- ◆ Part No.: 81315

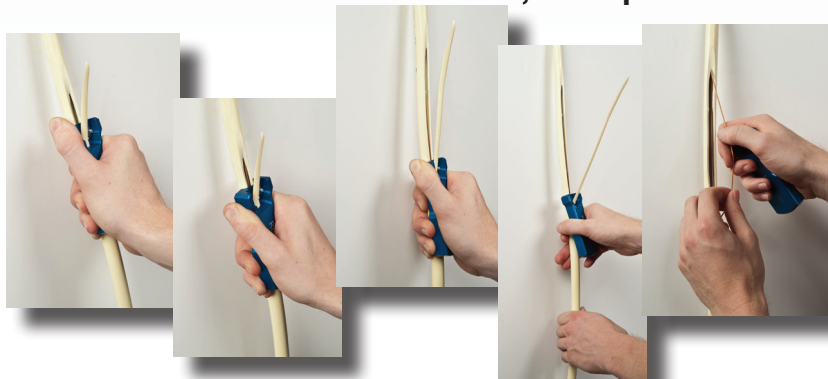

[www.ripley-tools.com](http://www.ripley-tools.com)

1-860-635-2200

Toll Free continental U.S.A.: 800-528-8665

Please view our video on YouTube

<http://www.youtube.com/watch?v=kW01L-Ti6MQ>

Please view our video on our web site

<http://ripley-tools.com/video/Miller/RBT.mpg>

