

Thermowells

Solid Machined, Weld-in Type

Thermometers

Form 4 per DIN 43 772 • Model SD400S

Application

The thermowells model SD400G are welded into the process. They are suitable for high process loads, that might occur as a result of flow, temperature and process pressure influences or vibrations.

Standard features

Thermowell material

Stainless steel 1.4571

Steel 1.0460, 1.5415, 1.7335, 1.7380

Thermowell outer diameter ¹⁾

Ø 18 mm, Ø 24 mm, Ø 26 mm, Ø 32 mm

Instrument connection ¹⁾

Female thread M14 x 1.5, M18 x 1.5, G ½ or G ¾

Bore size ¹⁾

Ø 3.5 mm, Ø 7 mm, Ø 9 mm, Ø 11 mm

Insertion length ¹⁾ U

65, 73, 125, 133 or 275 mm

Total length ¹⁾ L

110, 140, 170, 200, 260 or 410 mm

Maximum process temperature ²⁾

600 °C

Maximum process pressure (static) ²⁾

150 bar



Optional extras

- Other dimensions and materials
- Quality certificates
- Extension neck as accessory

1) Possible combinations of these features see overleaf

2) Ratings depends on below parameters:
- Process medium
- Process pressure and temperature
- Flow rate
- Design of thermowell (dimensions, material)
Load diagrams see DIN 43 772

Dimensions

without
extension
neck

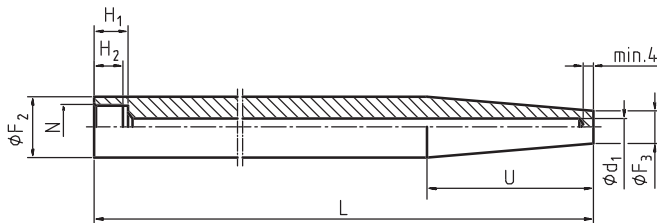

3088 944.01

with
extension
neck

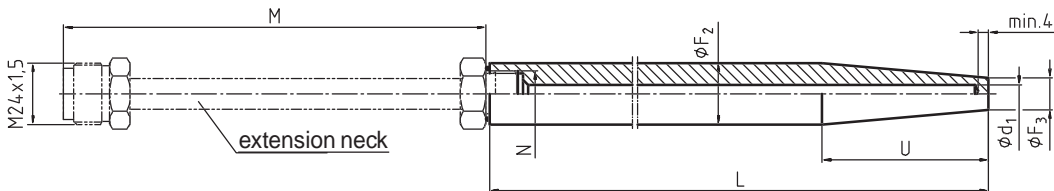

Legend:

- H_1 Bore depth for female thread
- H_2 Length of female thread
- L Total length
- M Extension neck length
- N Instrument connection
- U Insertion length
- ϕd_1 Bore size
- ϕF_2 Thermowell outer diameter
- ϕF_3 Tip diameter of thermowell

Dimensions in mm		Weight in kg ¹⁾
L	U	
110	65	0.240
	73	0.230
140	65	0.340
170	133	0.340
200	65	0.540
	125	0.450
260	125	0.650
410 ²⁾	275	0.920

Dimensions in mm					
N	ϕd_1	ϕF_2	ϕF_3	H_1	H_2
M14 x 1.5	3.5	18	9	16	13
M18 x 1.5	7	24	12.5		
G 1/2	9	26	15	19	15
	11		32	17	22

Suitable stem lengths of mechanical thermometers

Dial thermometers

Design of connection	Stem length l_1 if assembled	
	without extension neck	with extension neck
S/4/5	$l_1 = L - 10 \text{ mm}$	–
2	$l_1 = L - 30 \text{ mm}$	–
3	–	$l_1 = L - 10 \text{ mm} + M$ ³⁾

Machine glass thermometers

Design of connection	Stem length l_1 if assembled	
	without extension neck	with extension neck
E	$l_1 = L - 10 \text{ mm}$	–
3	–	$l_1 = L - 10 \text{ mm} + M$ ³⁾

1) Designs with N = M18 x 1.5 $\phi d_1 = 7 \text{ mm}$ $\phi F_2 = 24 \text{ mm}$

2) Not with bore size $\phi d_1 = 3.5 \text{ mm}$

3) Standard of extension neck length M = 165 mm

Ordering information

State: Model / Material / Thermowell outer diameter / Instrument connection / Bore size / Total length L / Insertion length U /
Optional extras required

Specifications and dimensions given in this leaflet are correct at the time of printing.
Modifications may take place and materials specified may be replaced by others without prior notice.



WIKAI Alexander Wiegand GmbH & Co. KG
Alexander-Wiegand-Straße · 63911 Klingenberg
☎ (0 9372) 132-0 · ☎ (0 9372) 132-406/414
http://www.wika.de · E-mail: info@wika.de