

P130429



Thorsman MULTI-MONTI MMS Concrete screws .....	Page 2
Thorsman TEL and TEL-C5M Universal screws .....	Page 5
Thorsman TGS Universal screws .....	Page 6
Thorsman TGE Self-tapping screws .....	Page 7
Thorsman TSE Self-tapping screws .....	Page 7
Thorsman TSS Self-tapping screws .....	Page 8
Thorsman TSB Self-tapping collar screws .....	Page 8
Thorsman TST Collar screws .....	Page 9
Thorsman TSC and TSC-C5M Installation screws .....	Page 10
Thorsman TSF Installation screws .....	Page 11
Thorsman TSI Installation screws .....	Page 11
Thorsman TMP-C3 Installation screws .....	Page 12
Thorsman TFT Installation screw with cup washer .....	Page 12
Thorsman MRX Metric screws .....	Page 13
Thorsman TEX Through bolts .....	Page 14
Thorsman TSA Wedge steel anchors .....	Page 17
Thorsman TMA Wedge brass anchors .....	Page 18
Thorsman SEVENHOOK™ SVH Universal anchors .....	Page 19



#### Description

The Thorsman range of concrete screws includes hardened steel screws for direct installation in hammer drilled holes in solid, hard materials like concrete and solid bricks. The concrete screws can be used in indoor or outdoor applications.

For outdoor applications, electroplated Protect 4 screws (C4) are specially suitable. Acid-proof stainless steel screws (C5M) are available for extreme environments.

The range also includes a mounting tool for the eye screw, magnetic socket drivers for hexagon head screws and a screw bit T30.

#### Application

Suitable for assembly of wall trunking and cable ladder brackets in concrete and solid bricks. Used directly without plastic plug.

#### Benefits

- Low stress induction allows installation close to concrete or brick edge.
- Captive fixing.
- Corrosion resistant.
- Fast installation.
- Removable.
- Different head types for different applications.

#### Technical and material data

Material	Hardened steel, electroplated. Also available in Protect 4 C4 and acid-proof stainless steel C5M.
Standards	ETA 05/0010, ETA 05/0011, DIBt no. Z-21.1-1503.

#### Installation

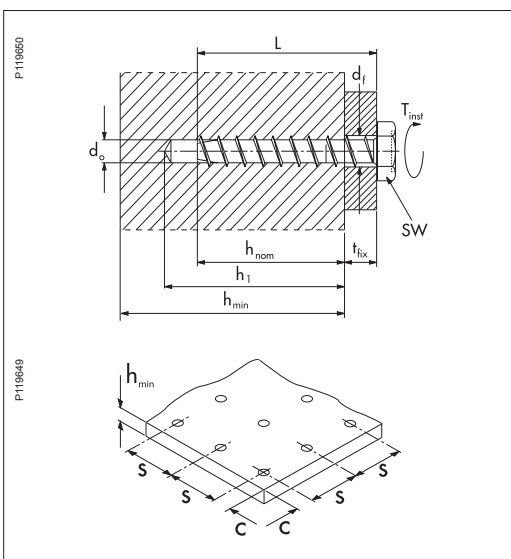
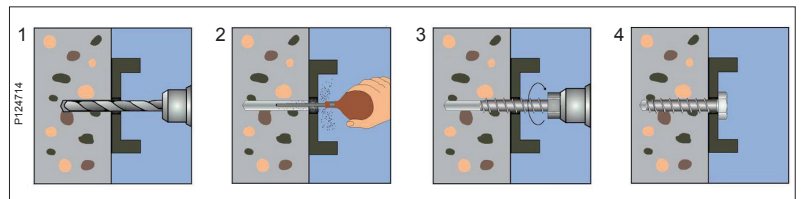

#### Technical information









		L	t <sub>fix</sub>	SW	d <sub>f</sub>	h <sub>1</sub>	Ø d <sub>o</sub>	h <sub>nom</sub>	T <sub>inst</sub>
		mm	mm	mm	mm	mm	mm	mm	Nm
MMS-P 5x30	⊙	30	1	T25	6	35	4	30	8
MMS-P 5x50		50	15	T25	6	40	4	35	8
MMS-P 6x30	⊙	30	1	T30	7	35	5	30	12
MMS-P 7.5x45 <sup>1)</sup>		45	1	13	9	55	6	45	20
MMS-MS 7.5x45 <sup>1)</sup>	⊙	45	1	13	9	55	6	45	20
MMS-S 6x40		40	5	10	7	45	5	35	12
MMS-S 6x50 <sup>1)</sup>	⊙	50	5	10	7	55	5	45	12
MMS-S 6x60 <sup>1)</sup>		60	15	10	7	55	5	45	12
MMS-S 7.5x35	⊙	35	1	13	9	40	6	35	20
MMS-S 7.5x40		40	5	13	9	45	6	35	20
MMS-S 7.5x50 <sup>1)</sup>	⊙	50	5	13	9	55	6	45	20
MMS-S 10x60 <sup>1)</sup>		60	5	16	12	65	8	55	50
MMS-S 7.5x50/65 <sup>3)</sup>	⊙	50	5	13	9	70	6	45	20
MMS-S 10x70/85 <sup>2)</sup>		70	5	16	12	75	8	65	50
MMS-MF 6x40	⊙	40	5	10	7	45	5	35	12
MMS-MF 6x50 <sup>1)</sup>		50	5	10	7	55	5	45	12
MMS-MF 6x60 <sup>1)</sup>	⊙	60	15	10	7	55	5	45	12
MMS-MF 7.5x50 <sup>1)</sup>		50	5	13	9	55	6	45	20
MMS-MF 7.5x70 <sup>2)</sup>	70	5	13	9	75	6	65	20	
MMS-R 6x40	⊙	40	5	-	7	50	5	40	12
MMS-I 7.5x60 <sup>2)</sup>	⊙	60	5	13	9	65	6	55	20

<sup>1)</sup> DIBt Zulassung Nr. Z-21.1-1503





<sup>2)</sup> ETA 05/0010

<sup>3)</sup> Acid-proof stainless steel A4





## Range Screws

Type	Dimensions Øxlength (mm)	Qty per package	EAN code	Internal ID-No.	Ref. No.		
<b>With pan head</b>							
Concrete screw with pan head. Recess T-20, T-30 or T-40. Suitable for concrete and solid brick materials. Mounting with cordless screwdriver or wrench. Material: Steel, electroplated.							
P11752		MMS-P Recess T-20	5x30	200	3606480214509	20062416	IMT38040
		MMS-P Recess T-20	5x50	200	3606480214516	20062417	IMT38041
		MMS-P Recess T-30	6x30	100	3606480214431	20062409	IMT38033
		MMS-P Recess T-40	7.5x45	100	3606480214448	20062410	IMT38034
<b>With flange head</b>							
Concrete screw with flange head 17 mm. Recess T-30. Suitable for concrete and solid brick materials. Mounting with cordless screwdriver or wrench. Material: Steel, electroplated.							
P11754		MMS-MS	7.5x45	50	3606480214479	20062413	IMT38037
<b>With hexagon head</b>							
Concrete screw with hexagon head. Suitable for concrete and solid brick materials. Mounting with cordless screwdriver or wrench. Material: Steel, electroplated.							
P11757		MMS-S Wrench width 13 mm	7.5x35	100	3606480214370	20062403	IMT38027
		MMS-S Wrench width 16 mm	10x60	50	3606480214400	20062406	IMT38030
<b>With hexagon head, washer enclosed</b>							
Concrete screw with hexagon head. Washer 7x16x1.5 enclosed. Wrench width 10 mm. Suitable for concrete and solid brick materials. Mounting with cordless screwdriver or wrench. Material: Steel, electroplated.							
P11757		MMS-S	6x40	100	3606480214523	20062418	IMT38042
		MMS-S	6x50	100	3606480214486	20062414	IMT38038
		MMS-S	6x60	100	3606480214493	20062415	IMT38039
<b>With hexagon head, washer enclosed</b>							
Concrete screw with hexagon head. Washer 8x19x1.5 enclosed. Wrench width 13 mm. Suitable for concrete and solid brick materials. Mounting with cordless screwdriver or wrench. Material: Steel, electroplated.							
P11757		MMS-S	7.5x40	100	3606480214387	20062404	IMT38028
		MMS-S	7.5x50	50	3606480214394	20062405	IMT38029
<b>With hexagon head, C4</b>							
Concrete screw with hexagon head. Wrench width 16 mm. Suitable for concrete and solid brick materials. Mounting with cordless screwdriver or wrench. Corrosivity class C4. Material: Steel, electroplated Protect 4.							
P11757		MMS-S	10x60	50	3606480214530	20062419	IMT38043
<b>With hexagon head, C5M</b>							
Concrete screw with hexagon head. Wrench width 16 mm. Suitable for concrete and solid brick materials. Mounting with cordless screwdriver or wrench. Corrosivity class C5M. Material: Stainless steel AISI316, phosphated steel (function tip).							
P11755		MMS-S	10x70/85	25	3606480214424	20062408	IMT38032
<b>With hexagon head, washer enclosed, C5M</b>							
Concrete screw with hexagon head. Washer 8.5x24x2 enclosed. Wrench width 13 mm. Suitable for concrete and solid brick materials. Mounting with cordless screwdriver or wrench. Corrosivity class C5M. Material: Stainless steel AISI316, phosphated steel (function tip).							
P11755		MMS-S	7.5x50/65	50	3606480214417	20062407	IMT38031
<b>With hexagon head and combined washer</b>							
Concrete screw with hexagon head and combined washer. Wrench width 8 mm. Suitable for concrete and solid brick materials. Mounting with cordless screwdriver or wrench. Material: Steel, electroplated.							
P11751		MMS-MF	6x40	100	3606480214578	20062423	IMT38047
		MMS-MF	6x50	100	3606480214585	20062424	IMT38048
		MMS-MF	6x60	50	3606480214592	20062425	IMT38049

#### Range screws

Type	Dimensions Øxlength (mm)	Qty per package	EAN code	Internal ID-No.	Ref. No.	
<b>With hexagon head and combined washer</b>						
Concrete screw with hexagon head and combined washer. Wrench width 10 mm. Suitable for concrete and solid brick materials. Mounting with cordless screwdriver or wrench. Material: Steel, electroplated.						
P117751 	MMS-MF	7.5x50	50	3606480214608	20062426	IMT38050
	MMS-MF	7.5x70	50	3606480214615	20062427	IMT38051
<b>With hexagon head and combined washer, C4</b>						
Concrete screw with hexagon head and combined washer. Wrench width 8 mm. Suitable for concrete and solid brick materials. Mounting with cordless screwdriver or wrench. Corrosivity class C4. Material: Steel, electroplated Protect 4.						
P117751 	MMS-MF	6x40	100	3606480214547	20062420	IMT38044
	MMS-MF	6x60	50	3606480214554	20062421	IMT38045
<b>With hexagon head and combined washer, C4</b>						
Concrete screw with hexagon head and combined washer. Wrench width 10 mm. Suitable for concrete and solid brick materials. Mounting with cordless screwdriver or wrench. Corrosivity class C4. Material: Steel, electroplated Protect 4.						
P117751 	MMS-MF	7.5x50	50	3606480214561	20062422	IMT38046
<b>Eye screw</b>						
Concrete eye screw. Suitable for concrete and solid brick materials. Mounting with cordless screwdriver or wrench. Material: Steel, electroplated.						
P117756 	MMS-R	6x40	100	3606480214462	20062412	IMT38036
<b>With hexagon head</b>						
Concrete screw with hexagon head and internal metric thread. Combined internal thread M8/M10. Wrench width 13 mm. Suitable for concrete and solid brick materials. Mounting with cordless screwdriver or wrench. Material: Steel, electroplated.						
P117753 	MMS-I	7.5x60	25	3606480214455	20062411	IMT38035

#### Range tool, sockets and bits

<b>Mounting tool</b>						
Mounting tool for concrete eye screw MMS-R. Material: Steel, electroplated.						
P117760 	Mounting tool	16x40	1	3606480214622	20062428	IMT38052
<b>Magnetic socket drivers</b>						
Mounting tool with magnet for hexagon head screws. Material: Steel.						
P117761 	10x45 for 10 mm screws	10x45	1	3606480214639	20062429	IMT38053
P117759 	13x55 for 13 mm screws	13x45	1	3606480214646	20062430	IMT38054
<b>Screw bit</b>						
Screw bit T30, for use with an extension socket. Material: Steel.						
P117758 	T30 Bits x25	6.25x25	2	3606480214653	20062431	IMT38055

#### Max. recommended loads for MULTI-MONTI Screw-In-Anchors in concrete and masonry

Anchor size	MMS-5			MMS-6			MMS-7.5			MMS-10		
<b>Max. recommended tension load of a single anchor without edge influence</b>												
Cracked concrete C 20/25	kN	no	1.8	no	1.7	2.7	no	2.6	3.8	3.6	4.9	
Non-cracked concrete C 20/25	kN	1.9	2.6	1.9	2.4	3.8	2.2	3.7	5.3	5.0	6.8	
<b>Max. recommended shear load of a single anchor without edge influence</b>												
Cracked concrete C 20/25	kN	no	2.0	no	1.5	3.1	no	2.4	3.4	4.5	7.9	
Non-cracked concrete C 20/25	kN	no	2.0	no	2.1	3.1	1.9	3.4	3.4	6.3	7.9	
<b>Max. recommended bending load of a single anchor</b>												
	Nm	no	no	no	5.1	5.1	9.4	9.4	9.4	18.7	18.7	
<b>Dimensions of the concrete member and installation data</b>												
Embedment	$h_{nom} \geq$	mm	30	35	30	35	45	35	45	55	55	65/75
Min. spacing	$s_{min} =$	mm	35	35	40	40	40	40	40	40	50	50
Min. edge distance	$c_{min} =$	mm	35	35	40	40	40	40	40	40	50	50
Thickness of the concrete	$h_{min} =$	mm	-	-	-	100	100	100			120	



#### Description

Universal screw (electrician's screw) with panhead and Phillips PH2 recess. Available both in hardened, electroplated steel in corrosivity class C2 and in acid-proof stainless steel in corrosivity class C5M.

#### Applications

Suitable for wood, wood fibreboard and plasterboard, and together with plugs. Not for use in load bearing timber structures.

#### Benefits, general

- Documented quality
- High pitch – much faster than conventional wood screws
- Extra sharp point – no hole notch necessary in soft materials
- Fully threaded – works well in thin materials
- Specially designed for electricians' needs
- Durable packaging

#### Benefits TEL-C5M

- Type-approved in category C5M
- Corrosion-classified in category C5M for installations in harsh environments

#### Technical data

Material TEL	Hardened, electroplated steel
Material TEL-C5M	Acid-proof stainless steel AISI 316
Standards and regulations	<ul style="list-style-type: none"> <li>• Corrosivity category C5M in accordance with SS-EN ISO 12944-2</li> <li>• Construction Regulations issued by the National Board of Housing, Building and Planning (BKR)</li> </ul>

### Range

Type	Dimension Ø x L (mm)	Qty per package	EAN code	Internal ID-No.	Ref. No.
<b>Universal screw TEL</b>					
Universal screw with panhead, Phillips PH2 recess. Single thread, sharp point. Fully threaded. Specially designed for electricians' needs. Suitable for wood, wood fibreboard, plasterboard, and together with plugs. Not for use in load bearing timber structures. Material: Hardened, electroplated steel.					
TEL	4.4x21	100	3606480330377	20064000	IMT38056
	4.4x25	100	3606480330384	20064001	IMT38057
	4.4x35	100	3606480330391	20064002	IMT38058
	4.4x45	100	3606480330407	20064003	IMT38059
	4.4x58	100	3606480330414	20064004	IMT38060
	4.4x69	100	3606480330421	20063999	IMT38061
<b>Universal screw TEL-C5M</b>					
Universal screw with panhead, Phillips PH2 recess. Single thread, sharp point. Fully threaded. Specially designed for electricians' needs. Suitable for wood, wood fibreboard, plasterboard, and together with plugs. Not for use in load bearing timber structures. Corrosivity class C5M. Material: Acid-proof stainless steel.					
TEL-C5M	4.4x21	100	7315883760150	20051469	3760150
	4.4x25	100	7315880115144	20051470	3760155
	4.4x35	100	7315883760167	20051471	3760160

P126134  
P126131



P126128





**Description**

Universal screw with panhead and Phillips PH2 recess.

**Applications**

Suitable for wood, wood fibreboard and plasterboard, and together with plugs. Not for use in load bearing timber structures.

**Benefits**

- Documented quality
- Twin thread – fast and easy installation
- High pitch – much faster than conventional wood screws
- Extra sharp point – no hole notch necessary in soft materials
- Fully threaded – works well in thin materials
- Durable packaging

**Technical data**

Material	Hardened, electroplated steel
----------	-------------------------------

**Range**

P126116  
P126119  
P126123  
P126125



Type	Dimension Ø x L (mm)	Qty per package	EAN code	Internal ID-No.	Ref. No.
<b>Universal screw TGS</b>					
Universal screw with panhead, Phillips PH2 recess. Twin thread, sharp point. Fully threaded. Suitable for wood and wood fibreboard and together with plugs. Not for use in load bearing timber structures. TGS-4,2x25 also in big-pack. Material: Hardened, electroplated steel.					
TGS-3,5x19	3.5x19	100	7315883709814	20033269	3709810
TGS-3,5x32	3.5x32	100	7315880054825	20033273	3709815
TGS-4,2x13	4.2x13	100	7315883709838	20033274	3709830
TGS-4,2x16	4.2x16	100	7315880055235	20033275	3709835
TGS-4,2x19	4.2x19	100	7315883709845	20033276	3709840
TGS-4,2x25	4.2x25	100 1000	7315880054832 7332418020077	20033277 20060181	3709845 3709846
TGS-4,2x31	4.2x31	100	7315883709852	20033278	3709850
TGS-4,2x38	4.2x38	100	7315880054849	20033279	3709855
TGS-4,2x45	4.2x45	100	7315883709869	20033280	3709860
TGS-4,2x65	4.2x65	100	7315880054856	20033281	3709865



#### Description TGE

Self-tapping screw with panhead and Phillips PH2 recess.

#### Applications

Suitable for installations of sheet metal without pilot drilling, maximum 2x1.5 mm.

#### Benefits

- Documented quality
- Penetrates 2x1.5 mm sheet metal without pilot drilling
- Single thread – for optimum drilling capacity
- Fully threaded – works well in thin materials
- Durable packaging

#### Technical data

Material	Hardened, electroplated steel
----------	-------------------------------

### Range

P128111  
P128114



Type	Dimension Ø x L (mm)	Qty per package	EAN code	Internal ID-No.	Ref. No.
<b>Self-tapping screw TGE</b>					
Screw with panhead, Phillips PH2 recess. Drill point. Single thread. Fully threaded. Suitable for mounting in sheet metal without pilot drilling, maximum 2x1.5 mm. Material: Hardened, electroplated steel.					
TGE 3,5x11	3.5x11	100	7315883709715	20034538	3709710
TGE 4,2x16	4.2x16	100	7315883709722	20034539	3709720
TGE 4,2x19	4.2x19	100	7315883709739	20034540	3709730
TGE 4,2x25	4.2x25	100	7315883709746	20034541	3709740
TGE 4,2x32	4.2x32	100	7315883709753	20034542	3709750
TGE 4,8x50	4.8x50	100	7315883709760	20034543	3709760



#### Description TSE

Self-tapping screw with large thin head and Phillips PH2 recess.

#### Applications

Suitable for the fixing of sheet metal to sheet metal, maximum 2x1.5 mm.

#### Benefits

- Documented quality
- Drill point and self-tapping thread for installation in steel or sheet metal
- Penetrates 2x1.5 mm sheet metal without pilot drilling
- Extra broad head, 11.2 mm – good function in thin and soft materials
- Fully threaded – works well in thin materials
- Durable packaging

#### Technical data

Material	Hardened, electroplated steel
----------	-------------------------------

### Range

P128173  
P128175



Type	Dimension Ø x L (mm)	Qty per package	EAN code	Internal ID-No.	Ref. No.
<b>Self-tapping screw TSE</b>					
Screw with large thin head, Phillips PH2 recess. Drill point. Single thread. Fully threaded. Suitable for the fixing of sheet metal to sheet metal, maximum 2x1.5 mm. TSE-4,2x13 also in big-pack. Material: Hardened, electroplated steel.					
TSE-4,2x13	4.2x13	100	7315883782619	20034504	3782610
		1000	7332418020176	20060188	3782611
TSE-4,2x31	4.2x31	100	7315883782626	20034505	3782620



#### Description TSS

Self-tapping screw with panhead and Phillips PH1 recess.

#### Applications

Suitable for the fixing of sheet metal to sheet metal, maximum 2x1.5 mm.

#### Benefits

- Documented quality
- Drill point and self-tapping thread for installation in steel or sheet metal
- Penetrates 2x1.5 mm sheet metal without pilot drilling
- Extra broad head, 11.2 mm – good function in thin and soft materials
- Fully threaded – works well in thin materials
- Durable packaging

#### Technical data

Material: Hardened, electroplated steel

### Range

Type	Dimension Ø x L (mm)	Qty per package	EAN code	Internal ID-No.	Ref. No.
<b>Self-tapping screw TSS</b>					
Screw with panhead, Phillips PH1 recess. Drill point. Single thread. Fully threaded. Suitable for the fixing of sheet metal to sheet metal, maximum 2x1.5 mm. Material: Hardened, electroplated steel.					
TSS	2.9x9.5	500	3606480330438	20064005	IMT38062



#### Description TSB

Self-tapping collar screw with 1/4" hexagon head and Phillips PH2 recess.

#### Applications

Suitable for sheet steel, maximum 2x1.5 mm.

#### Benefits

- Documented quality
- Self-tapping screw with drill point to penetrate steel or metal
- Collar Ø 8.3 mm – with the function of a small washer
- Penetrates 2x1.5 mm sheet metal without pilot drilling
- Fully threaded – works well in thin materials
- Works well together with magnetic sockets TST-V 9x100 and TST-V 10x45, and long Phillips bits PH 2x110, in confined spaces
- Durable packaging

#### Technical data

Material: Hardened, electroplated steel

### Range

Type	Dimension Ø x L (mm)	Qty per package	EAN code	Internal ID-No.	Ref. No.
<b>Self-tapping collar screw TSB</b>					
Collar screw with 1/4" hexagon head, Phillips PH2 recess. Drill point. Single thread. Fully threaded. Suitable for sheet steel, maximum 2x1.5 mm. TSB-4,2x19 also in big-pack. Material: Hardened, electroplated steel.					
TSB-3,5x13	3.5x13	100	7315883780615	10002002	3780610
TSB-3,5x19	3.5x19	100	7315880047421	10002003	3780615
TSB-3,5x25	3.5x25	100	7315883780622	10002004	3780620
TSB-4,2x13	4.2x13	100	7315883780714	10002007	3780710
TSB-4,2x19	4.2x19	100	7315880047445	10002008	3780715
		1000	7332418020121	20060184	3780716
TSB-4,2x25	4.2x25	100	7315883780721	10002009	3780720
TSB-4,2x32	4.2x32	100	7315880047452	10002010	3780725
TSB-4,2x38	4.2x38	100	7315883780738	10002011	3780730



**Description**

Collar screw with 1/4" hexagon head and Phillips PH2 recess.

**Applications**

Suitable for wood and wood fibreboard, sheet steel, and together with plugs.

**Benefits**

- Documented quality
- Extra sharp-pointed, self-tapping screw
- Twin steep-pitch thread – fast and easy running
- Collar Ø 8.3-10,1 mm – with the function of a small washer
- Penetrates 2x0,9 mm sheet metal without pilot drilling
- Fully threaded – works well in thin materials
- Works well together with magnetic sockets TST-V 9x100 and TST-V 10x45, and long Phillips bits PH 2x110, in confined spaces
- Durable packaging

**Technical data**

Material	Hardened, electroplated steel
----------	-------------------------------

**Range**

P126142  
P126144  
P126148



Type	Dimension Ø x L (mm)	Qty per package	EAN code	Internal ID-No.	Ref. No.
<b>Collar screw TST</b>					
Collar screw with 1/4" hexagon head, Phillips PH2 recess. Twin thread. Fully threaded. Suitable for wood and wood fibreboard, sheet steel, and together with plugs. TST-4,2x19 and TST-4,2x25 also in big-pack. Material: Hardened, electroplated steel.					
TST-4,2x13	4.2x13	100	7315880044406	10001990	3780210
TST-4,2x19	4.2x19	100 1000	7315880044413 7332418020091	10001991 20060192	3780215 3780216
TST-4,2x25	4.2x25	100 1000	7315880044420 7332418020107	10001992 20060193	3780220 3780221
TST-4,2x32	4.2x32	100	7315880044437	10001993	3780225
TST-4,2x38	4.2x38	100	7315880044444	10001994	3780230
TST-4,2x51	4.2x51	100	7315880044451	10001995	3780235



#### Description

Collar screw with large thin head and Phillips PH2 recess.

#### Applications

Works in most materials – metal studwork, cabinets, wood, plugs.

#### Benefits, general

- Documented quality
- Extra sharp-pointed screw with self-tapping thread
- Twin steep-pitch thread – fast and easy running
- Penetrates 2x0.9 mm sheet metal without pilot drilling (not TSC-C5M)
- Extra broad head, 11.2 mm – good function in thin and soft materials
- Works in most materials – sheet metal studwork, cabinets, wood, plugs
- Durable packaging

#### Benefits, TSC-C5M

- Type-approved in category C5M
- Corrosion-classified in category C5M for installations in harsh environments

#### Technical data

Material TSC	Hardened, electroplated steel
Material TSC-C5M	Acid-proof stainless steel AISI 316
Standards and regulations	<ul style="list-style-type: none"> <li>• Corrosivity category C5M in accordance with SS-EN ISO 12944-2</li> <li>• Construction Regulations issued by the National Board of Housing, Building and Planning (BKR)</li> </ul>

### Range

Type	Dimension Ø x L (mm)	Qty per package	EAN code	Internal ID-No.	Ref. No.
<b>Installation screw TSC</b>					
Screw with large thin head, Phillips PH2 recess. Twin thread. TSC-4,2x13, 4,2x25, 4x2x31 fully threaded, TSC-4,2x45, 4,2x65, 4,2x85 part-threaded. Suitable when jointing two metal sheets together, maximum thickness 2x0.9 mm. Works in most materials – metal studwork, cabinets, wood, plugs. TSC-4,2x13 and TSC-4,2x25 also in big-pack. Material: Hardened, electroplated steel.					
TSC-4,2x13 Fully threaded	4.2x13	100 1000	7315883782015 7332418020138	20034493 20060185	3782010 3782011
TSC-4,2x25 Fully threaded	4.2x25	100 1000	7315883782022 7332418020145	20034494 20060186	3782020 3782021
TSC-4,2x31 Fully threaded	4.2x31	100	7315883782039	20034495	3782030
TSC-4,2x45 Part-threaded	4.2x45	100	7315883782046	20034497	3782040
TSC-4,2x65 Part-threaded	4.2x65	100	7315883782053	20034498	3782050
TSC-4,2x85 Part-threaded	4.2x85	50	7315883782060	20034499	3782060
Screw with thin head, Phillips PH2 recess. Single thread, fully threaded, sharp point. Suitable when jointing two metal sheets together, maximum thickness 2x0.9 mm. Works in most materials – metal studwork, cabinets, wood. Material: Hardened, phosphate-coated steel.					
TSC-FB 4,2x14	4.2x14	100	3606480507403	20076702	IMT37331
<b>Installation screw TSC-C5M</b>					
Screw with large thin head, Phillips PH2 recess. Sharp point, twin thread. Fully threaded. Suitable when jointing two metal sheets together, maximum thickness 2x0.9 mm. Works in most materials – metal studwork, cabinets, wood, plugs. Corrosivity category C5M. Material: Acid-proof stainless steel.					
TSC-C5M-4,2x25	4.2x25	100	7315883782268	20051467	3782260
TSC-C5M-4,2x32	4.2x32	100	7315880115137	20051468	3782265



#### Description TSF

Installation screw with raised countersunk head and Phillips PH2 recess.

#### Applications

Suitable for mounting directly into plasterboard.

#### Benefits

- Documented quality
- Extra sharp-pointed screw with wood screw thread
- Installs directly into plasterboard
- Fully threaded – works well in thin materials
- Durable packaging

#### Technical data

Material: Hardened, electroplated steel

### Range

P128168  
P128172



Type	Dimension Ø x L (mm)	Qty per package	EAN code	Internal ID-No.	Ref. No.
<b>Installation screw TSF</b>					
Installation screw with raised countersunk head, Phillips PH2 recess. Fully threaded. Suitable for mounting directly into plasterboard. TSF-4,8x25 also in big-pack. Material: Hardened, electroplated steel.					
TSF-4,8x25	4.8x25	100 1000	7315883782428 7332418020169	20033449 20060189	3782420 3782421
TSF-4,8x35	4.8x35	100	7315883782435	20033450	3782430
TSF-4,8x45	4.8x45	100	7315883782442	20033451	3782440



#### Description TSI

Installation screw with countersunk head and Phillips PH2 recess.

#### Applications

Suitable for mounting of plasterboard panels to steel and timber studwork.

#### Benefits

- Documented quality
- Extra sharp-pointed screw with steep-pitch thread – for fast mounting
- Penetrates 0.7 mm sheet metal without pilot drilling
- Countersunk head – easy to conceal in the plasterboard
- Fully threaded – works well in thin materials
- Durable packaging

#### Technical data

Material: Hardened, electroplated steel

### Range

P128176  
P128178



Type	Dimension Ø x L (mm)	Qty per package	EAN code	Internal ID-No.	Ref. No.
<b>Installation screw TSI</b>					
Screw with countersunk head, Phillips PH2 recess. Suitable for mounting of plasterboard panels to steel and timber studwork. Also in big-pack. Material: Hardened, electroplated steel.					
TSI-3,9x32	3.9x32	100 1000	7315883782817 7332418020183	20033454 20060190	3782810 3782811
TSI-3,9x41	3.9x41	100 1000	7315883782824 7332418020190	20033455 20060191	3782820 3782821



#### Description TMP-C3

Installation screw with raised countersunk head and Phillips PH2 recess. Corrosivity category C3.

#### Applications

Suitable for direct use in plasterboard and for 4 mm drilled holes in concrete and bricks.

#### Benefits

- Documented quality
- Type-approved
- Corrosion classified in category C3
- Raised countersunk head
- Fully threaded – works well in thin materials
- Durable packaging

#### Technical data

Material	Hardened, electroplated steel
Standards and regulations	Corrosivity category C3 in Accordance with SS-EN ISO 12944-2

### Range

P128136  
P128139



Type	Dimension Ø x L (mm)	Qty per package	EAN code	Internal ID-No.	Ref. No.
<b>Installation screw TMP-C3</b>					
Installation screw with raised countersunk head and Phillips PH2 recess. Sharp point, fully threaded. Suitable for direct use in plasterboard and for 4 mm drilled holes in concrete and bricks. Corrosivity category C3. Material: Hardened, electroplated steel.					
TMP-C3-5,0x25	5.0x25	100	7315883764011	20051496	3764010
TMP-C3-5,0x32	5.0x32	100	7315880115113	20051497	3764015
TMP-C3-5,0x38	5.0x38	100	7315883764028	20051498	3764020
TMP-C3-5,0x41	5.0x41	100	7315880115120	20051499	3764025
TMP-C3-5,0x45	5.0x45	100	7315883764035	20051500	3764030

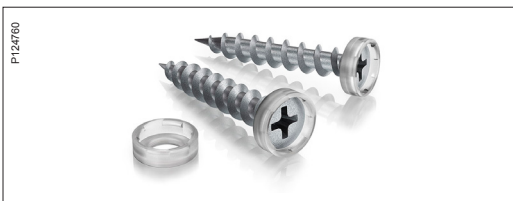

#### Description TFT-IS

Installation screw with insulated cup washer and cross-slotted head with Phillips PH2 recess.

#### Applications

Provided with an insulating cup washer for screw-head protection when installing single-insulated wires in for instance trunking.

#### Benefits

- Documented quality
- Works in many different materials, such as wood, plasterboard, concrete, bricks (pre-drill a Ø 4 mm hole), sheet metal studwork
- Fully threaded – works well in thin materials
- Allows for single-insulated wires to be installed in e.g. trunking
- Durable packaging

#### Technical data

Material	Screw: Hardened, electroplated steel Cup washer: PP, transparent
----------	---

### Range

P99119



Type	Dimension Ø x L (mm)	Qty per package	EAN code	Internal ID-No.	Ref. No.
<b>Installation screw TFT-IS with cup washer</b>					
Installation screw with cross-slotted head type PH2. Sharp point, fully threaded. High pitch for quick mounting. Provided with a transparent cup washer for screw-head protection. To be used when installing single-insulated wire in for instance trunking. Material: Hardened steel, electroplated, and PP.					
TFT-IS 5x32	5x32	100	7332418018203	20057379	4020210



#### Description

Screw with metric thread and panhead with Phillips PH2 recess. Hexagon nut with metric thread, round washer.

#### Applications

Suitable for assembly and mounting of components.

#### Benefits

- Documented quality
- Range M3–M8 with screw, nut and washer
- Metric screw with panhead and Phillips PH2 recess
- Durable packaging

#### Technical data

Material	Screw:	Electroplated steel 4.8
	Nut:	Electroplated steel 6.8
	Washer:	Electroplated steel
Standards	Screw:	ISO 7045
	Nut:	ISO 4032
	Washer:	DIN 125A

### Range

Type	Dimension Ø x L (mm)	Qty per package	EAN code	Internal ID-No.	Ref. No.
<b>Metric screw MRX</b>					
Screw with metric thread and panhead, Phillips PH2 recess. Suitable for assembly and mounting of components. Mounting with cross-point screwdriver or power screwdriver. Material: Electroplated steel 4.8.					
MRX-M3x25	3x25	100	7315883702013	20039868	3702010
MRX-M3x45	3x45	100	7315883702020	20039869	3702020
MRX-M4x25	4x25	100	7315883702044	20039870	3702040
MRX-M4x50	4x50	100	7315883702051	20039871	3702050
MRX-M5x25	5x25	100	7315883702075	20039872	3702070
MRX-M5x50	5x50	100	7315883702082	20039873	3702080
MRX-M6x25	6x25	100	7315883702105	20039874	3702100
MRX-M6x50	6x50	100	7315883702112	20039875	3702110
MRX-M8x25	8x25	100	7315883702136	20039876	3702130
MRX-M8x50	8x50	50	7315883702143	20039877	3702140
<b>Dimension (mm)</b>					
<b>Nut M6M</b>					
Hexagon nut with metric thread, suitable for screw MRX. Material: Electroplated steel 6.8.					
M6M-M3	M3	100	7315883702266	20039878	3702260
M6M-M4	M4	100	7315880054870	20039879	3702265
M6M-M5	M5	100	7315883702273	20039880	3702270
M6M-M6	M6	100	7315880054887	20039881	3702275
M6M-M8	M8	100	7315883702280	20039882	3702280
<b>Dimension Inner Ø/Outer Ø/t (mm)</b>					
<b>Washer RB</b>					
Round washer, suitable for screw MRX. Material: Electroplated steel.					
RB3,2	3.2/7/0.5	100	7315883702211	20039883	3702210
RB4,3	4.3/9/0.8	100	7315880054894	20039884	3702215
RB5,3	5.3/10/1.0	100	7315883702228	20039885	3702220
RB6,4	6.4/12/1.6	100	7315880054900	20039886	3702225
RB8,4	8.4/16/1.6	100	7315883702235	20039887	3702230





#### Description

The Thorsman range of TEX through bolts includes bolts for indoor as well as outdoor applications. They are intended for installations in both concrete and natural rock materials.

The steel bolts with electroplated zinc are suitable mainly for indoor applications, the hot-dipped zinc and acid-proof stainless steel bolts are to be used in outdoor or extreme environments.

#### Benefits

- Fast installation with hammer and wrench
- Installs directly in concrete and natural rock materials
- No need for a clean drilled hole
- Documented quality
- High-quality anchor
- Fast-grip design, a few turns on the nut sets the anchor

#### Material data

Material steel bolt	Steel
Surface treatments	<ul style="list-style-type: none"> <li>• Electroplated zinc 5 µm, C2</li> <li>• Hot-dipped zinc size M6 25 µm, C3</li> <li>• Hot-dipped zinc other sizes 45 µm, C3</li> </ul>
Material stainless bolt and clips	Acid-proof stainless steel AISI 316, C5M
Temperature range	From -20°C to +60°C

#### Approval

SP SITAC No. SC0268-10

#### Mounting instruction

Reference is made to the complete mounting instruction "Monteringsanvisning för TF-anchor", dated 2010-10-15, for the time being only available in Swedish.

#### Technical information

##### Installation information, table 1

Dim. TEX	L (mm)	Ø D (mm)	A (mm)	T max. (mm)	B (mm)	M (Nm)	Edge distance (mm)
M6 x	40	6	37	3	28*	8	60
M6 x	70	6	67	26	35*	8	60
M8 x	50	8	48	5	35*	23	80
M8 x	95	8	93	30	55	23	80
M10 x	80	10	57	7	40	35	100
M10 x	105	10	102	22	70	35	100
M12 x	85	12	82	10	60	55	120
M12 x	125	12	122	30	80	55	120

\* Installation depth smaller than 40 mm only allowed in safety class 1.

Safety classes: source BKR (Swedish institute "Boverkets Konstruktionsregler"), section 2:115, first-second paragraphs.

#### Concrete strength

The minimum allowed concrete strength for table values is C20/25.

#### Edge distance and c/c installation distance between through bolts

The recommended edge distance is stated in table 1 for the various dimensions. Close to a corner the minimum edge distance needs to be multiplied by 3 (C in the second picture). The distance between two through bolts installed in formation should be the stated edge distance multiplied by 2 (S in the second picture).

#### Smallest thickness of the concrete construction

The thickness of the concrete construction must be at least the stated installation depth multiplied by 1.5 and must not be less than 100 mm.

#### Drilling

Drill the hole with a hammer drill of the same diameter as the through bolt being installed.

#### Installation depth

For minimum installation depth, see table 1.

#### Installation

The through bolt should be installed with a torque wrench according to values in table 1. The through bolt needs to be clean and it should not be greased or oiled prior to installation.

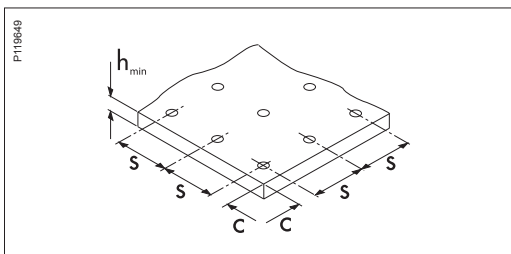
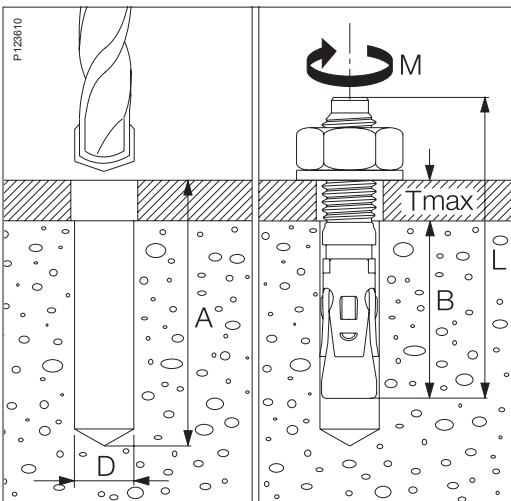

**Corrosion**

All steel fixings must have a protection against corrosion in order to stay safe over a long time.

*Electroplated steel* is suitable for indoor and protected outdoor use, called C2 in this Technical leaflet.

*Hot-dip galvanized steel* is suitable for outdoor applications, called C3 or C4 in this Technical leaflet, depending on the thickness of the zinc layer.

*Acid proof stainless steel* is suitable for aggressive indoor and outdoor environments, called C5M in this Technical leaflet.

**Atmospheric corrosivity categories and examples of typical environments**

Corrosivity category	Examples of typical environments in a temperate climate (informative only)	
	Outdoors	Indoors
C1 very low	–	Heated buildings with clean atmospheres, e.g. offices, shops, schools, hotels.
C2 low	Atmospheres with low level of pollution. Mostly rural areas.	Unheated buildings where condensation may occur, e.g. depots, sports halls, multi-storey car parks.
C3 medium	Urban and industrial atmospheres, moderate sulphur dioxide pollution. Coastal areas with low salinity.	Production rooms with high humidity and some air pollution, e.g. food-processing plants, laundries, breweries, dairies.
C4 high	Industrial areas and coastal areas with moderate salinity.	Chemical plants, swimming-baths, coastal ship- and boat yards, car-washes.
C5-I very high (industrial)	Industrial areas with high humidity and aggressive atmosphere.	Buildings in areas with almost permanent condensation and with high pollution.
C5-M very high (marine)	Coastal and offshore areas with high salinity.	Buildings in areas with almost permanent condensation and with high pollution.

**Choice of product per corrosivity/safety classification, table 2**

Corrosivity classification	Safety classification	
	1	2
C1	Electroplated	Electroplated
C2	Hot-dip galvanized	Hot-dip galvanized
C3	Hot-dip galvanized*	Hot-dip galvanized*
C4	Stainless steel A4	Stainless steel A4
C5-I	Stainless steel A4	Stainless steel A4
C5-M	Stainless steel A4	Stainless steel A4

\* Not applicable for size M6 (25 µm hot-dip galv.). Choose size M8, M10 or M12 (45 µm hot-dip galv.).

**Pull-out load, table 3**

Design resistance and practical loading capacity. Concrete strength C20/25

Dim.	Installation depth (mm)	Serviceability limit state (kN)	Ultimate limit state		Practical loading capacity (kN)	Accidental actions (kN)
			Safety cl 1 (kN)	Safety cl 2 (kN)		
M6	28	4.5	2.8	2.5	2.1	5.6
M8	35	8.7	4.5	4.1	3.4	9.0
	55	9.0	5.9	5.3	4.4	11.7
M10	40	9.9	5.2	4.7	3.9	10.3
	70	16.2	10.6	9.6	8.0	21.1
M12	60	20.4	10.7	9.7	8.1	21.4
M12	80	20.7	15.0	13.6	11.4	30.0

**Shear load, table 4**

Design resistance and practical loading capacity. Concrete strength C20/25.

Dimension	Installation depth (mm)	Ultimate limit state		Practical loading capacity (kN)	Accidental actions (kN)
		Safety cl 1 (kN)	Safety cl 2 (kN)		
M6	28	2.9	2.6	2.2	5.7
M8	35	6.4	5.8	4.8	12.7
M10	40	9.8	8.9	7.4	19.5
M12	60	14.3	13.0	10.8	28.6

Range

Type	Dimensions Ø x length (mm)	Qty per package	EAN code	Internal ID-No.	Ref. No.
<b>Corrosivity class C2</b>					
Through bolt including nut and washer. Intended mainly for indoor installations in concrete or natural rock material. Fast-grip design, the bolt is set with a few turns of the nut. Material: Steel, electroplated zinc.					
TEX-C2 M6x40	M6x40	100	3606480214660	20062374	IMT38005
TEX-C2 M6x70	M6x70	100	3606480214677	20062375	IMT38006
TEX-C2 M8x50	M8x50	100	3606480214684	20062376	IMT38007
TEX-C2 M8x95	M8x95	50	3606480214691	20062377	IMT38008
TEX-C2 M10x60	M10x60	50	3606480214707	20062378	IMT38009
TEX-C2 M10x105	M10x105	25	3606480214714	20062379	IMT38010
TEX-C2 M12x85	M12x85	25	3606480214721	20062380	IMT38011
TEX-C2 M12x125	M12x125	25	3606480214738	20062381	IMT38012
<b>Corrosivity class C3</b>					
Through bolt including nut and washer. Suitable in installations in concrete or natural rock material, outdoors as well as in extreme indoor environments. Fast-grip design, the bolt is set with a few turns of the nut. Material: Steel, hot-dipped zinc.					
TEX-C3 M6x40	M6x40	100	3606480214745	20062382	IMT38013
TEX-C3 M6x70	M6x70	100	3606480214752	20062383	IMT38014
TEX-C3 M8x50	M8x50	100	3606480214769	20062384	IMT38015
TEX-C3 M8x95	M8x95	50	3606480214776	20062385	IMT38016
TEX-C3 M10x60	M10x60	50	3606480214783	20062386	IMT38017
TEX-C3 M10x105	M10x105	25	3606480214790	20062387	IMT38018
TEX-C3 M12x85	M12x85	25	3606480214806	20062388	IMT38019
TEX-C3 M12x125	M12x125	25	3606480214813	20062389	IMT38020
<b>Corrosivity class C5M</b>					
Through bolt including nut and washer. Suitable in installations in concrete or natural rock material, outdoors as well as in extreme indoor environments. Fast-grip design, the bolt is set with a few turns of the nut. Material: Stainless steel, acid-proof.					
TEX-C5M M6x40	M6x40	100	3606480214820	20062390	IMT38021
TEX-C5M M6x70	M6x70	100	3606480214837	20062391	IMT38022
TEX-C5M M8x50	M8x50	100	3606480214844	20062392	IMT38023
TEX-C5M M8x95	M8x95	50	3606480214851	20062393	IMT38024
TEX-C5M M10x60	M10x60	50	3606480214868	20062394	IMT38025
TEX-C5M M10x105	M10x105	25	3606480214875	20062395	IMT38026

P117745



P117744



P117746



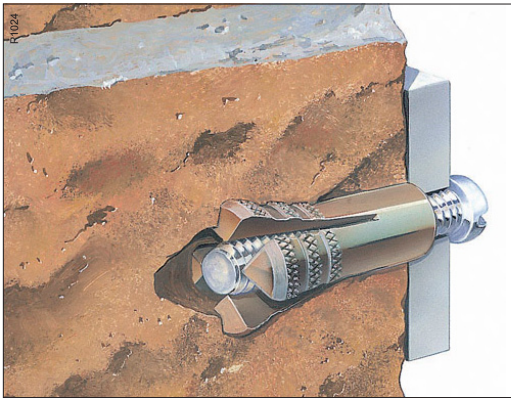

#### Description

Brass anchor with metric fixing point.

#### Applications

Wherever a fixing point flush with the surface is needed, in either ceiling, wall or floor surfaces. Suitable for concrete, stone, solid bricks and other solid materials.

#### Benefits

- Captive fixing
- No projecting parts
- Shallow installation depth
- No special tools required
- Corrosion-resistant

#### Material data

Material Brass

#### Installation

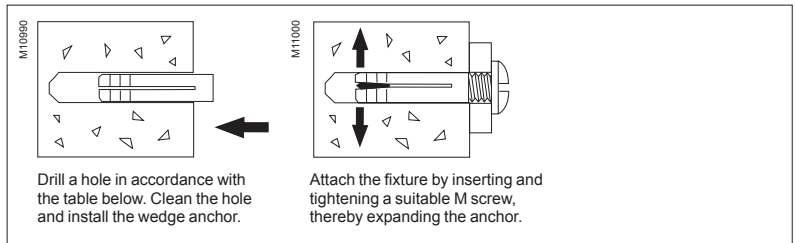

#### Technical data (1 kN approx. 100 kg)

Type Inside thread x L mm	Drill Ø mm	Min. hole depth mm	Min. screw penetration depth <sup>1)</sup> mm	Recommended load <sup>2)</sup> Shear/Pull-out in concrete 25 N/mm <sup>2</sup> kN
TMA-M6x24	8	27	24	1.5/0.65
TMA-M8x30	10	34	30	2.0/1.1
TMA-M10x34	12	38	34	2.5/1.6

<sup>1)</sup> For full expansion.

<sup>2)</sup> Safety factor 2.5 for shear and 3 for pull-out load.

#### Range

P79824



Type	Dimensions Ø x length (mm)	Qty per package	EAN code	Internal ID-No.	Ref. No.
Wedge brass anchor with metric fixing point. Intended for use wherever a fixing point flush with the surface is needed. Suitable for concrete, stone, solid bricks and other solid materials. Material: Brass.					
TMA-M6x24	M6x24	100	7315882820107	10001250	2820108
TMA-M8x30	M8x30	100	7315882820121	10001251	2820124
TMA-M10x34	M10x34	50	7315882820145	10001252	2820140

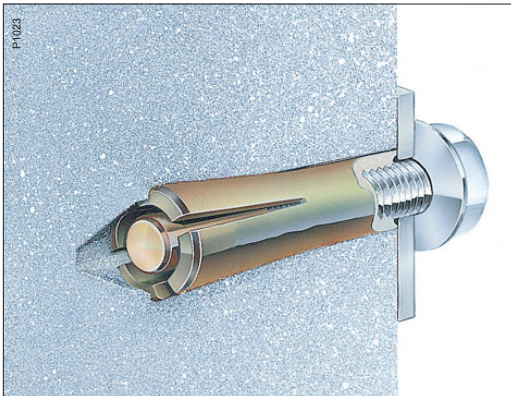

#### Description

Steel anchor with metric fixing point.

#### Applications

Wherever a fixing point flush with the surface is needed, in either ceiling, wall or floor surfaces. Suitable for concrete, stone, solid bricks and blocks.

#### Benefits

- Captive fixing
- No projecting parts
- Shallow installation depth
- Withstands aggressive environments
- High load values
- Fireproof

#### Material data

Material Electroplated steel, yellow chromated

#### Installation

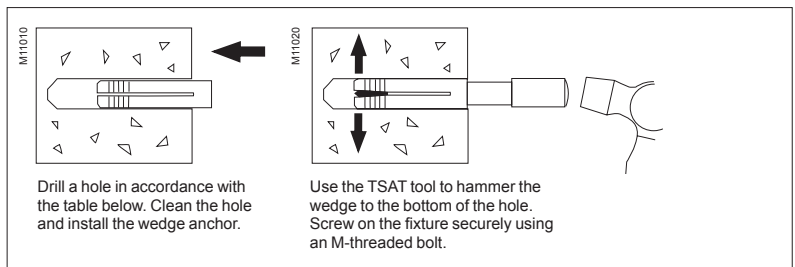

### Technical data (1 kN approx. 100 kg)

Type Inside thread x L mm	Ø/min. hole depth mm	Thread diameter mm	Inside thread length mm	Min. distance to edge mm	Min. c/c distance mm	Max. recommended load <sup>1)</sup> kN
TSA-M6x25	8/25	M6	11	70	70	1.7
TSA-M8x30	10/30	M8	15	90	90	2.8
TSA-M10x40	12/40	M10	18	120	120	4.2
TSA-M12x50	15/50	M12	21	150	150	7.4

<sup>1)</sup> Pull-out in 30 N/mm<sup>2</sup> concrete. Safety factor 5 included.

### Range

Type	Dimensions Ø x length (mm)	Qty per package	EAN code	Internal ID-No.	Ref. No.
<b>Anchor</b>					
Wedge steel anchor with metric fixing point. High load values, fireproof. Intended for use wherever a fixing point flush with the surface is needed. Suitable for concrete, stone, solid bricks and blocks. Material: Electroplated steel, yellow chromated.					
TSA-M6x25	M6x25	100	7315882810108	10001236	2810109
TSA-M8x30	M8x30	100	7315882810122	10001237	2810125
TSA-M10x40	M10x40	50	7315882810146	10001238	2810141
TSA-M12x50	M12x50	50	7315882810160	10001239	2810166
<b>Hammer tool</b>					
Hammer tool for the above wedge steel anchors. Material: Steel.					
TSAT-M6	10/140	1	7315882810900	10001242	2810901
TSAT-M8	15/215	1	7315882810924	10001243	2810927
TSAT-M10	16/230	1	7315882810948	10001244	2810943

P10623



P80863



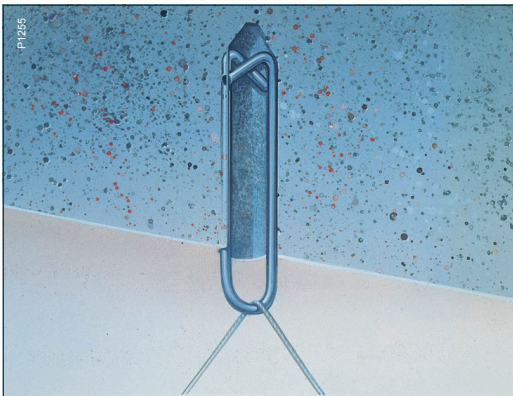

**Description**  
Stainless steel universal anchor.

**Applications**  
For fittings close to the ceiling (with locking tab) and to suspend false ceiling fittings, pipework and ventilation equipment. Suitable for concrete, natural stone, solid bricks and sheet metal.

- Benefits**
- No material fatigue
  - Fire-classified and vibration resistant
  - Corrosion-resistant
  - Simple, secure fitting – grips immediately after driving in
  - Minimal drilling depth – 30 mm

**Material data**

Material	Anchor: Acid-proof stainless steel wire, AISI 316
	Setting tool: Steel, pre-galvanized
	Locking tab: Stainless steel AISI 304

**Installation**

Drill a hole in accordance with the table below. Drive in SEVENHOOK using the setting tool to get the right depth. Done! The short, stiff wire-ends efficiently grip the sides of the hole, giving a strong, secure fixing. Temporary installation of cables, hoses, etc.: Drill slightly deeper (approx. 50 mm) and when the job is finished, drive SEVENHOOK into the hole.

With wire. The cap blanks the hole.

Installation close to ceiling with locking tab.

**Technical data (1 kN approx. 100 kg)**

Type	Drill size Ø mm	Opening for wire, tie, hanger Ø mm	Smallest drilling and insertion depth mm	Practical loading capacity <sup>1)</sup>	
				Concrete C25 kN	Solid brick kN
SVH-E1	8	6.5	30	1.0	0.5
SVH-E2	8	6.5	30	1.0	0.5

<sup>1)</sup> Safety factor 3 for pull-out load.

**Range**

Type	Dimensions W x L (mm)	Qty per package	EAN code	Internal ID-No.	Ref. No.
<b>Universal anchor</b>					
Stainless steel universal anchor. Intended for fittings close to the ceiling and to suspend false ceiling fittings, pipework and ventilation equipment. SVH-E1 includes 100 white caps to blank the drilled hole and one setting tool. SVH-E2 includes one setting tool. Suitable for concrete, natural stone, solid bricks and sheet metal. Material: Stainless steel AISI 316.					
SVH-E1	14/50	100	7321677818709	20066613	781870
SVH-E2	14/50	500	7321677818716	20066622	781871
<b>Locking tab</b>					
Locking tab for installing fittings close to the ceiling (max. 4 kg per fixing for good contact with the ceiling). For heavier fittings, the locking tab can be turned horizontally to counter downward bending (clearance). Material: Stainless steel AISI 304.					
SVH-L	11/30	25	7321677818723	20066092	781872
<b>Setting tool</b>					
Setting tool for a correct installation depth of the universal anchor. Material: Steel, pre-galvanized.					
SVH-T	13/80	10	7321677818730	20066019	781873

P77799



P81301



P81302

