

4 MOUNTING BRACKET, LEFT

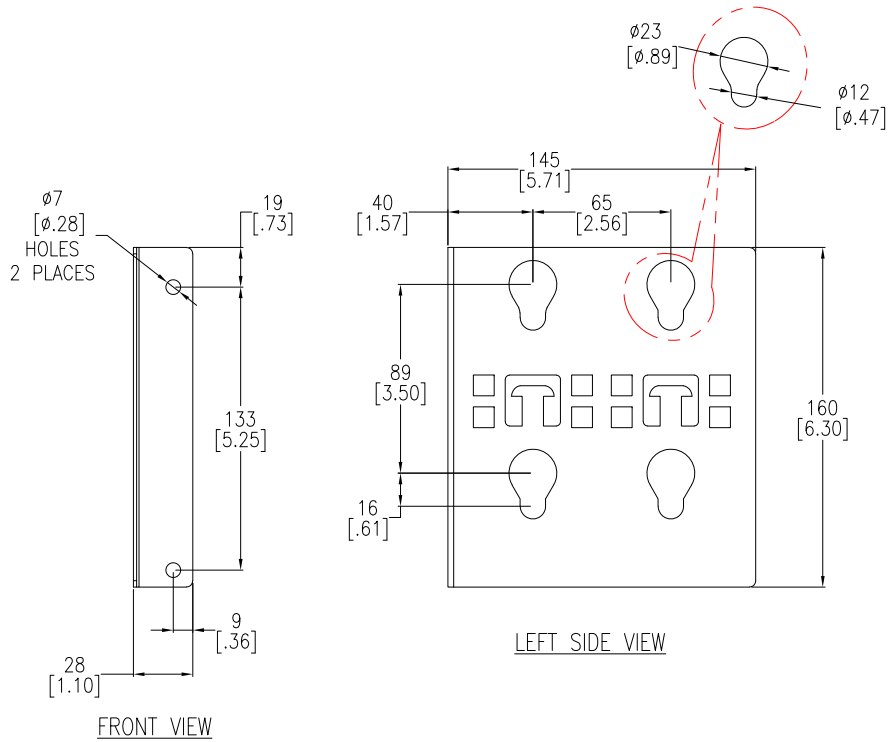

FRONT VIEW

LEFT SIDE VIEW

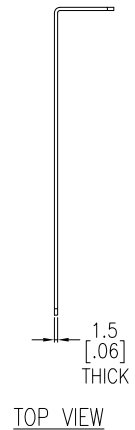

TOP VIEW

4 MOUNTING BRACKET, RIGHT

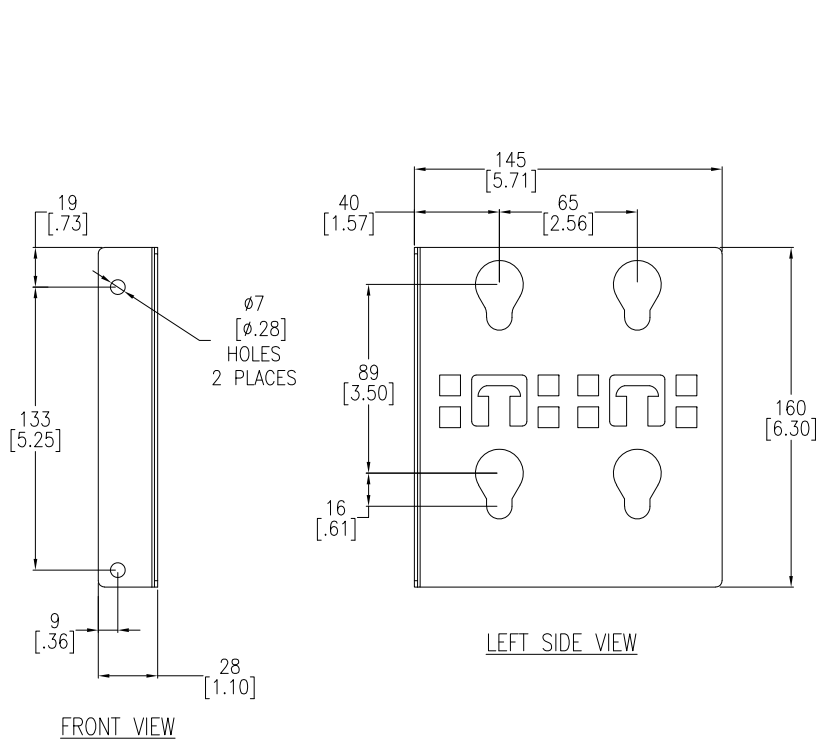

FRONT VIEW

LEFT SIDE VIEW

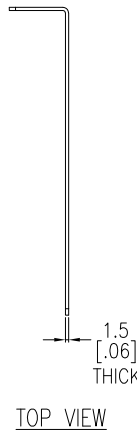

TOP VIEW

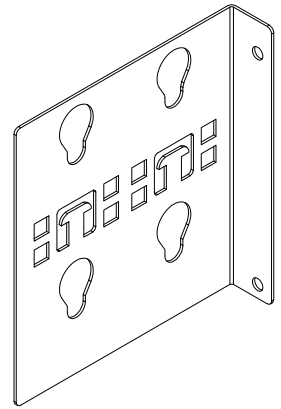

MOUNTING BRACKET, LEFT

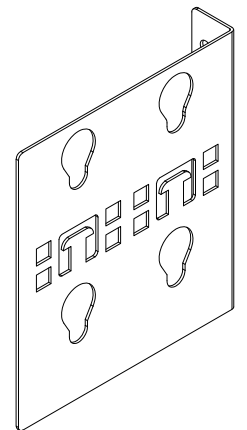

MOUNTING BRACKET, RIGHT

ISOMETRIC VIEW

- NOTES:
1. INSTALLATION SHALL COMPLY WITH ALL APPLICABLE NATIONAL, STATE AND LOCAL ELECTRICAL REGULATIONS.
  2. REFER TO PRODUCT DOCUMENTATION FOR ADDITIONAL DETAILS PRIOR TO INSTALLATION AND SITE PREPARATION WORK.
  3. ALL DIMENSIONS ARE IN MILLIMETERS [INCHES].
  4. THIS SKU CONTAINS A QUANTITY OF 2 NUMBERS OF LEFT & 2 NUMBERS OF RIGHT BRACKETS. NET WEIGHT OF THE UNIT (4 BRACKETS) IS 0.7 kg [1.54 lb].

THIS DRAWING AND SPECIFICATIONS HEREIN ARE THE PROPERTY OF SCHNEIDER ELECTRIC AND SHALL NOT BE COPIED, REPRODUCED OR USED IN WHOLE OR IN PART, AS THE BASIS FOR THE MANUFACTURE OR SALE OF ITEMS WITHOUT WRITTEN PERMISSION FROM SCHNEIDER ELECTRIC. THIS DRAWING IS BASED UPON LATEST AVAILABLE INFORMATION AND IS SUBJECT TO CHANGE WITHOUT NOTICE.



TITLE: Easy RACK PDU MOUNTING BRACKET, LEFT & RIGHT DOUBLE WIDTH GENERAL ARRANGEMENT  
PROJECT: SUBMITTAL DRAWINGS SHEET 1 OF 1

DWG NO: ER7PDUBRKT  
DRAWN BY: JAYAPRAKASH 29-JAN-21  
ENGINEER: Job GU 01-FEB-21  
APPROVED BY: Job GU 01-FEB-21

REV: 0  
FIRST ANGLE PROJECTION