

Product End of Life Instructions

Logic/Motion Controller - Modicon M262

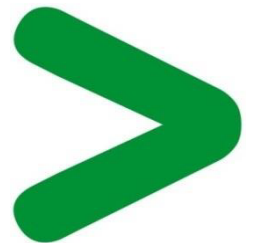



End of Life Instructions

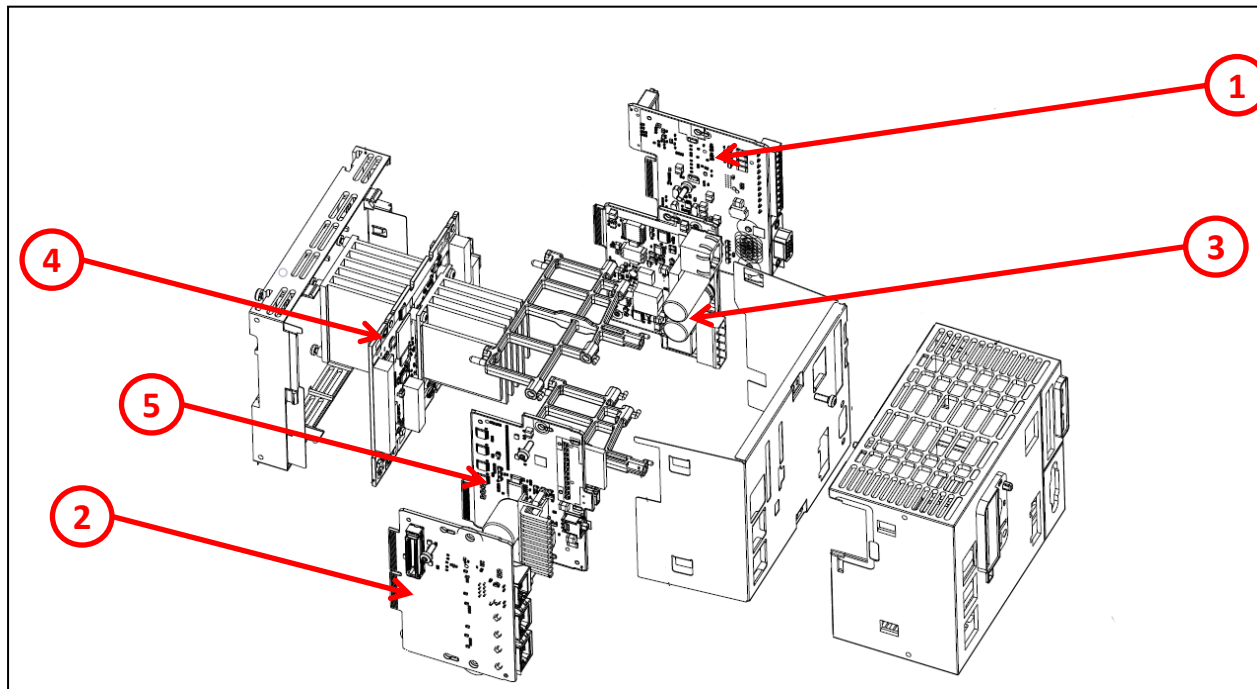

Recommendation	Number on drawing	Component / Material	Weight (in g)	Comment
To be depolluted	1	Electronic Board (Power) > 10cm ²	52.3	
To be depolluted	2	Electronic Board (Power) > 10cm ²	46.7	
To be depolluted	3	Electronic Board (Power) > 10cm ²	21.8	
To be depolluted	4	Electronic Board (Power) > 10cm ²	69.1	without heatsink
To be depolluted	5	Electronic Board (Power) > 10cm ²	35.5	



Product description

Manufacturer identification	Schneider Electric Industries SAS
Brand name	Schneider Electric
Product function	Describe the product and its use
Product reference	TM262M35MESS8T
Additional similar product references	TM262M35MESS8T TM262L10MESE8T TM262L20MESE8T TM262M15MESS8T TM262M25MESS8T
Total representative product mass	668 g
Representative product dimensions	100mm x 80mm x 125mm
Date of information release	06/2019



Additional information

Legal information

This product family is in the scope of European Union directive 2012/19/EU on Waste Electrical and Electronic Equipment (WEEE). The product family must be disposed according to the legislation of the country. This document is intended for use by end of life recyclers or treatment facilities. It provides the basic information to assure an appropriate end of life treatment for the components and materials of the product.

Recyclability potential

39%

Based on "ECO'DEEE recyclability and recoverability calculation method" (version V1, 20 Sep. 2008 presented to the French Agency for Environment and Energy Management: ADEME).

Schneider Electric Industries SAS

Country Customer Care Center
<http://www.schneider-electric.com/contact>

35, rue Joseph Monier
CS 30323
F- 92506 Rueil Malmaison Cedex
RCS Nanterre 954 503 439
Capital social 896 313 776 €

www.schneider-electric.com

ENVEOLI1904006EN_V1

Published by Schneider Electric

© 2019 - Schneider Electric – All rights reserved

06/2019