

APM 16/20

Adaptor polyamide, RAL 7035, Pg16 / M20

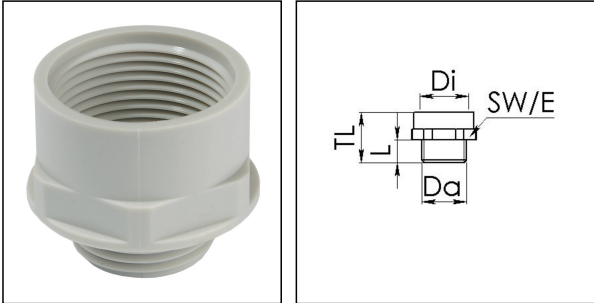

Products may differ in size, colour and appearance to those shown. If you require further information or customisation, please contact us directly.



| | |
|---------------------------------|-----------------------------|
| Material | Polyamide, fibre reinforced |
| Temp. range min | -40 °C |
| Temp. range max | 100 °C |
| Glow wire test | 650 °C |
| Thread type outer | PG |
| Ø outer thread | 16 |
| Length screw-in thread L | 10 mm |
| Thread type inner | M |
| Ø inner thread | 20 |
| Lead inner | 1,5 |
| Length internal thread | 15,5 mm |
| Total length TL | 28 mm |
| Key width SW | 27 mm |
| Collar diameter (E) | 30 mm |
| Form | A |
| Product Color | RAL 7035 |
| Order no. RAL 7035 | 10063661 |
| Type | APM 16/20 |
| Packing unit | 25 |
| ETIM-Classification | EC000938 |

Recommended accessories

| | |
|---------------|----------|
| MUG 16 | 10060674 |
|---------------|----------|

Your Contact:

WISKA Hoppmann GmbH

Kisdorfer Weg 28 · 24568 Kaltenkirchen · Germany

☎ +49-4191-508-0 · 📠 +49-4191-508-209

contact@wiska.de · www.wiska.com

11.02.2021

Your Contact:

WISKA Hoppmann GmbH

Kisdorfer Weg 28 · 24568 Kaltenkirchen · Germany

☎ +49-4191-508-0 · 📠 +49-4191-508-209

contact@wiska.de · www.wiska.com

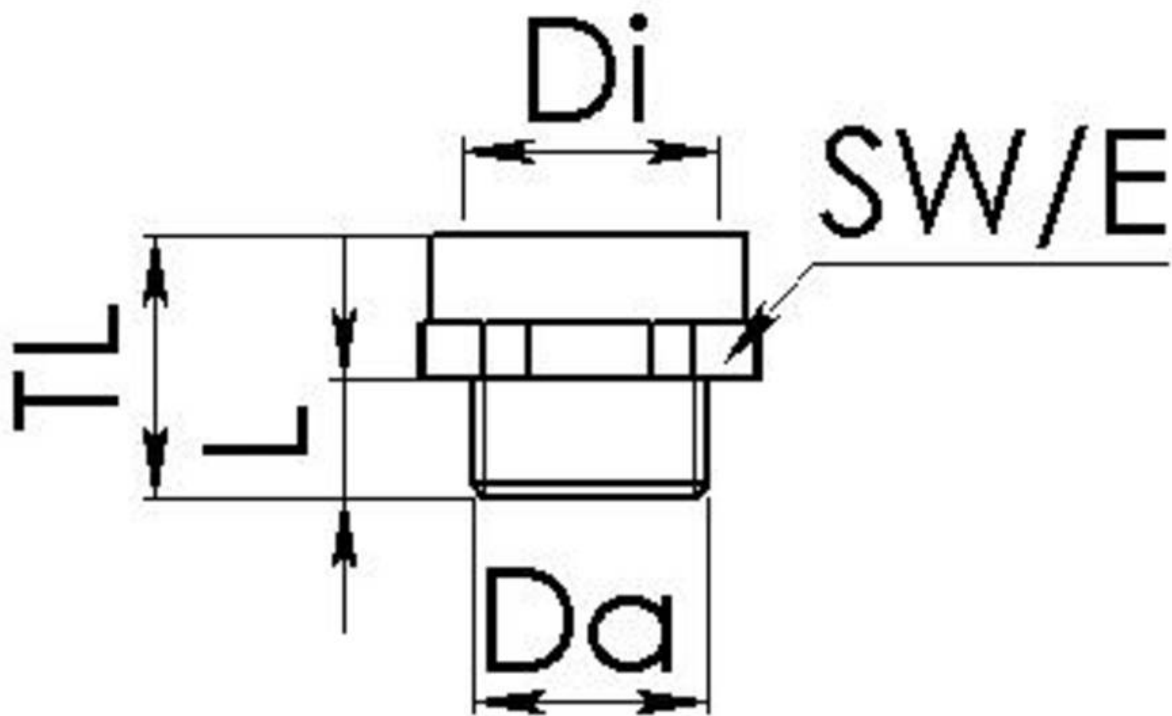

Your Contact:

WISKA Hoppmann GmbH

Kisdorfer Weg 28 · 24568 Kaltenkirchen · Germany

☎ +49-4191-508-0 · 📠 +49-4191-508-209

contact@wiska.de · www.wiska.com