

KEP 21/29

Enlargement adaptor, polyamide, RAL 7035, Pg21 / Pg29

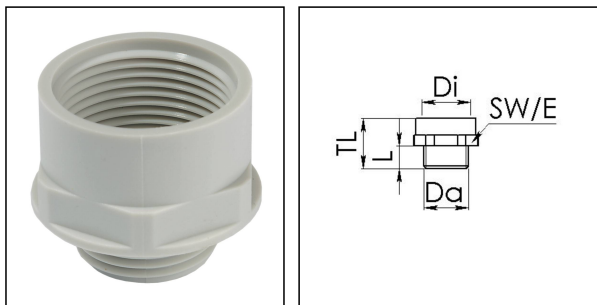

Products may differ in size, colour and appearance to those shown. If you require further information or customisation, please contact us directly.



Material	Polyamide, fibre reinforced
Temp. range min	-40 °C
Temp. range max	100 °C
Glow wire test	650 °C
Thread type outer	PG
Ø outer thread	21
Length screw-in thread L	12 mm
Thread type inner	PG
Ø inner thread	29
Length internal thread	15,5 mm
Total length TL	30 mm
Key width SW	42 mm
Collar diameter (E)	46 mm
Product Color	RAL 7035
Order no. RAL 7035	10063600
Type	KEP 21/29
Packing unit	25
ETIM-Classification	EC000938

Recommended accessories

MUG 21	10060675
ADR 21	10061424

08.02.2021

Your Contact:

WISKA Hoppmann GmbH

Kisdorfer Weg 28 · 24568 Kaltenkirchen · Germany

☎ +49-4191-508-0 · 📠 +49-4191-508-209

contact@wiska.de · www.wiska.com

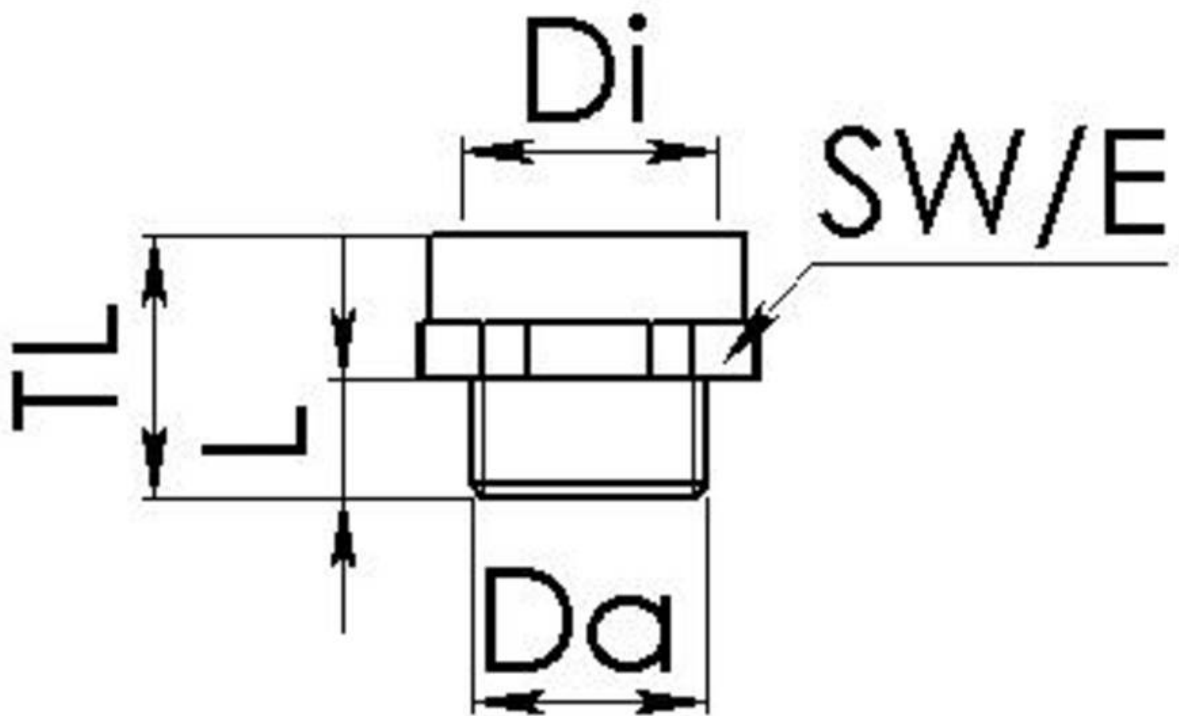

Your Contact:

WISKA Hoppmann GmbH

Kisdorfer Weg 28 · 24568 Kaltenkirchen · Germany

☎ +49-4191-508-0 · 📠 +49-4191-508-209

contact@wiska.de · www.wiska.com