

# Data Sheet

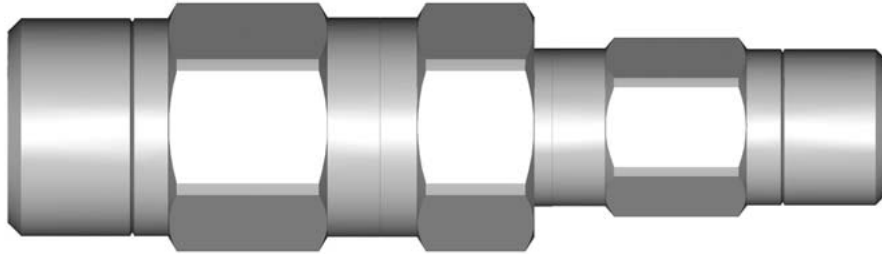

<b>No.</b>	<b>61321800</b>	
<b>Connector Type:</b>	<b>TELESTE: KDR404</b>	<b>M103-B107-SPR</b>

<b>Band Width:</b>	5 MHz – 2.2GHz
<b>Impedance:</b>	75 Ohm
<b>Amp. Rating:</b>	15 A
<b>Shielding:</b>	>110db @ 900 MHz

Temperature	
<b>Installing:</b>	-5 to +50 °C
<b>Operating:</b>	-30 to +85 °C
<b>Sealing Test:</b>	DS / IEC 529: IP X7

Return Loss: @ MHz, Better Than	
<b>500:</b>	30 dB
<b>860:</b>	28 dB
<b>1000:</b>	27 dB
<b>1750:</b>	26 dB

Insertion Loss: @ MHz, Better Than	
<b>500:</b>	-0,1 dB
<b>860:</b>	-0,1 dB
<b>1000:</b>	-0,1 dB
<b>1750:</b>	-0,1 dB

Pull Strength:	
<b>Total:</b>	50 kg
<b>Inner Conductor:</b>	X kg
<b>Jacket:</b>	X kg

<b>Dielectric Strength:</b>	3 kV
<b>Insulation Resistance:</b>	(@500V): > 30 Gohm
<b>Inner Conductor:</b>	Resistance max. @ 1A DC: 0.5 mOhm

Material and Plating		
<b>Body:</b>	Brass	NiSn (NiTin)
<b>Inner Cond.</b>	Brass	NiSn (NiTin)
<b>O'rings</b>	EPDM	
<b>Insulators</b>	Polycarbonat / Polyethylene	