

Data Sheet

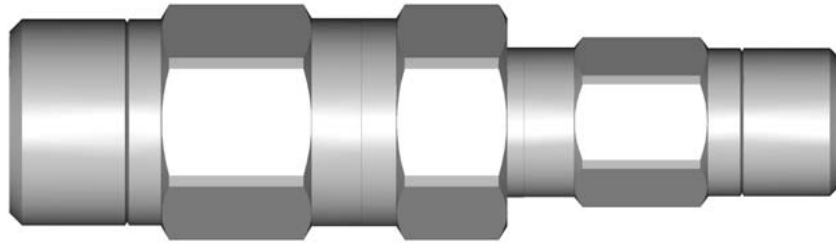

No.	61381810	
Connector Type:	TELESTE: KDR405	R007-G105-SPR

Band Width:	5 MHz – 2.2GHz
Impedance:	75 Ohm
Amp. Rating:	15 A
Shielding:	>100db @ 900 MHz

Temperature	
Installing:	-5 to +50 °C
Operating:	-30 to +85 °C
Sealing Test:	DS / IEC 529: IP X7

Return Loss: @ MHz, Better Than	
500:	30 dB
860:	27 dB
1000:	26 dB
1750:	26 dB

Insertion Loss: @ MHz, Better Than	
500:	-0,1 dB
860:	-0,1 dB
1000:	-0,1 dB
1750:	-0,1 dB

Pull Strength:	
Total:	50 kg
Inner Conductor:	X kg
Jacket:	X kg

Dielectric Strength:	3 kV
Insulation Resistance:	(@500V): > 30 Gohm
Inner Conductor:	Resistance max. @ 1A DC: 0.5 mOhm

Material and Plating		
Body:	Brass	NiSn (NiTin)
Inner Cond.	Brass	NiSn (NiTin)
O'rings	EPDM	
Insulators	Polycarbonat / Polyethylene	

Tested on: HP5753D / HP85047A