

M-LIGHT OY-Real LED

Installation Guide

M-Light



Only Indoor Use / Vain Sisäkäyttöön

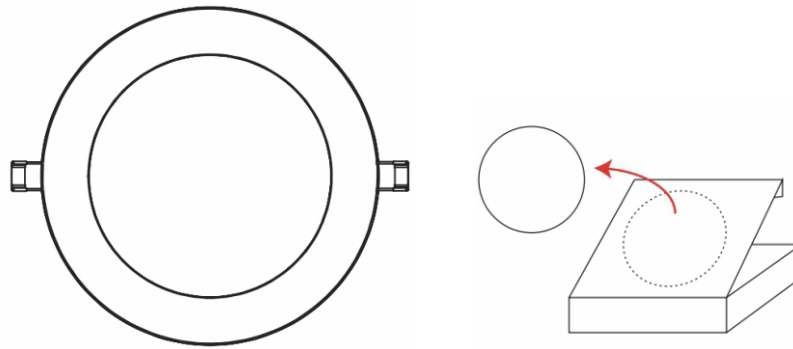

Model No.	Product Dimension	Cutting Holes Dimension
ML-Real LED 09	Ø150×20mm	Ø135mm
ML-Real LED 12	Ø180×20mm	Ø160mm
ML-Real LED 15	Ø192×20mm	Ø178mm
ML-Real LED 18	Ø240×20mm	Ø220mm
ML-Real LED 24	Ø300×20mm	Ø280mm
ML-Real LED 10-A	Ø200×20mm	Ø182mm
ML-Real LED 15-A	Ø240×20mm	Ø220mm

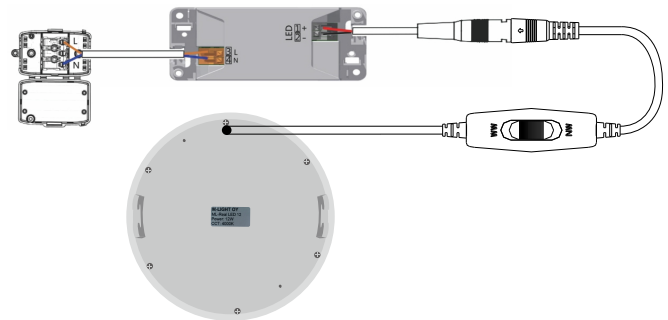
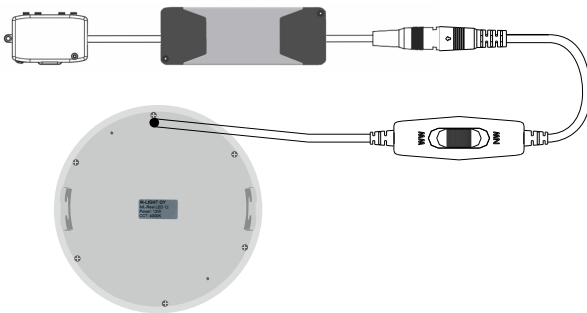

Model No.	Power	Product Dimension
PHILIPS Drive-A	9-12W	L:88*W39*H22mm
PHILIPS Drive-B	15-18W	L:101*W41*H28mm

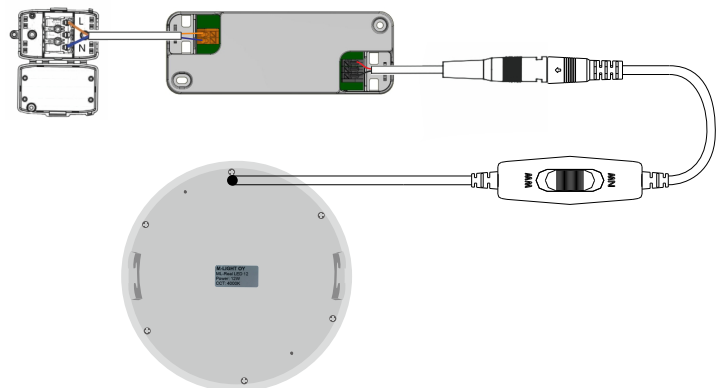
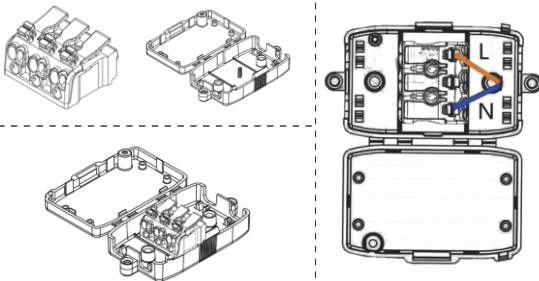

NO: Skru av strømmen før montering.
EN: Turn off power before installing.
FR: Couper le courant avant l'installation.
NL: Stroom uitschakelen voor u het toestel installeert.
DE: Vor Installationsarbeiten den Strom abschalten.
FI: Sammuta virta ennen kytkemistä



NO: Kan kun installeres av en registrert installasjonsvirksomhet.
EN: Only to be installed by an authorized electrician.
FR: Doit être installé par un électricien autorisé.
NL: Mag alleen geïnstalleerd worden door een bevoegde electricien.
DE: Dieses Produkt darf nur durch autorisiertes Personal (z. B. Elektro-Installateur) angeschlossen und in Betrieb genommen werden.
FI: Asentaa saa vain valtuutettu sähköasentaja

Model No.	Power	Product Dimension
PHILIPS Drive-C	24W	L:118*W43*H29mm

Only Indoor Use / Vain Sisakayttoon

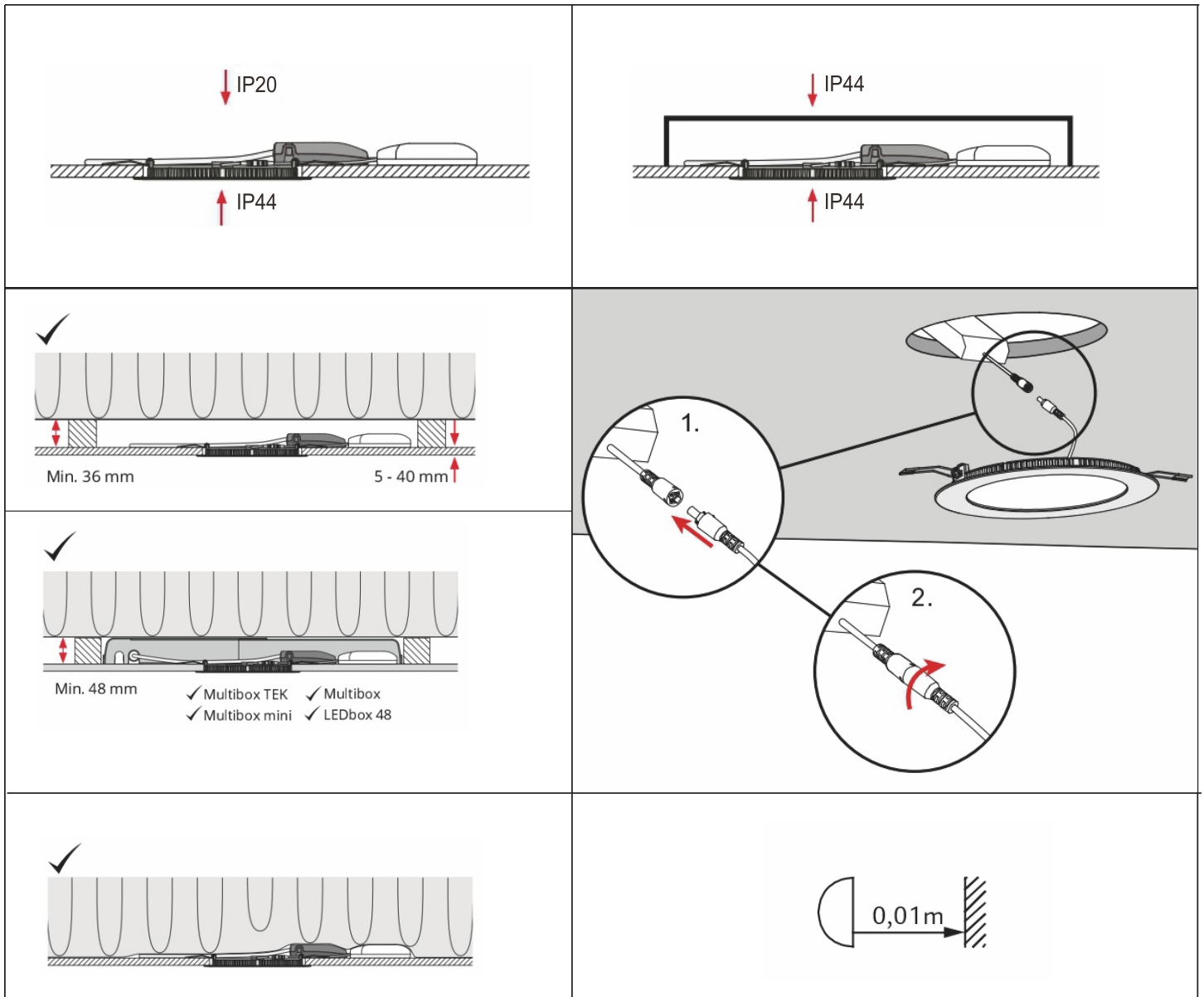

How many fittings can be installed behind a 10A circuit breaker?

Circuit Breaker Spec.	Fitting Model	Quantity
10A	ML-Real LED 09	170pcs
10A	ML-Real LED 12	125pcs
10A	ML-Real LED 15	100pcs
10A	ML-Real LED 18	85pcs
10A	ML-Real LED 24	64pcs
10A	ML-Real LED 10-A	150pcs
10A	ML-Real LED 15-A	100pcs

Remarks: If the specification is greater or less than 10A, it should be adjusted according to the proportion. For example, behind a 15A circuit breaker, then 255pcs of ML-Real LED 09 can be installed.