

# INSTRUCTION

For connection between

Tower and Solis S6-EH1P11.4K-H-US

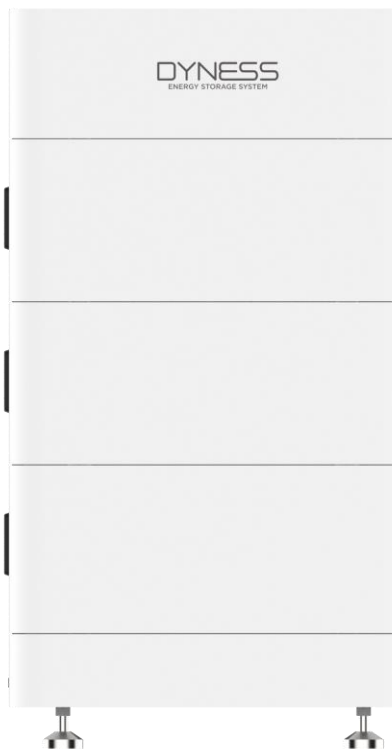

## Note

This is an instruction for connection and commissioning between Tower battery and S6-EH1P11.4K-H-US. For details of the connection and commissioning, please go to user manual of the battery and the S6-EH1P11.4K-H-US if you cannot find it in this instruction.

This instruction is applicable to upgraded Tower series and normal Tower series.

The upgraded Tower series have new characteristic as under:

1. The mark BDU-2G is on the packaging carton
2. RS232 port is added on the BDU interface and mark CAN/RS485 has replaced previous mark CAN
3. The color of nameplate has been changed from white to light yellow:

DYNESS ENERGY STORAGE SYSTEM					
	T7	T10	T14	T17	T21
Nominal Energy/kWh	7.1	10.7	14.2	17.8	21.3
Nominal Voltage/V	192	288	384	480	576
Nominal Capacity/Ah	37	37	37	37	37
Ambient Temp/°C	0-50	0-50	0-50	0-50	0-50
IP Grade	54	54	54	54	54
Protective Class	I	I	I	I	I

DYNESS ENERGY STORAGE SYSTEM					
	T7	T10	T14	T17	T21
Nominal Energy/kWh	7.1	10.7	14.2	17.8	21.3
Nominal Voltage/V	192	288	384	480	576
Nominal Capacity/Ah	37	37	37	37	37
Ambient Temp/°C	0-50	0-50	0-50	0-50	0-50
IP Grade	54	54	54	54	54
Protective Class	I	I	I	I	I

## Applicable Product type

- Dy ness Battery Module Type:  
Tower T7 ESS unit/Tower T10 ESS unit/Tower T14 ESS unit
- Solis Inverter Type:  
S6-EH1P3.8/5/7.6/10/11.4K-H-US

## Installation Steps

- 1 Install Tower as per User manual. Take T10 as an example.

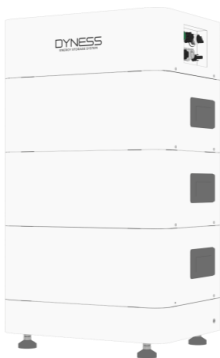

- 2 Refer to User manual to connect Grid ,energy meter, loads etc. to S6-EH1P11.4K-H-US

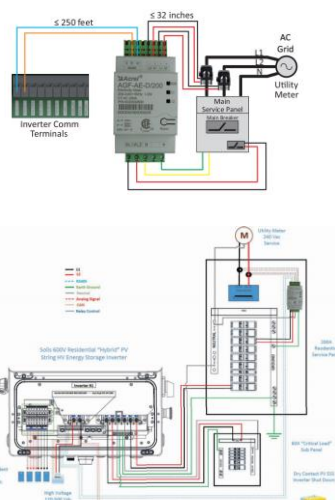

- 3 Connect the battery power cable to the inverter battery interface.

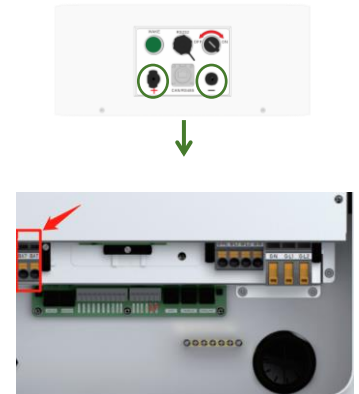

4 Connect the battery communication cable to the inverter.



BATTERY-Dyness

INVERTER-solis

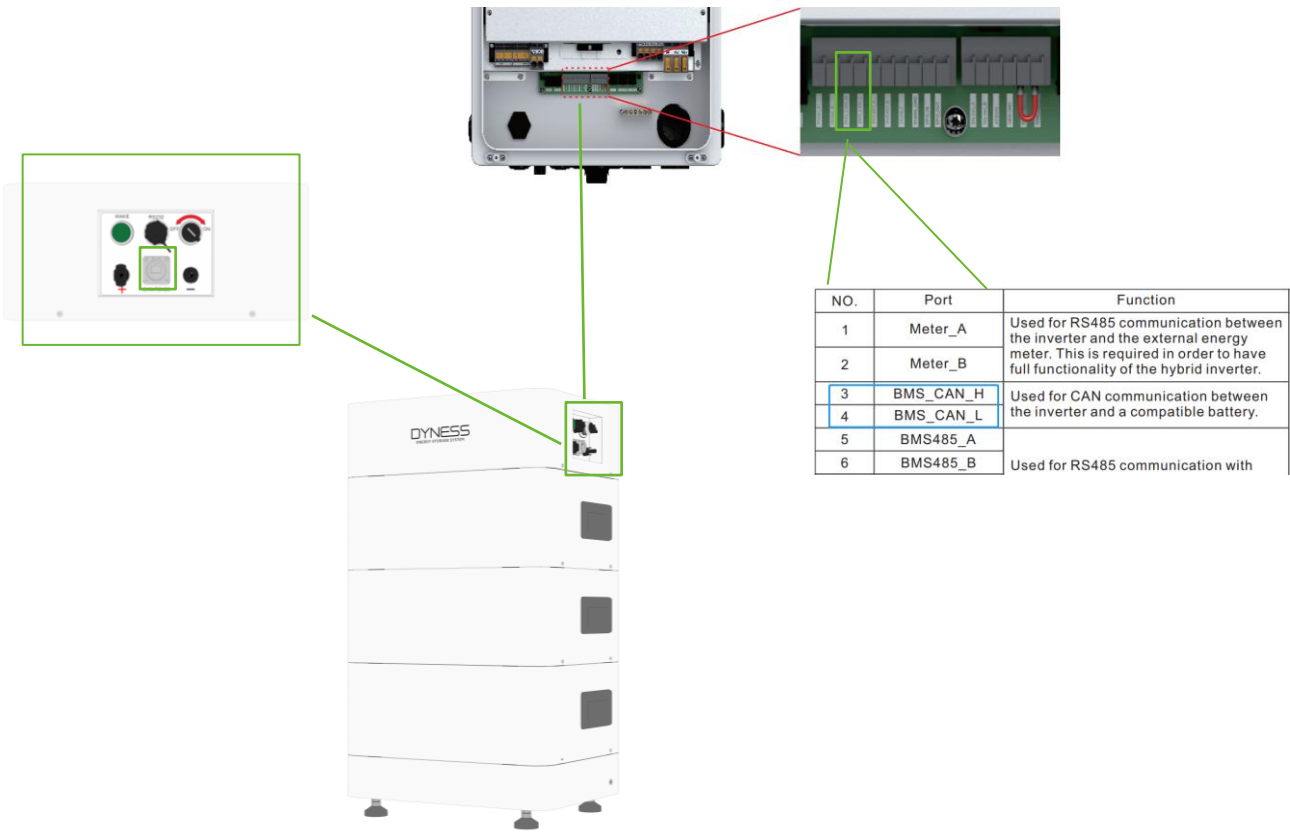

It is recommended to install a circuit breaker between Tower and Solis

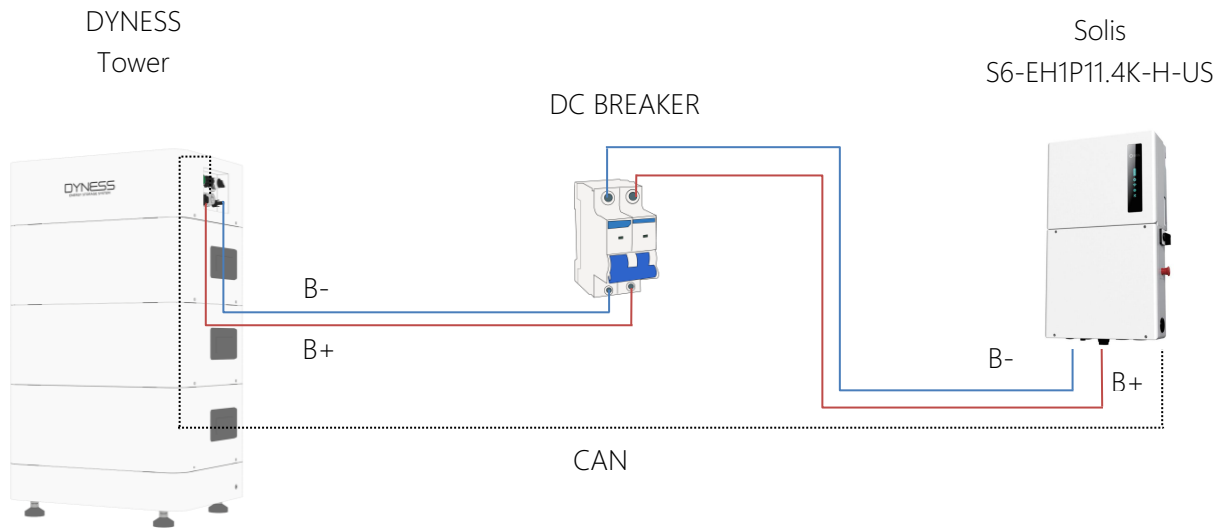

Tower and Solis connection diagram

**5** Turn on battery and inverter

Turn on the inverter: turn on circuit breaker of mains power to turn on Solis. Turn on the DC switch to “I” position

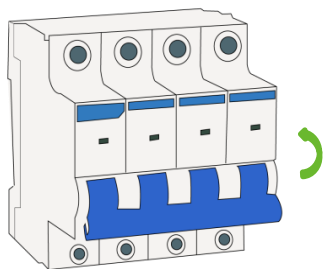

Turn on battery: Turn on the circuit breaker on BDU of tower; turn on circuit breaker between Tower and Solis; turn on the power on switch and press and hold on the “WAKE” button for 10s

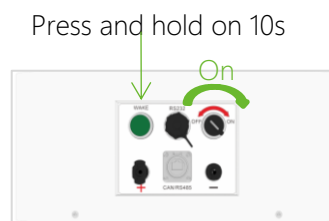
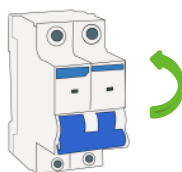
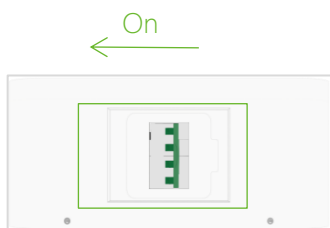

**6** After the inverter is turned on, log in to the "SolisCloud" app to configure the inverter's network. The detailed operation is as follows: (password:123456789)

The screenshots illustrate the following steps:

- Home screen: The SolisCloud app icon is highlighted with a red box.
- Register screen: The 'Log In' button is highlighted with a red box.
- Register screen: The 'WiFi Configuration' button is highlighted with a red box.
- Input datalogger SN screen: The 'Next(1/3)' button is highlighted with a red box.
- Input datalogger SN screen: The 'Next(1/3)' button is highlighted with a red box.
- Configuration Tip screen: The 'I'm sure it is flashing' button is highlighted with a red box.
- Connect the network to... screen: The 'Go to connect' button is highlighted with a red box.
- WLAN settings screen: The network 'Solis\_5A12320928000E1F' is highlighted with a red box.

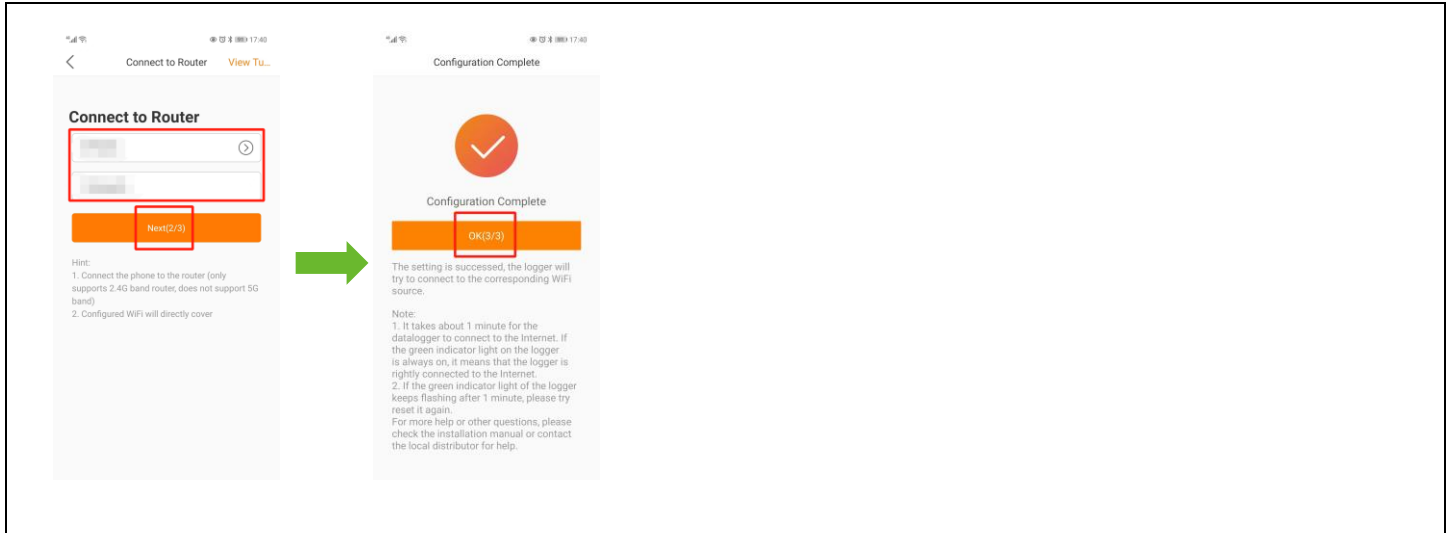

7 After the network configuration is completed, the app will perform proximal debugging to set the inverter time, battery model, meter type, and power grid standard. The detailed operations are as follows:

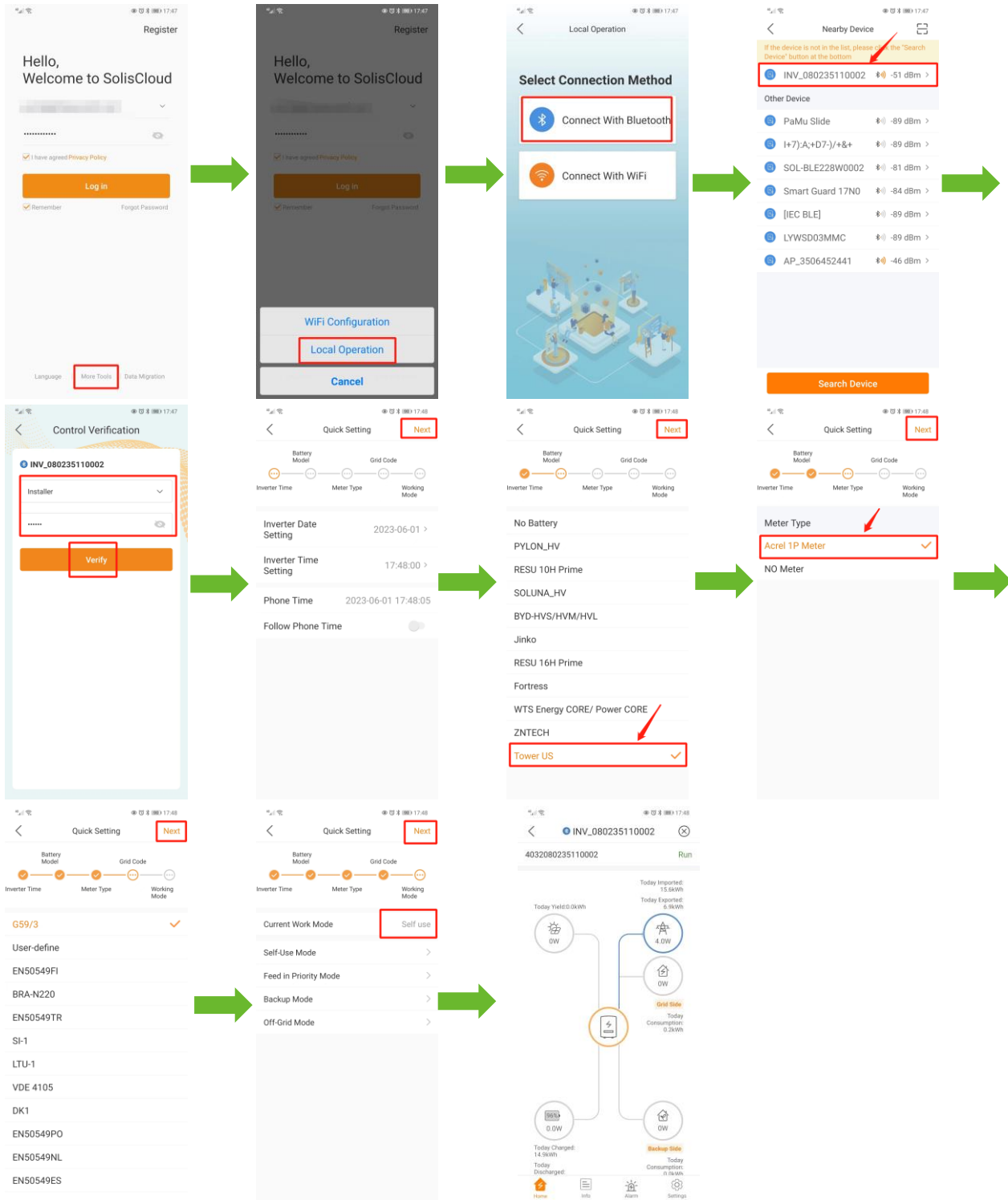

8 After the communication between the battery and the inverter is normal, query the power grid data. The detailed operation is as follows:

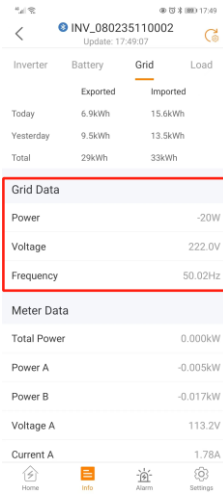

9 In the app settings interface, select the "Self-Use Mode" and set the charging and discharging times separately. The detailed operations are as follows:  
Charging settings:

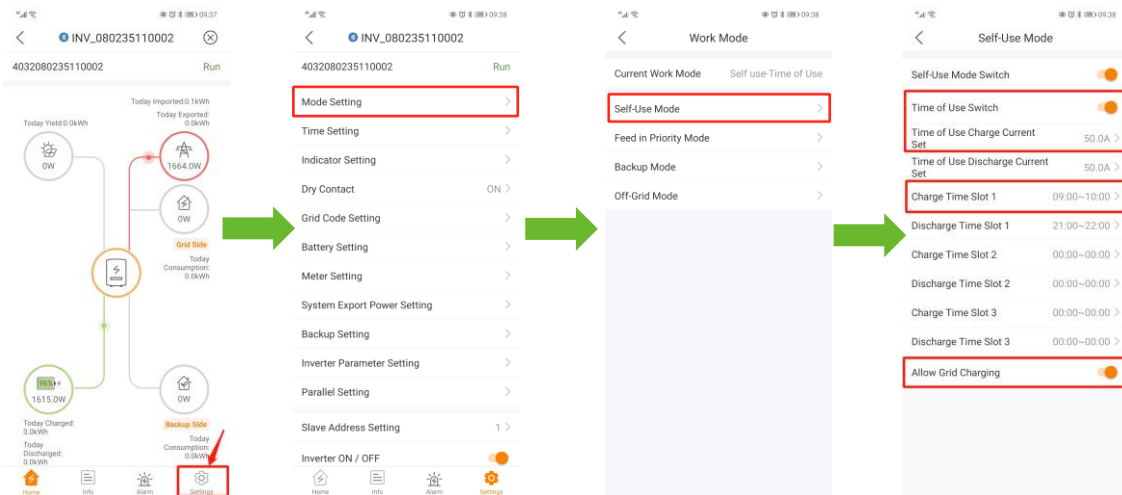

Discharge settings:

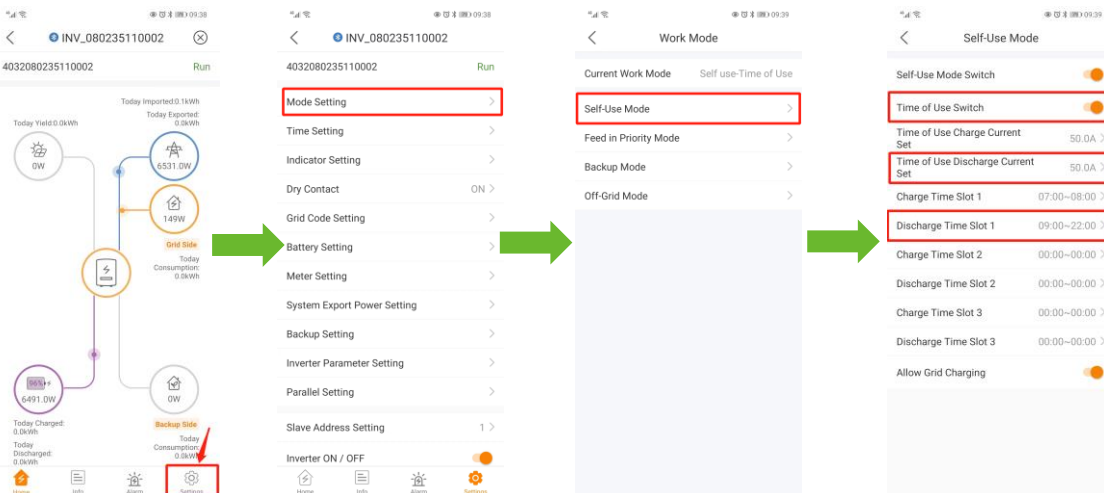

10 Off-Grid Mode Settings:

- ① The inverter automatically enters off grid mode when disconnected from the power grid, and can discharge when connected to the load.
- ② Set offline mode in app:

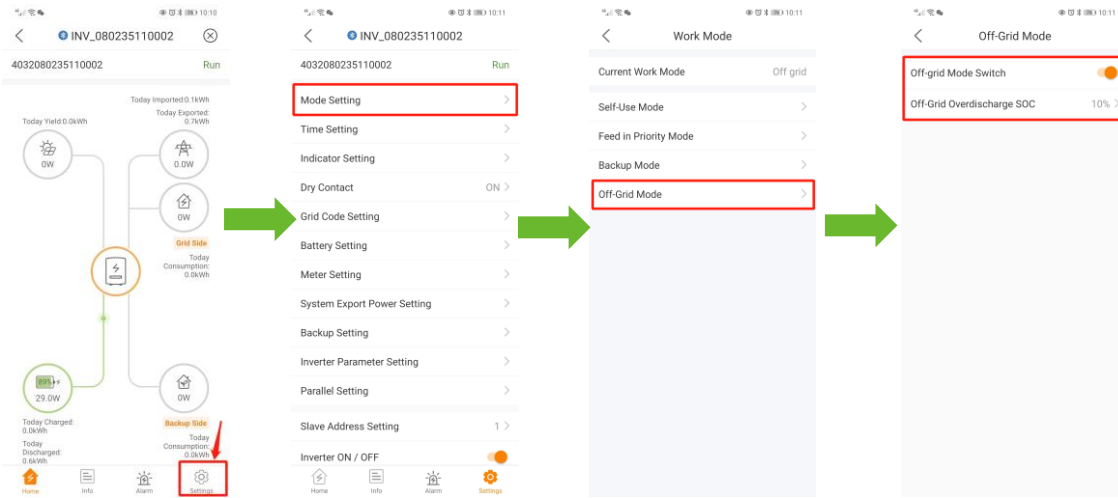



Discover Your Nature



Official Website



Digital version access

Dyness Digital Energy Technology Co., LTD.

[www.dyness-tech.com](http://www.dyness-tech.com)