

INSTRUCTION

for connection between

Tower and KOSTAL PLENTICORE plus/BI



Note

This is an instruction for connection and commissioning between Tower battery and KOSTAL PLENTICORE plus/BI. For details of the connection and commissioning, please go to user manual of the battery and the KOSTAL PLENTICORE plus/BI if you cannot find it in this instruction.

This instruction is only applicable to upgraded Tower series (except Tower T21), the upgraded Tower series have new characteristic as under:

1. The mark BDU-2G is on the packaging carton
2. RS232 port is added on the BDU interface and mark CAN/RS485 has replaced previous mark CAN
3. The color of nameplate has been changed from white to light yellow:

DYNESS ENERGY STORAGE SYSTEM		DYNESS ENERGY STORAGE SYSTEM									
	T7	T10	T14	T17	T21		T7	T10	T14	T17	T21
Nominal Energy/kWh	7.1	10.7	14.2	17.8	21.3	Nominal Energy/kWh	7.1	10.7	14.2	17.8	21.3
Nominal Voltage/V	192	288	384	480	576	Nominal Voltage/V	192	288	384	480	576
Nominal Capacity/Ah	37	37	37	37	37	Nominal Capacity/Ah	37	37	37	37	37
Ambient Temp/°C	0-50	0-50	0-50	0-50	0-50	Ambient Temp/°C	0-50	0-50	0-50	0-50	0-50
IP Grade	54	54	54	54	54	IP Grade	54	54	54	54	54
Protective Class	I	I	I	I	I	Protective Class	I	I	I	I	I

Applicable Product type

- Dy Ness Battery Module Type:
Tower T7 ESS unit/Tower T10 ESS unit/Tower T14 ESS unit/Tower T17 ESS unit
- Kostal Inverter Type:
PLENTICORE plus 3.0/ PLENTICORE plus 4.2/ PLENTICORE plus 5.5/ PLENTICORE plus 7.0/ PLENTICORE plus 8.5/ PLENTICORE plus 10
PLENTICORE BI 5.5/26 and PLENTICORE BI 10/26

Installation Steps

- 1 Install tower as per user manual. Take T10 as an example

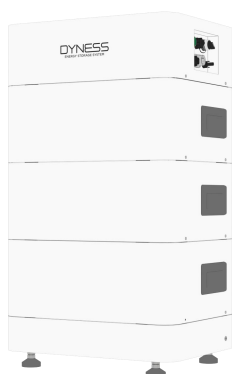

- 2 refer to user manual to connect energy meter, grid, loads, etc. to PLENTICORE plus/BI inverter



- 3 Connect the battery power cables to inverter. Plug the socket and plug of the battery's DC power cables onto the DC input 3 on the inverter

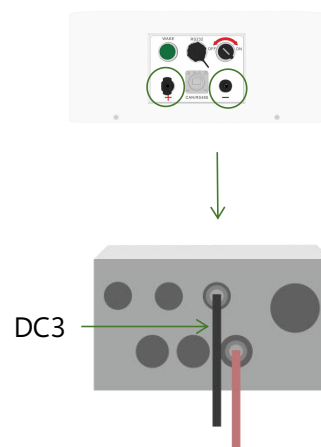

- 4 Connect the battery communication cable to inverter (RJ45 plug at battery end, expose wires at the inverter end, keep the wire in orange and the wire in white & orange, remove other wires)

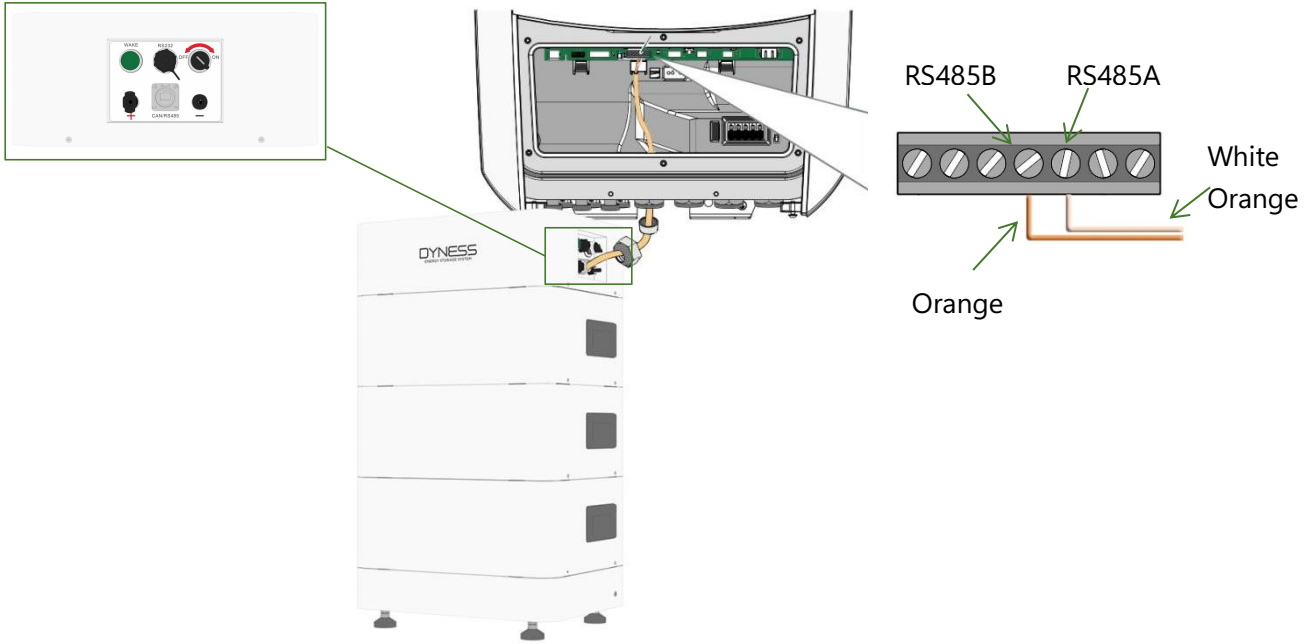

It is recommended to install a circuit breaker between Tower and Kostal

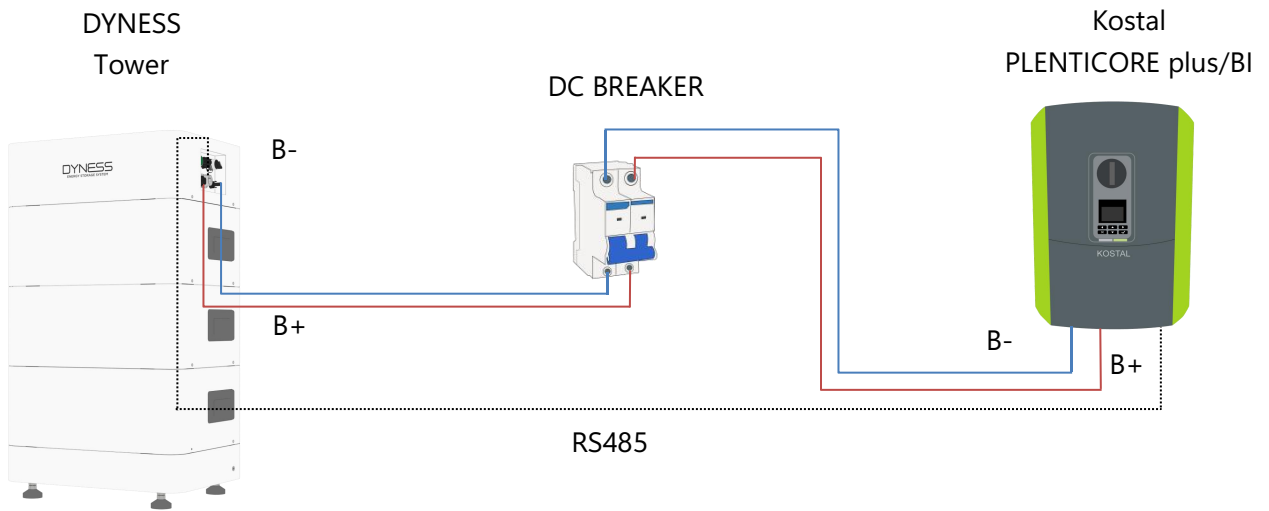

Tower and Kostal connection diagram

5 Turn on battery and inverter

Turn on inverter: turn on circuit breaker of mains power to turn on Kostal. Turn on the DC switch to "I" position

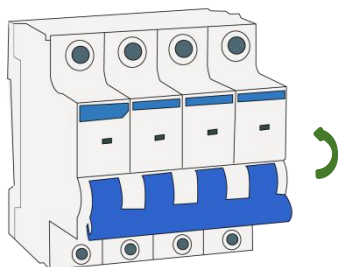

Turn on battery: Turn on the circuit breaker on BDU of tower, turn on the power on switch and press and hold on the "wake" button for 10s

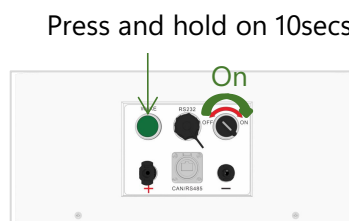
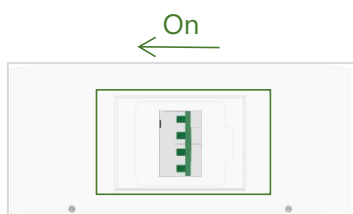

6 Initial commissioning of inverter: follow the installation wizard on the display and make settings.

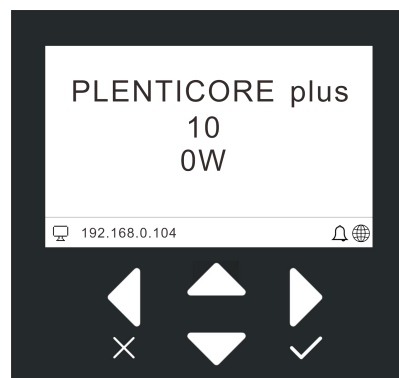
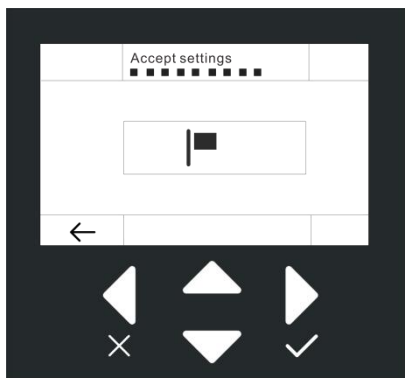
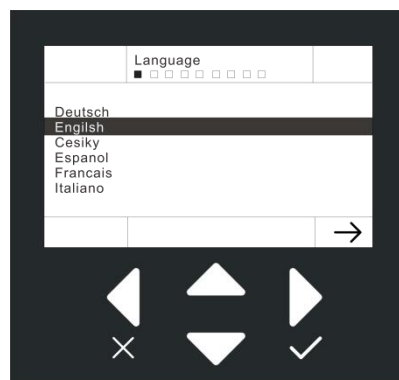
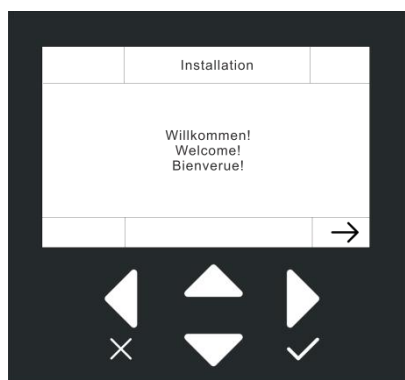

Initial commissioning is completed.

7 Enter the IP of the inverter into the URL line of your browser, log in

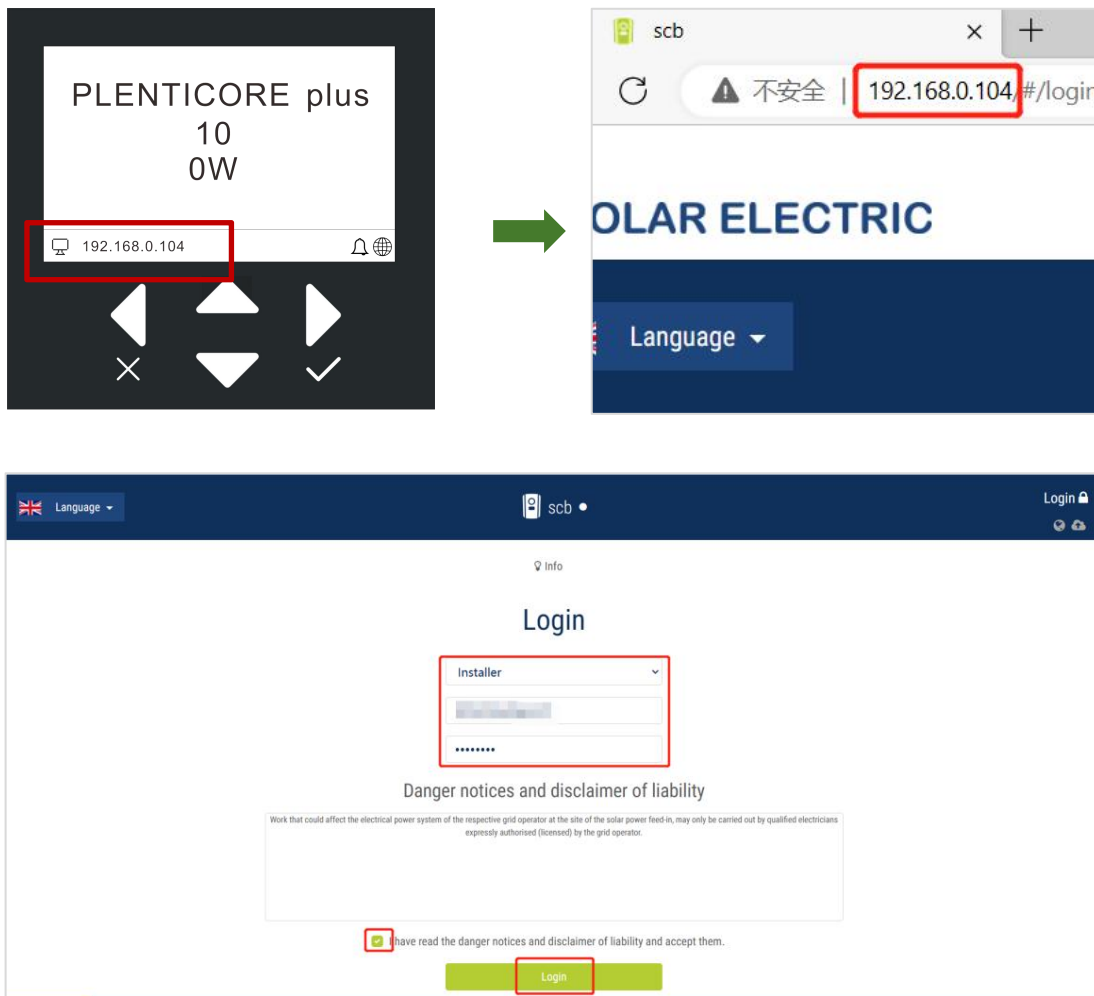

8 A battery activation code is required to release the DC3 of inverter for connecting the battery. Purchase a "Battery activation code" from KOSTAL Solar online shop and enter this in the inverter via webserver: Service menu > Extra options > Release new options > Enter code

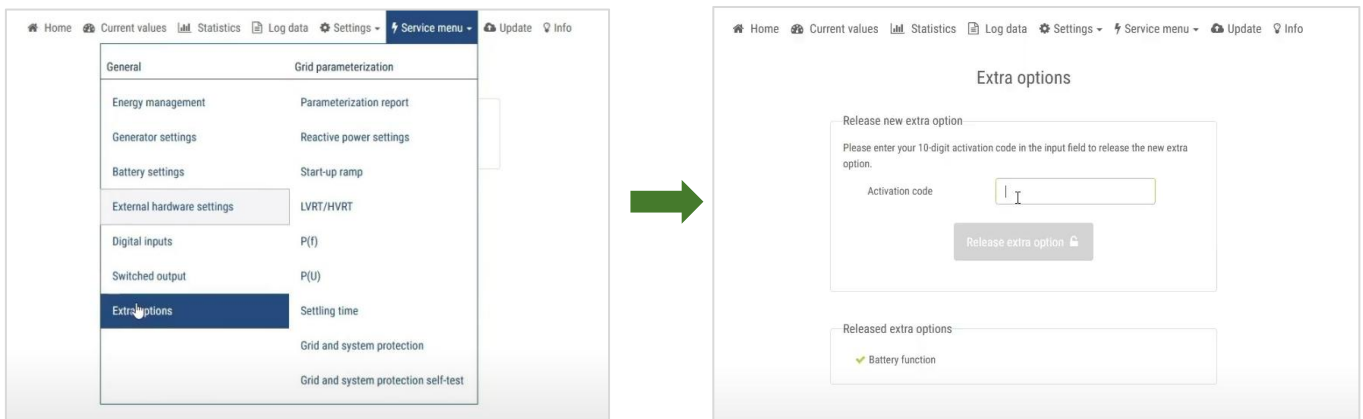

or in the inverter menu: Settings> Extra options> Additional options>Release options>Activate options > Enter code.

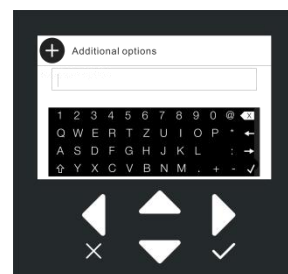
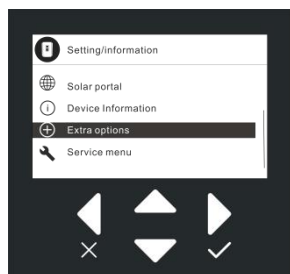
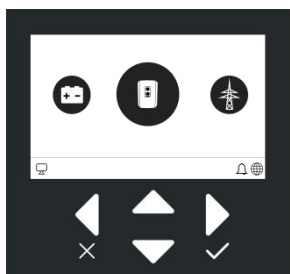

9 select battery type and parameters in service menu, save the settings

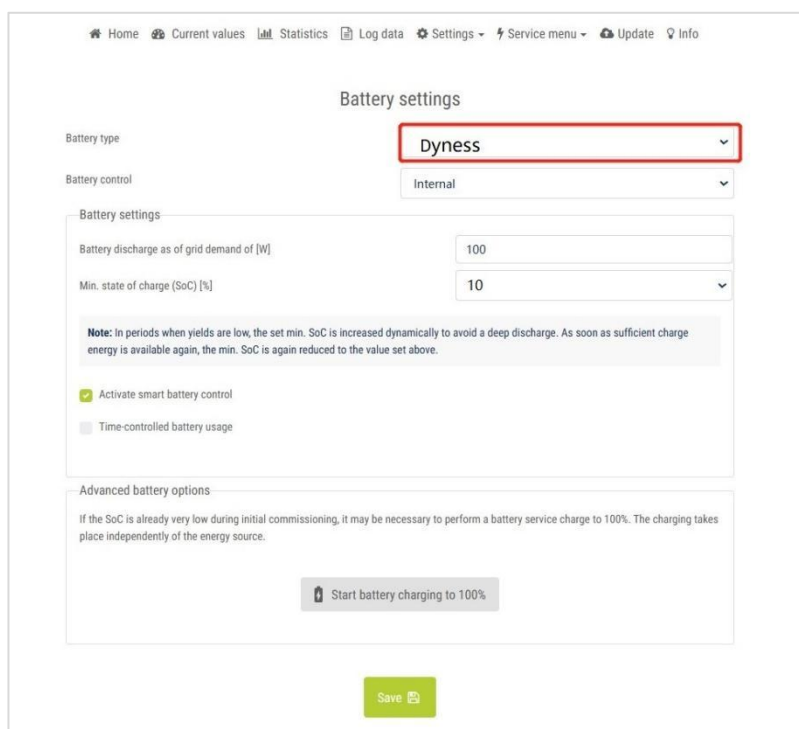
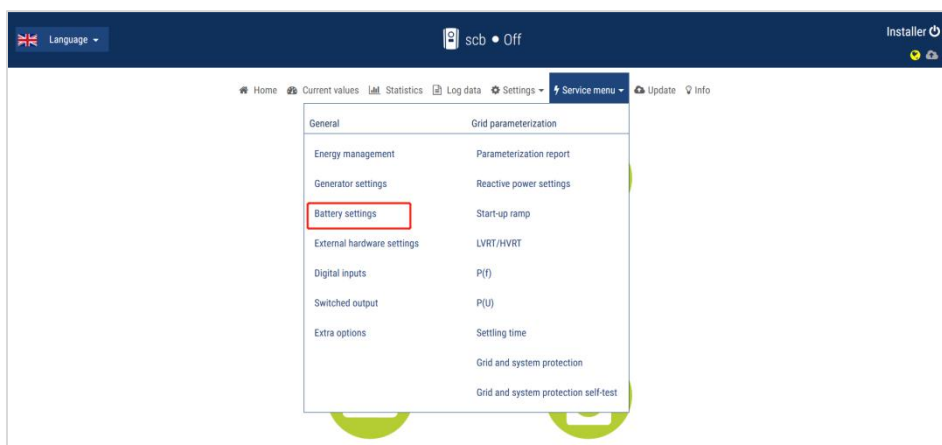

- 10 check the battery information on LCD display. If the battery status is normal, then the commission is successful

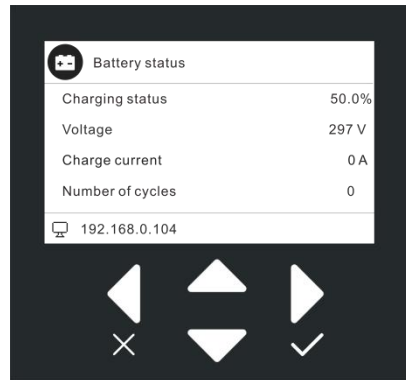



Discover Your Nature



Official Website



Digital version access

DYNESS RENEWABLE ENERGY GROUP CO., LTD.

www.dyness-tech.com