

BDEP-12,42-bbb-ccc
CM...

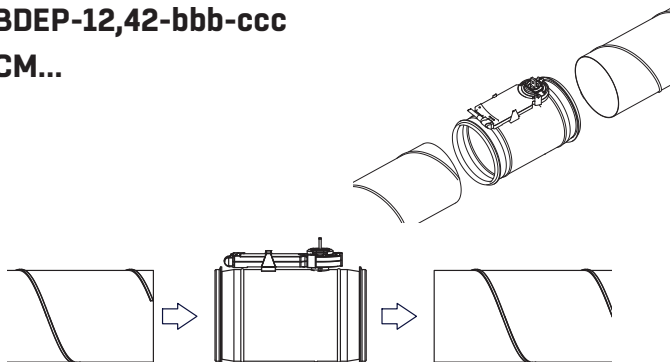

BDEP-13,19,43,49-bbb-ccc
LM...
SM...

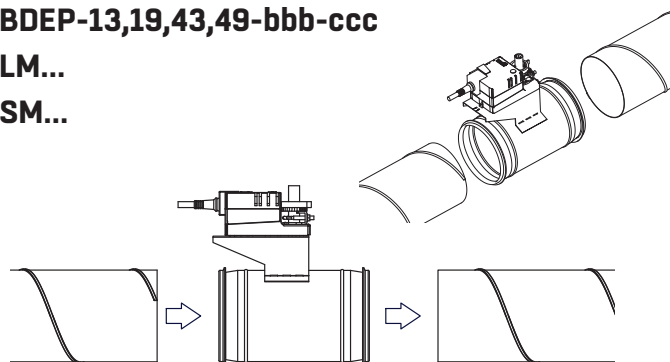

Direction of motion motor

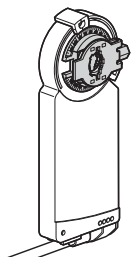

CM...-R (CW)
?
CM...-L (CCW)

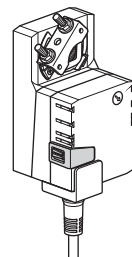

Manual override

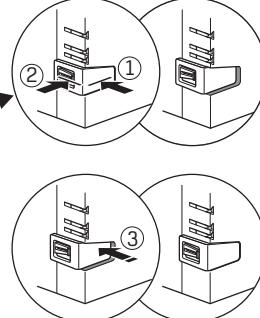
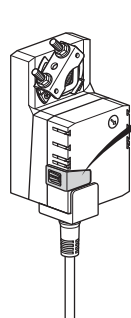
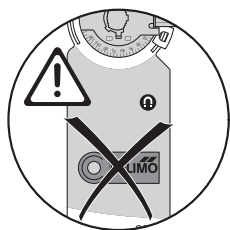
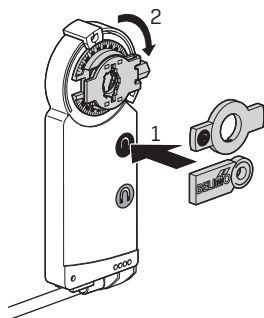

Damper position changing

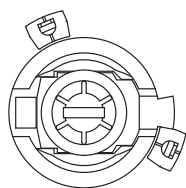
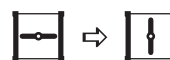

CM...-L

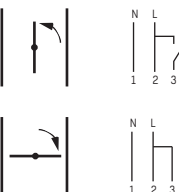

CM...-R

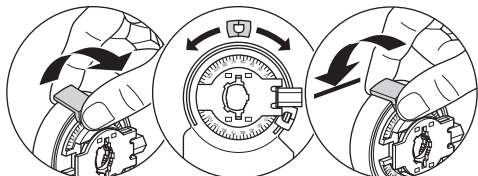
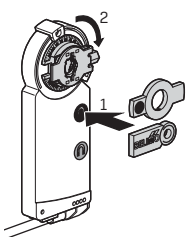
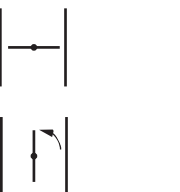

CM...-L

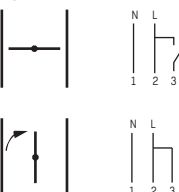

CM...-R

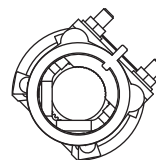
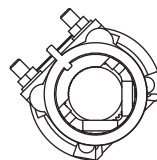
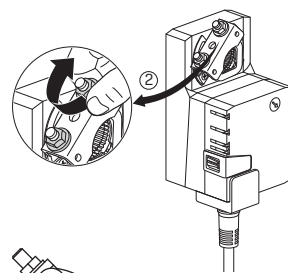
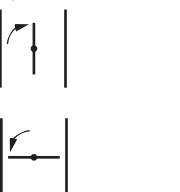

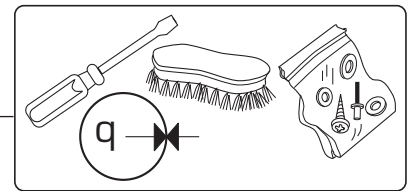

BDEP-18,48-bbb-ccc

LF...

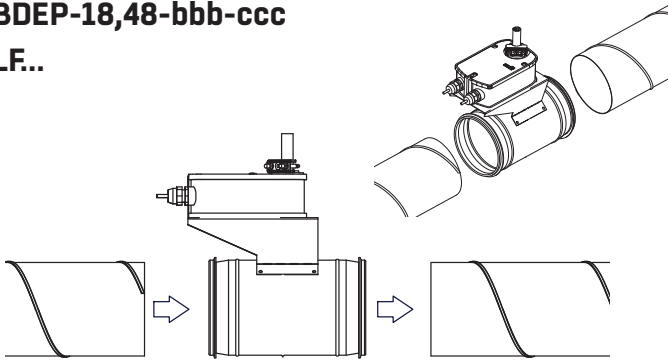

BDEP-46-bbb-ccc

SF...

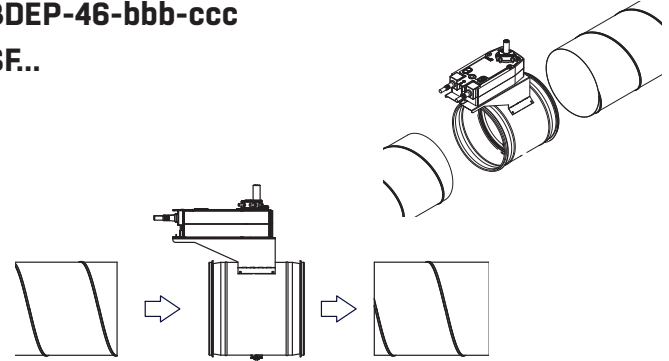

BDEP-18,48-bbb-ccc

LF...

Damper position changing
Manual override: **NO**

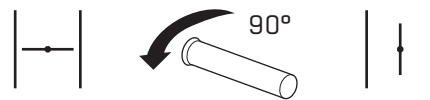
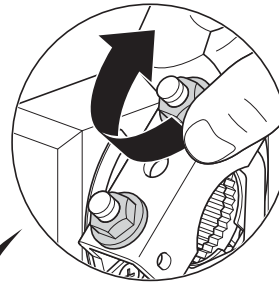
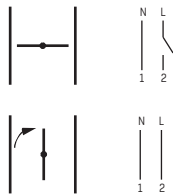
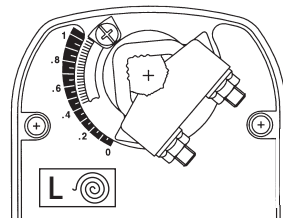
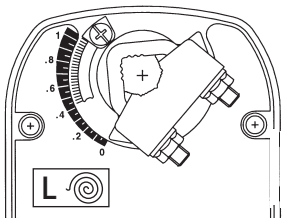

BDEP-46-bbb-ccc

SF...

Damper position changing

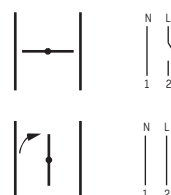
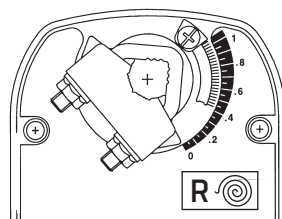
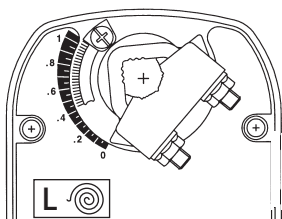
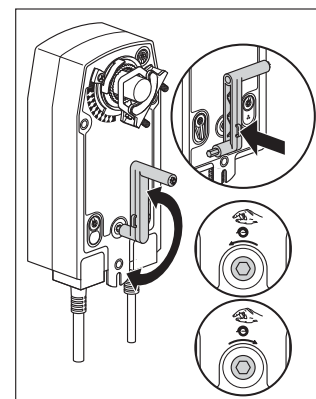
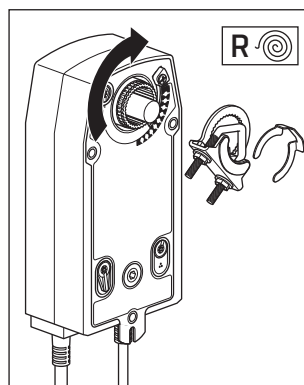
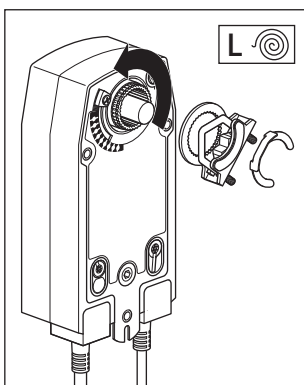

Manual override: by means of hand crank and locking switch

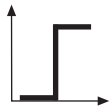
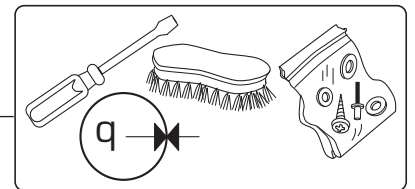

CM...-R
CM...-L

BDEP-12,42-bbb-ccc

AC/DC 24 V, open-close

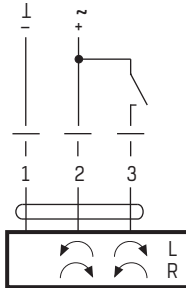

Cable colours:
1 = black
2 = red
3 = white

AC/DC 24 V, 3-point

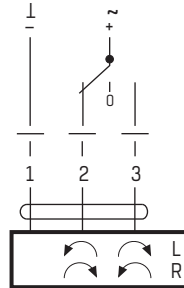

Cable colours:
1 = black
2 = red
3 = white

AC/DC 230 V, open-close

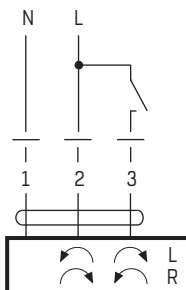

Cable colours:
1 = blue
2 = brown
3 = white

AC/DC 230 V, 3-point

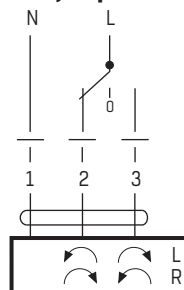

Cable colours:
1 = blue
2 = brown
3 = white



LM...A
SM...A

BDEP-13,19,43,49-bbb-ccc

AC/DC 24 V, open-close

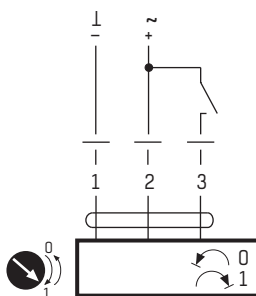

Cable colours:
1 = black
2 = red
3 = white

AC/DC 24 V, 3-point

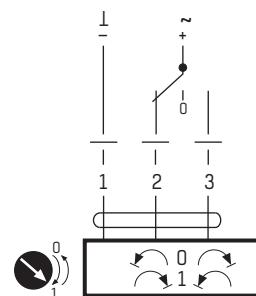

Cable colours:
1 = black
2 = red
3 = white

AC/DC 230 V, open-close

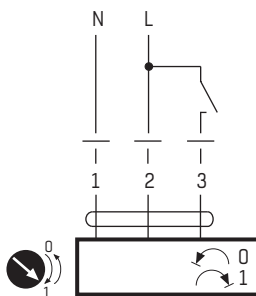

Cable colours:
1 = blue
2 = brown
3 = white

AC/DC 230 V, 3-point

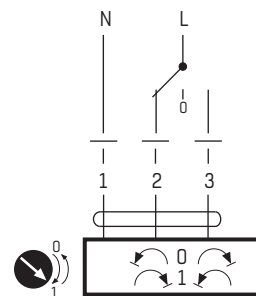

Cable colours:
1 = blue
2 = brown
3 = white

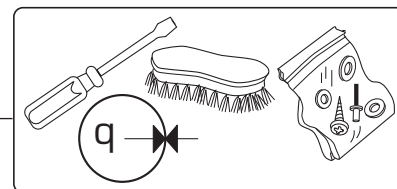

LM...A-S
SM...A-S

BDEP-13,19,43,49-bbb-ccc-S

AC/DC 24 V, open-close

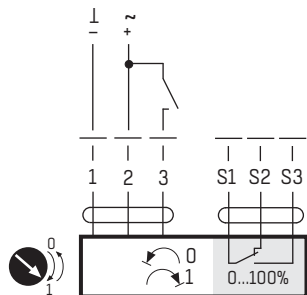

Cable colours:

- 1 = black
- 2 = red
- 3 = white
- S1 = violet
- S2 = red
- S3 = white

AC/DC 24 V, 3-point

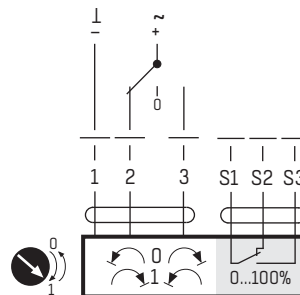

Cable colours:

- 1 = black
- 2 = red
- 3 = white
- S1 = violet
- S2 = red
- S3 = white

AC/DC 230 V, open-close

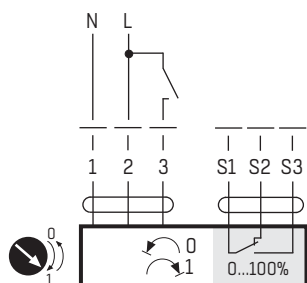

Cable colours:

- 1 = blue
- 2 = brown
- 3 = white
- S1 = violet
- S2 = red
- S3 = white

AC/DC 230 V, 3-point

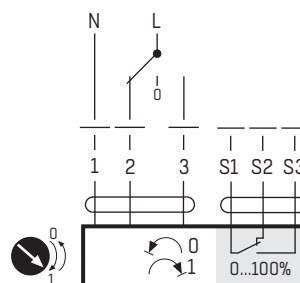

Cable colours:

- 1 = blue
- 2 = brown
- 3 = white
- S1 = violet
- S2 = red
- S3 = white



LM...A-SR
SM...A-SR

BDEP-13,19,43,49-bbb-ccc-SR

AC/DC 24 V, modulating

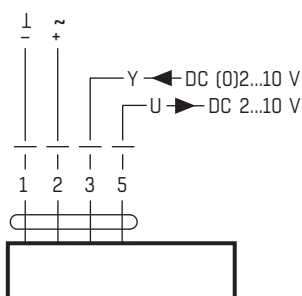

Cable colours:

- 1 = black
- 2 = red
- 3 = white
- 5 = orange

AC/DC 230 V, modulating

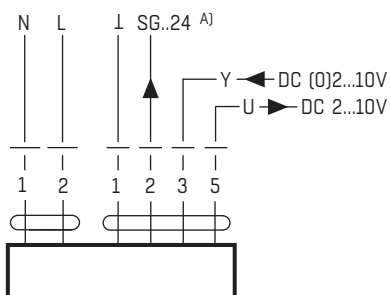

A) Auxiliary supply only for positioner SG..24

Cable colours:

- 1 = blue
- 2 = brown
- 1 = black
- 2 = red
- 3 = white
- 5 = orange

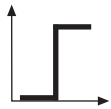
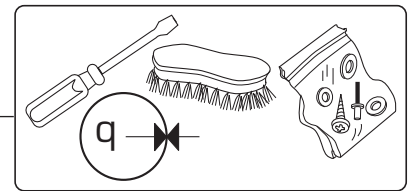

LF...
SF...A

BDEP-18,46,48-bbb-ccc

AC/DC 24 V, open-close

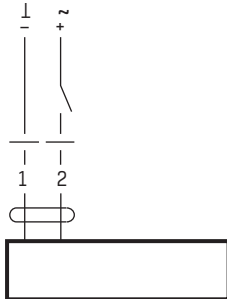

Cable colours:
1 = black
2 = red

AC/DC 230 V, open-close

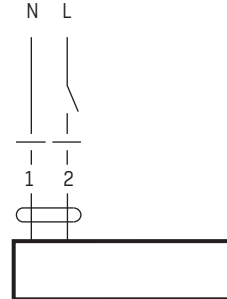

Cable colours:
1 = blue
2 = brown

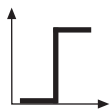

LF...S

BDEP-18,48-bbb-ccc-S

AC/DC 24 V, open-close

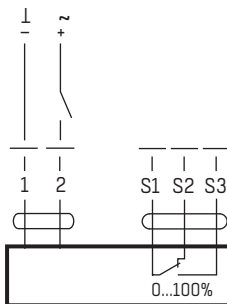

Cable colours:
1 = black
2 = red
S1 = white
S2 = white
S3 = white

AC/DC 230 V, open-close

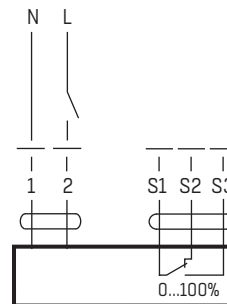

Cable colours:
1 = blue
2 = brown
S1 = white
S2 = white
S3 = white

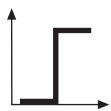

SF24A-S2

BDEP-46-bbb-024-S

AC/DC 24 V, open-close

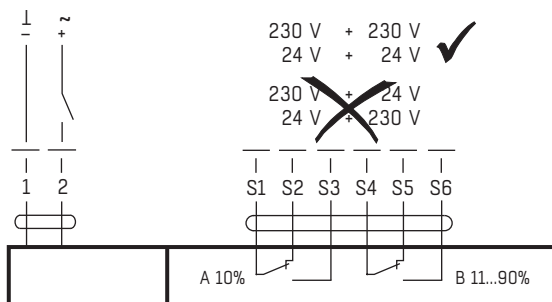

230 V + 230 V
24 V + 24 V ✓
~~230 V + 24 V~~
~~24 V + 230 V~~

Cable colours:
1 = black
2 = red
S1 = violet
S2 = red
S3 = white
S4 = orange
S5 = pink
S6 = grey

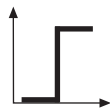
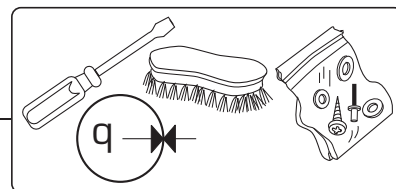

SFA-S2

BDEP-46-bbb-230-S

AC 24...240 V / DC 24...125 V, open-close

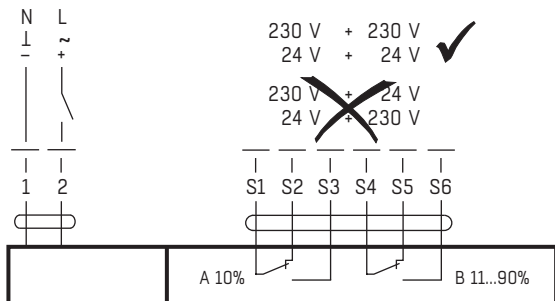

Cable colours:

- 1 = blue
- 2 = brown
- S1 = violet
- S2 = red
- S3 = white
- S4 = orange
- S5 = pink
- S6 = grey



LF24A-SR
SF24A-SR

BDEP-18,46,48-bbb-024-SR

AC/DC 24 V, modulating

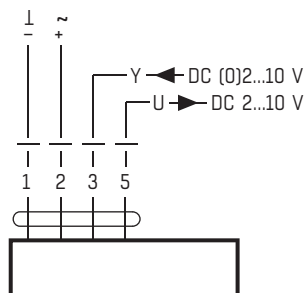

Cable colours:

- 1 = black
- 2 = red
- 3 = white
- 5 = orange

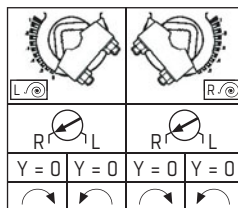

BDKP-3

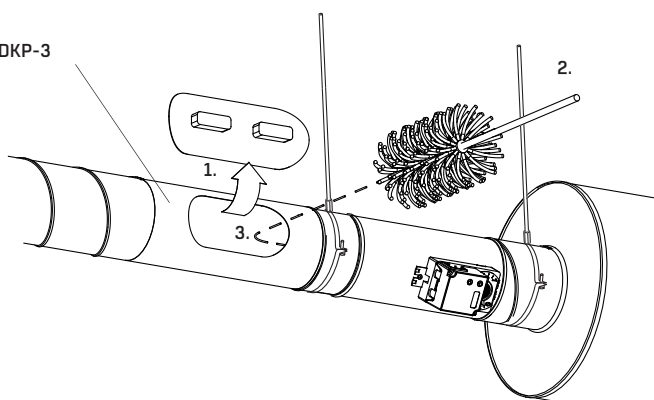

BDET-1-aaa-bbb

