

KEM 50/63

Enlargement adaptor, polyamide, RAL 7035, M50 / M63

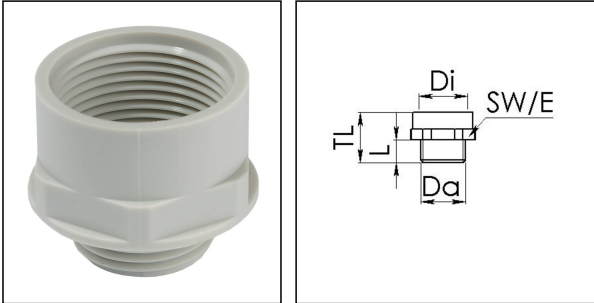

Products may differ in size, colour and appearance to those shown. If you require further information or customisation, please contact us directly.



Material	Polyamide, fibre reinforced
Temp. range min	-40 °C
Temp. range max	100 °C
Glow wire test	650 °C
Thread type outer	M
Ø outer thread	50
Lead outer	1,5
Length screw-in thread L	14 mm
Thread type inner	M
Ø inner thread	63
Lead inner	1,5
Length internal thread	15,5 mm
Total length TL	32 mm
Key width SW	68 mm
Collar diameter (E)	75 mm
Product Color	RAL 7035
Order no. RAL 7035	10063576
Type	KEM 50/63
Packing unit	5
ETIM-Classification	EC000938

Recommended accessories

EMUG 50	10060776
----------------	----------

Your Contact:

WISKA Hoppmann GmbH

Kisdorfer Weg 28 · 24568 Kaltenkirchen · Germany

☎ +49-4191-508-0 · 📠 +49-4191-508-209

contact@wiska.de · www.wiska.com

27.01.2021

Your Contact:

WISKA Hoppmann GmbH

Kisdorfer Weg 28 · 24568 Kaltenkirchen · Germany

☎ +49-4191-508-0 · 📠 +49-4191-508-209

contact@wiska.de · www.wiska.com

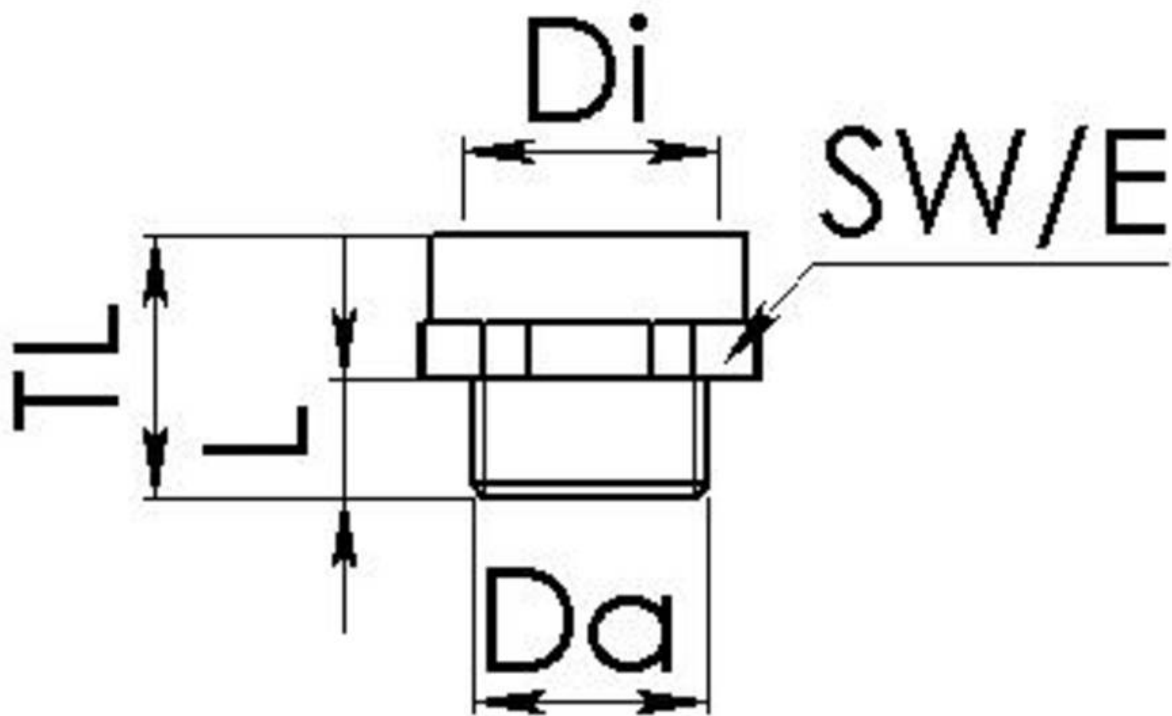

Your Contact:

WISKA Hoppmann GmbH

Kisdorfer Weg 28 · 24568 Kaltenkirchen · Germany

☎ +49-4191-508-0 · 📠 +49-4191-508-209

contact@wiska.de · www.wiska.com